

S 4 3 858856 2 1

DRAWING MADE IN AMERICAN PROJECTION

©1968 BY AMP INCORPORATED, ALL RIGHTS RESERVED. AMP PRODUCTS COVERED BY PATENTS AND/OR PATENTS PENDING.

THIS PRODUCT DESIGNED AND BUILT BY AMP INCORPORATED, ON LICENSE TO USE THAT DESIGN IN MANUFACTURE, OR TO USE ANY ISSUED OR PENDING PATENTS WHICH ARE INVOLVED, IS IMPLIED.

REVISIONS				
ZONE	LTR	DESCRIPTION	DATE	APPROVED
A		REVISED NOTE 1	LAJ 10-17-73	JPA
B		REVISED PER ECN 4-349	D.S. 5-21-74	M.G.
C		ADDED REF. TO .69, 1.19, 1.91, 1.2 & .89	KA 12-1-77	M.G.
D		REV PER ECN S-3960	9/20/87	R.S.
E		OBS-2 ECNDF 0376	2-89	T.W.

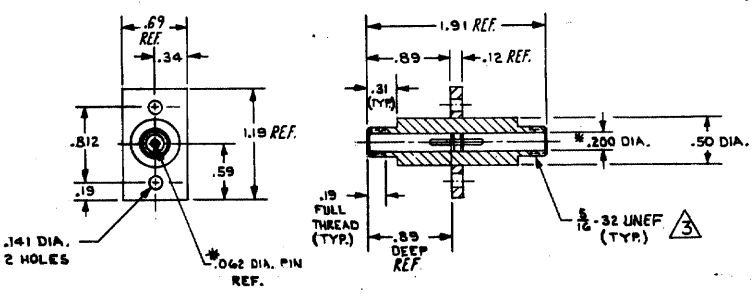

- RECEPTACLE TO MATE WITH AMP LGH-1/2 L LEAD ASSEMBLY. AVAILABLE SEPARATELY.
  - DIA'S. MARKED WITH ASTERISK \* TO BE CONCENTRIC WITHIN .015 T.I.R.
- 3 PER FEDERAL STANDARD H-28 3 WIRE METHOD. DIMENSION OVER WIRES TO BE: .307-.318.

QTY REQD	QTY REQD	ITEM NO.	DWG SIZE	PART OR IDENTIFYING NO.	NOMENCLATURE OR DESCRIPTION
		085 858856-2			RECEPTACLE (PIN GOLD PLATED)
		858856-1			RECEPTACLE (PIN TIN PLATED)

UNLESS OTHERWISE SPECIFIED: DIMENSIONS ARE IN INCHES TOLERANCES .00 = +.02 ANGLE = .000 = +.005				CONTRACT NO. DR 10Ecell 2-6-68		AMP INCORPORATED CAPITRON DIVISION ELIZABETHTOWN, PENNSYLVANIA	
MATERIAL: EPIALL 1904				CHK		NAME LGH-1/2 L RECEPTACLE, FEED THRU FOR BULKHEAD APPLICATIONS	
FINISH: NATURAL				APPD		DSGN APPD G.W. Raw 2-6-68	
NEXT ASSY		FINAL ASSY		NEXT ASSY		USED ON	
QTY REQD		AF PLICATION		SIZE B		CODE IDENT NO. NUMBER 89110 858856	
				OTHER APPD		SCALE NTS. WT SHEET 1 of 1	

AMP 1470 REV 8/68 5

4 3

2

CUSTOMER DRAWING