

4

3

2

1

THIS DRAWING IS UNPUBLISHED. RELEASED FOR PUBLICATION
 © COPYRIGHT BY TYCO ELECTRONICS CORPORATION. ALL RIGHTS RESERVED.

| LOC | DIST | REVISIONS | | | | | |
|-----|------|-----------|-----|-----------------------|---------|-----|-------|
| DF | S5 | P | LTR | DESCRIPTION | DATE | MIN | APPRO |
| | | C | | REV PER ECO-05-014721 | 01FEB06 | PY | DE |

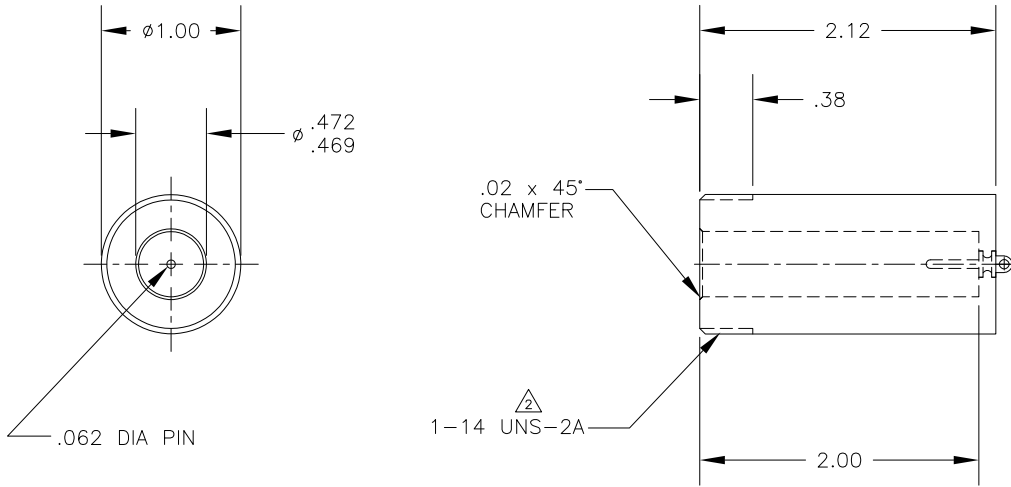

1. RECEPTACLE TO MATE WITH AMP LGH 4 LEAD ASSEMBLY, AVAILABLE SEPARATELY

2 PER FEDERAL STANDARD H-28, 3-WIRE METHOD. DIMENSION OVER WIRES TO BE .9975-1.0186

| | |
|---|------------|
| AS SHOWN WITH TIN PLATED PIN PER ASTM-B-545, .0001 THK | 5-836567-1 |
| AS SHOWN WITH GOLD PLATED PIT PER MIL-G-45024, TYPE II, CLASS 3 | 836567-2 |
| AS SHOWN WITH 93/7 TIN-LEAD PLATED PIN, .0001 THK | 836567-1 |

| DESCRIPTION | | PART NO | |
|--|---------------------------|------------------------------|----------------------|
| THIS DRAWING IS A CONTROLLED DOCUMENT. | | | |
| DESIGNED BY: P. YEAGER | DATE: 31JAN06 | Tyco Electronics Corporation | |
| CHKD BY: D. EASY | DATE: 01FEB06 | Harrisburg, Pa 17105-3608 | |
| APPROVED BY: D. EASY | DATE: 01FEB06 | Tyco Electronics | |
| PRODUCT SPEC: LGH-4 | NAME: RECEPTACLE ASSEMBLY | LGH-4 (FOR POTTED UNITS) | |
| APPLICATION SPEC: - | SIZE: A2 | CHG CODE: 00779 | DRAWING NO: C-836567 |
| WEIGHT: - | RESTRICTED TO: - | | SCALE: 4:1 |
| MATERIAL: MOLDED GLASS EPOXY | FINISH: BLACK | CUSTOMER DRAWING | SHEET 1 OF 1 REV C |

AMP 1471-9 REV 31JAN06

H:\docmod\836567_1_c.dwg

836567

A