

4

3

2

1

THIS DRAWING IS UNPUBLISHED. RELEASED FOR PUBLICATION - N/A.
 © COPYRIGHT N/A BY TYCO ELECTRONICS CORPORATION. ALL RIGHTS RESERVED.

LOC		DISTR		REVISIONS			
DF	SO	P	LTR	DESCRIPTION	DATE	MIN	APPR
		K		REV PER 0H14-0191-05	05-05	AA	DE

- ⚠ CUSTOMER MUST PROTECT BACK END AGAINST ARC OVER & BREAKDOWN IF BULKHEAD & MOUNTING HARDWARE ARE METALLIC & AT GROUND POTENTIAL.
- ⚠ MARKED PER MIL-STD-130.
- ⚠ THIS PART REQUIRES A MINIMUM AQL 0.65 TIGHTENED-LEVEL III INSPECTION PER MIL-STD-105E. INSPECTION SAMPLE IS TO BE SEPARATELY BAGGED OR IDENTIFIED. CERTIFICATE OF COMPLIANCE IS REQUIRED WITH DELIVERY OF PARTS.
- 4. RECEPTACLE TO MATE WITH ANY AMP LGH-1 LEAD ASSY.

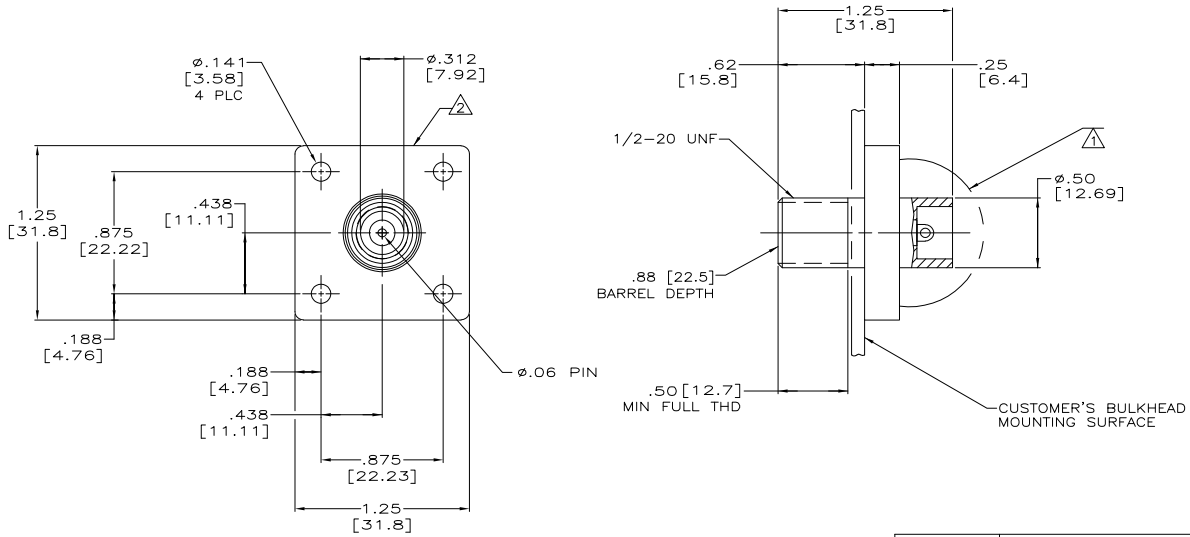

REMARKS	DESCRIPTION	PART NO.
-	RCPT ASSY (TIN PLATED PIN)	5-858827-1
⚠	RCPT ASSY (TIN-LEAD PLATED PIN)	858827-5
-	RCPT ASSY (GOLD PLATED PIN)	858827-2
-	RCPT ASSY (TIN-LEAD PLATED PIN)	858827-1

THIS DRAWING IS A CONTROLLED DOCUMENT.		DR: C.C. THOMAS 27-MAY-93	Tyco Electronics Corporation Harrisburg, Pa 17105-3608	
DIMENSIONS: INCHES		OK: D. EARY 02-JUN-93	BULKHEAD RCPT ASSY LGH-1	
MATERIAL: GLASS EPOXY COLDR: BLACK		APPR: D. EARY 02-JUN-93	SIZE: A2	CHG CODE: 00779
FINISH: -		APPLICATION SPEC: -	DRG NO: C-858827	RESTRICTED TO: -
		WEIGHT: -	SCALE: 2:1	SHEET: 1 OF 1
		CUSTOMER DRAWING		REV: K

AMP 1471-9 REV 31MM2000

858827

A