

4

3

2

1

THIS DRAWING IS UNPUBLISHED. RELEASED FOR PUBLICATION  
 BY TYCO ELECTRONICS CORPORATION. ALL RIGHTS RESERVED.

| LOC | DIST | REVISIONS |     |                       |         |     |     |
|-----|------|-----------|-----|-----------------------|---------|-----|-----|
| DF  | SO   | P         | LTR | DESCRIPTION           | DATE    | MIN | APD |
|     |      | C         |     | REV PER EDD 08-004838 | 2-28-08 | CT  | DE  |

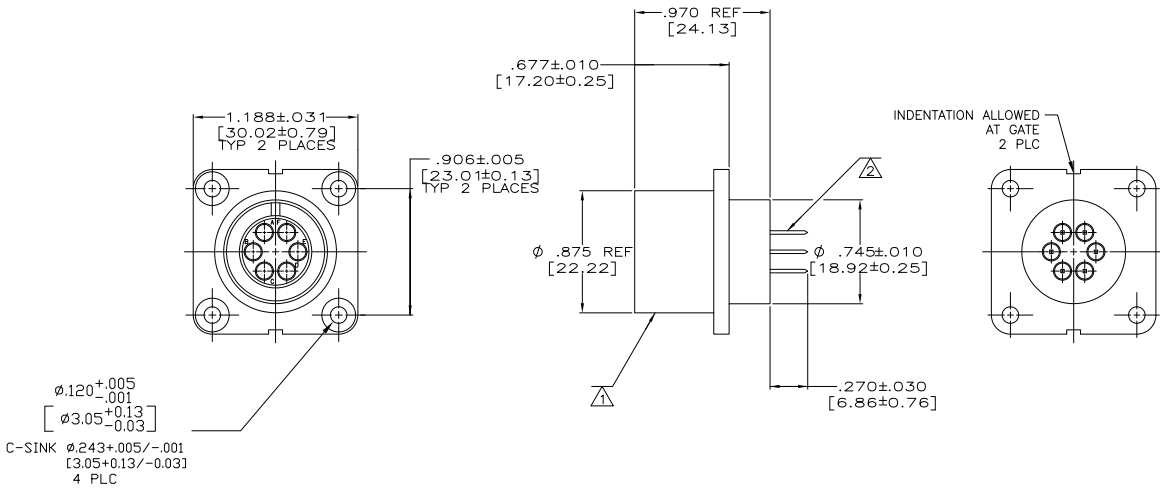

- ⚠ HOUSING IS NOT PROVIDED WITH THREADED FRONT SKIRT.
- ⚠ AMP TYPE III+, SIZE 16 SOCKET CONTACTS WITH .025 [0.63] SQUARE POSTS, 6 PLACES.
- 3. RECEPTACLE INTERFACE IS THE SAME AS MS 3102A-14S-6S EXCEPT  $\phi .875$  [22.23] IS NOT THREADED.
- ⚠ MAT'L: BRASS  
FINISH: .000100 MIN TIN-LEAD OVER .000050 MIN NICKEL
- ⚠ MAT'L: BRASS  
FINISH: .000100 MIN TIN OVER .000050 MIN NICKEL

|                           |            |
|---------------------------|------------|
| ⚠                         | 5-447913-1 |
| ⚠                         | 447913-1   |
| CONTACT MATERIAL & FINISH | PART NO.   |

| THIS DRAWING IS A CONTROLLED DOCUMENT. |  | DN               | 7-17-91 | Tyco Electronics Corporation  |           |
|--|--|------------------|---------|-------------------------------|-----------|
| DIMENSIONS:                            |  | OK               | 6-15-91 | Harrisburg, PA 17105-3608     |           |
| INCHES                                 |  | OK               | 6-15-91 | NAME                          |           |
| MATERIAL:                              |  | APD              | 9-15-91 | RECEPTACLE, 6 POSITION, LGH,  |           |
| HOUSING: BLACK POLYESTER               |  | FINISH           |         | WITH .025 [0.63] SQUARE POSTS |           |
| FINISH                                 |  | APPLICATION SPEC |         | SIZE                          | CAGE CODE |
|  |  | WEIGHT           |         | A2                            | 00779     |
|  |  | CUSTOMER DRAWING |         | C=                            | 447913    |
|  |  | SCALE            | 2:1     | SHEET                         | 1 of 1    |
|  |  | REV              |         | REV                           | C         |

AMP 1471-9 REV 31MM2000

28FEB2008 9:34am us016412 H:\docmod\447913\_1\_c.dwg