

DRAWING MADE IN AMERICAN PROJECTION

© 1968 BY AMP INCORPORATED, ALL RIGHTS RESERVED. AMP PRODUCTS COVERED BY PATENTS AND/OR PATENTS PENDING.

THIS PRODUCT DESIGNED AND BUILT BY AMP INCORPORATED. NO LICENSE TO USE THAT DESIGN IN MANUFACTURE, OR TO USE ANY ISSUED OR PENDING PATENTS WHICH ARE INVOLVED, IS IMPLIED.

850513

REVISIONS				
ZONE	LTR	DESCRIPTION	DATE	APPROVED
A		ADDED -2	RN 9/16/68	JM
B		OBSOLETE -2 ECN 53630	1/29/87	JM

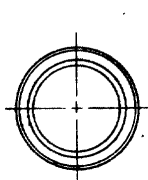

1/2-20UNF-2B THD.

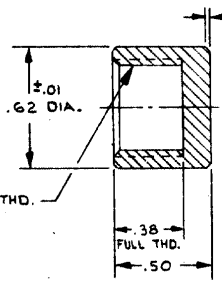

0.02 x 45° CHAMFER (TYP)

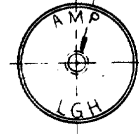
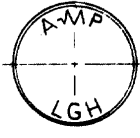

DRILL & TAP FOR #4-40 SCREW

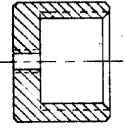

OBSOLETE 850513-2 SAME AS -1 EXCEPT: #4-40 HOLE, DRILLED & TAPPED



QTY REQD	QTY REQD	ITEM NO.	DWG SIZE	PART OR IDENTIFYING NO.	NOMENCLATURE OR DESCRIPTION	SYMBOL
-2	-1					

UNLESS OTHERWISE SPECIFIED: DIMENSIONS ARE IN INCHES TOLERANCES .001 - .02 ANGLES ± 2° .000 - 3		CONTRACT NO. DR <i>ECN 6-27-68</i>	AMP AMP INCORPORATED CAPTRON DIVISION ELIZABETHTOWN, PENNSYLVANIA
MATERIAL: <i>ALUMINUM</i>		NAME LGH-1 1/2 IL CAP (DUST COVER)	
FINISH: <i>GREEN</i>		APPD <i>JM</i>	SIZE B
NEXT ASSY		OTHER APPD	CODE IDENT NO. 00779
FINAL ASSY		SCALE 2:1	NUMBER 850513
NEXT ASSY		APPLICATION	WT
QTY REQD			SHEET 1 OF 1