

THIS DRAWING IS UNPUBLISHED.
 VERTRAULICHE UNVERÖFFENTLICHTE ZEICHNUNG
 © COPYRIGHT 1997

RELEASED FOR PUBLICATION
 FRIEDRICH VERÖFFENTLICHUNG
 BY AMP INCORPORATED. ALL RIGHTS RESERVED.
 ALLE RECHTE VORBEHALTEN

MATED WITH:
 PASSEND ZU:
 H.N.D.15

LOC	DIST	REVISIONS ÄNDERUNGEN			
P	LTR	DESCRIPTION BESCHREIBUNG	DATE	DWR	APVD
A1	-				
PROJEKT NR.:		A2 auf neue Design geändert Eg00-1877-01	25.06.01	SR	SH

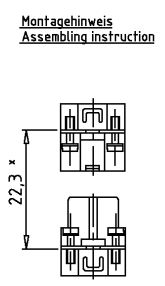
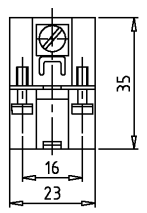
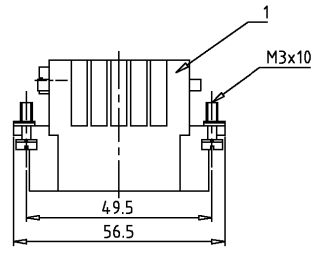

Kontaktanordnung
 Contact arrangement

Ansicht Anschlußseite
 view from termination side

* Abstand für sichere Kontaktgabe max: 24 mm

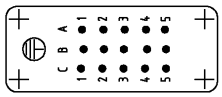

Notes:

- 1 Material: insert, PC
UL-File Nr.: E101788(R)
- 2 Finish: zinc plated
contact: Ag, Au

Bemerkungen:

- 1 Material: Einsatz: PC
UL-File Nr.: E101788(R)
- 2 Oberfläche: verzinkt
Kontakte: Ag, Au

Montageausschnitt

bei Verwendung ohne Gehäuse

Panel cut-out for contact insert

when used without housing

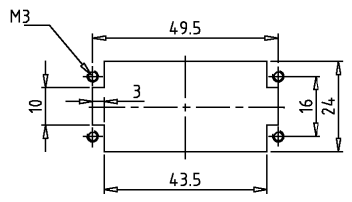

1	Stifteinsatz H.N.D.15. Crimp	Material	dunkelgrau	1	
2-3	DESCRIPTION / BENENNUNG	MATERIAL	COLOR / FARBE	ITEM NO. POS.	REMARKS / BEMERKUNGEN
H.N.D.15.S.H.C ORDERING TEXT / BESTELLTEXT	<p>THIS DRAWING IS A CONTROLLED DOCUMENT FOR AMP INCORPORATED. IT IS SUBJECT TO CHANGE AND THE CONTROLLING ENGINEERING ORGANIZATION SHOULD BE CONTACTED FOR THE LATEST REVISIONS. OTHER ORGANIZATIONS MUST BE KEPT INFORMED BY APPROPRIATE MEANS. ADJUSTMENTS OF COPY TECHNIQUE FOR CORRECT ORDER, AND VISUALS FOR THE JOURNAL LETTERS WITH THE APPROPRIATE HAND OFFERED BY AMP.</p>				
	<p>DIMENSIONS: DIMENSIONEN: m/m</p> <p>TOLERANCES UNLESS OTHERWISE SPECIFIED: ALLGEMEINTOLERANZEN</p> <p>0 PLC ± 0.15 mm 1 PLC ± 0.25 mm 2 PLC ± 0.30 mm 3 PLC ± 0.40 mm</p>		<p>DWN Schneider 18.02.1998 CHW 28.07.1998 Schweiger</p>		
	<p>MATERIAL</p>		<p>NAME: AMP PRODUCT SPEC: - APPLICATION SPEC: - VERARBEITUNGSSPEZ.: -</p>		
	<p>FINISH / OBERFLÄCHE / FARBE</p>		<p>WEIGHT / GEWICHT: 57 g CUSTOMER DRAWING</p>		
		<p>HTS Elektrotechnik 53819 Neunkirchen, Germany</p>		<p>Male insert H.N.D.15 Stifteinsatz H.N.D.15</p>	
		<p>SIZE: A3 CAGE CODE: 00779 DRAWING NO. / ZEICHNUNGS-NR.: 1103106</p>		<p>RESTRICTED TO NUR FÜR: -</p>	
		<p>MASSSTAB: 1:1 BLATT: 1 OF VON: 1</p>		<p>REV: A2</p>	