

HC-B 24-AMQ

Order No.: 1771927



<http://eshop.phoenixcontact.de/phoenix/treeViewClick.do?UID=1771927>

HEAVYCON panel mounting base B24, with double locking latch, height 27 mm

Commercial data	
EAN	4017918036607
Pack	10 pcs.
Customs tariff	85389099
Weight/Piece	0.14043 KG
Catalog page information	Page 499 (PC-2009)

Product notes

WEEE/RoHS-compliant since:
01/18/2006



<http://www.download.phoenixcontact.com>
Please note that the data given here has been taken from the online catalog. For comprehensive information and data, please refer to the user documentation. The General Terms and Conditions of Use apply to Internet downloads.

Technical data

General data	
Note	For contact inserts HC-B24, BB46, D64, DD108, M
Design	B24
Height	27 mm
Width	43 mm
Length	140 mm

Housing type	Panel mounting base, straight
Locking type	With double locking latch
Degree of protection	IP65
Ambient temperature (operation)	-40 °C ... 125 °C
Housing material	Aluminum, die-cast
Housing surface material	Powder-coated, gray
Seal material	NBR
Locking latch material	High-grade steel, handle: PA-GF
Material grip body interlock	PA-GF
Length of the assembly cutout	113 mm
Width of the assembly cutout	35 mm

Certificates / Approvals



Certification

GOST

Diagrams/Drawings

Dimensioned drawing

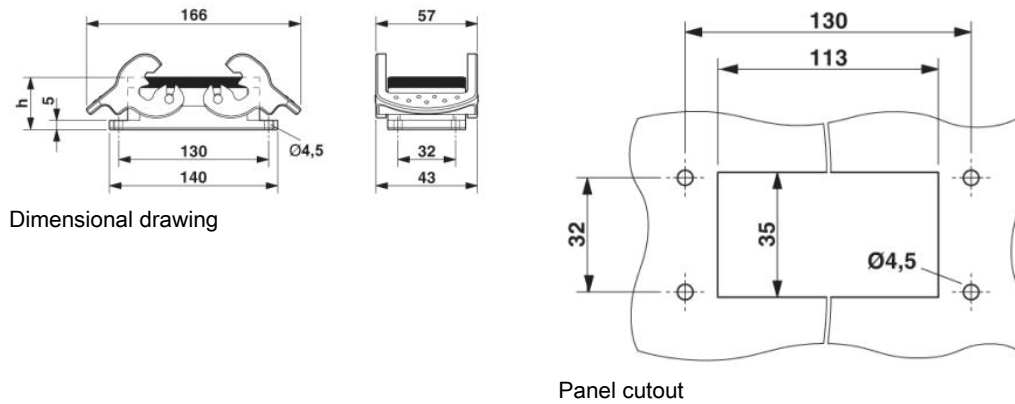

Address

PHOENIX CONTACT Inc., USA
586 Fulling Mill Road
Middletown, PA 17057, USA
Phone (800) 888-7388
Fax (717) 944-1625
<http://www.phoenixcon.com>



© 2010 Phoenix Contact
Technical modifications reserved;