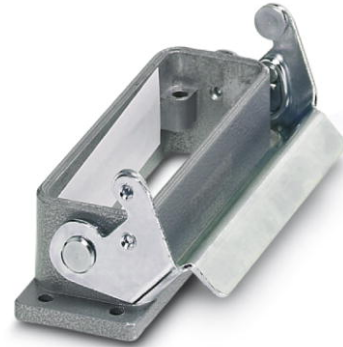

HC-D 25-AML

Order No.: 1772463

<http://eshop.phoenixcontact.de/phoenix/treeViewClick.do?UID=1772463>HEAVYCON panel mounting base D25, with single locking latch,
height 26 mm

Commercial data	
EAN	4017918037130
Pack	10 pcs.
Customs tariff	85389099
Weight/Piece	0.09746 KG
Catalog page information	Page 513 (PC-2009)

Product notesWEEE/RoHS-compliant since:
03/01/2006

<http://www.download.phoenixcontact.com>
Please note that the data given here has been taken from the online catalog. For comprehensive information and data, please refer to the user documentation. The General Terms and Conditions of Use apply to Internet downloads.

Technical data

General data	
Note	For contact inserts HC-D25, A16
Design	D25
Height	26 mm
Width	30.5 mm
Length	96 mm

Housing type	Panel mounting base, straight
Locking type	With single locking latch
Degree of protection	IP65
Ambient temperature (operation)	-40 °C ... 125 °C
Housing material	Aluminum, die-cast
Housing surface material	Powder-coated, gray
Seal material	NBR
Locking latch material	Steel, galvanized
Length of the assembly cutout	74 mm
Width of the assembly cutout	24 mm

Certificates / Approvals



Certification

GOST

Diagrams/Drawings

Dimensioned drawing

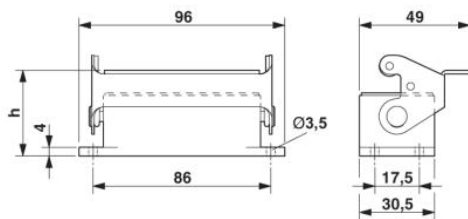

Address

PHOENIX CONTACT Deutschland GmbH
Flachsmarktstr. 8
32825 Blomberg, Germany
Phone +49 5235 3 12000
Fax +49 5235 3 41200
<http://www.phoenixcontact.de>



© 2010 Phoenix Contact
Technical modifications reserved;