

DATE SHOWN TO SUPPLIERS: RECEIVED FOR FABRICATION
 BY THIS ELECTRONICS CORPORATION. ALL DIMENSIONS UNLESS OTHERWISE SPECIFIED

REVISED		REVISIONS	
NO.	DATE	DESCRIPTION	BY
A	ECR-08-027804		IMD/CMB EJM DB
A1	REV PER ECR-10-016231		IMD/CMB IL CT

△ MATERIAL:
 HOUSINGS: THERMOPLASTIC, PPE-PS*
 ALIGNMENT SLEEVES: CERAMIC OR PHOS. BRONZE
 PROTECTIVE COVERS: THERMOPLASTIC ELASTOMER*
 * UL 94 V-0 RATED AT QUALIFYING THICKNESS

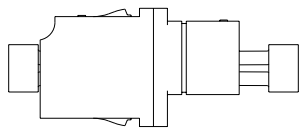

SIDE VIEW WITH PROTECTIVE COVERS SHOWN

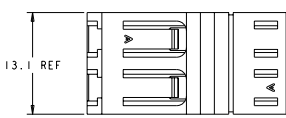

13.1 REF

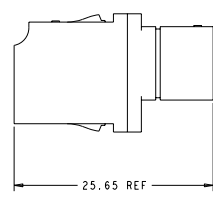
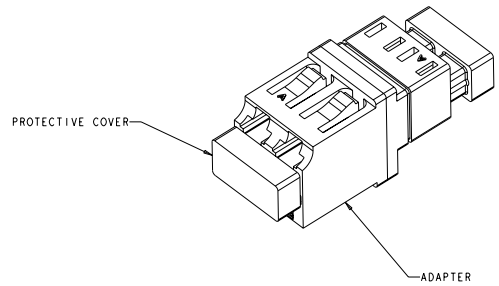

PROTECTIVE COVERS NOT SHOWN

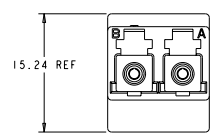

15.24 REF

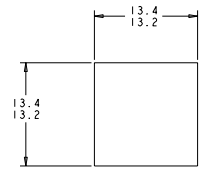

RECOMMENDED PANEL CUTOUT
 MAX PANEL THK. 1.7

BEIGE	PHOS. BRONZE	1985150-4
BLUE	PHOS. BRONZE	1985150-3
BEIGE	CERAMIC	1985150-2
BLUE	CERAMIC	1985150-1
ADAPTER COLOR ALIGNMENT SLEEVE		PART NO.

DATE: 06/20/07 DRAWN BY: [Signature] CHECKED BY: [Signature] APPROVED BY: [Signature]		DATE: 06/20/07 DRAWN BY: [Signature] CHECKED BY: [Signature] APPROVED BY: [Signature]		DATE: 06/20/07 DRAWN BY: [Signature] CHECKED BY: [Signature] APPROVED BY: [Signature]	
TITLE: LC ADAPTER ASSEMBLY, SR-JR		PART NO.: 1985150		CUSTOMER DRAWING	