

4

3

2

1

THIS DRAWING IS UNPUBLISHED. RELEASED FOR PUBLICATION 20
 © COPYRIGHT 20 BY TYCO ELECTRONICS CORPORATION. ALL RIGHTS RESERVED.

LOC	DIST	REVISIONS				
P	LTR	DESCRIPTION	DATE	DWN	APVD	
CE	16					
		D1 ECR-09-003452	13FEB2009	KG	DW	

NOTES:

- USE WITH FERRULE ASSEMBLY KIT P/N 1588908-2 (125um), OR 1588908-1 (126um). QUANTITY OF 4 REQUIRED. FERRULE MUST BE PC-POLISHED DURING FIBER TERMINATION FOR BEST PERFORMANCE.
- PROTECTIVE LABEL APPLIED AFTER FINAL CLEAN ROOM TEST TO PREVENT OPTICAL CAVITY CONTAMINATION. REMOVE ONLY WHEN READY TO ASSEMBLE.
- SINGLEMODE IDENTIFIER
- THIS PRODUCT HAS NOT COMPLETED VALIDATION TESTING.

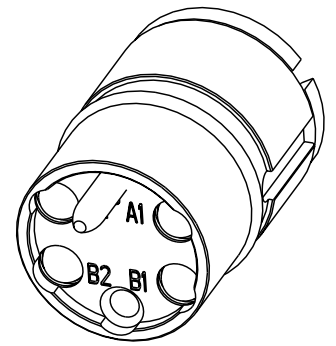
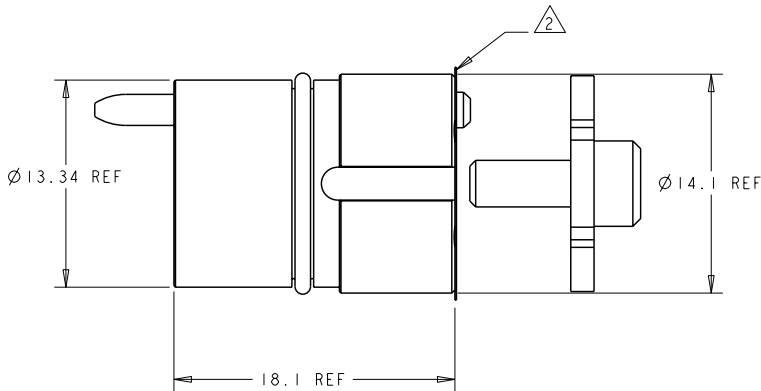
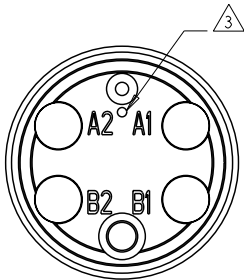

SCALE 4:1

4 CHANNEL, 1310nm SM	1515740-1
DESCRIPTION	PART NO.

<small>THIS DRAWING IS A CONTROLLED DOCUMENT FOR TYCO ELECTRONICS CORPORATION IT IS SUBJECT TO CHANGE AND THE CONTROLLING ENGINEERING ORGANIZATION SHOULD BE CONTACTED FOR THE LATEST REVISION.</small>		DWN 08OCT2002 E. HOPKINS CHG 08OCT2002 D. WERTMAN APVD 08OCT2002 D. WERTMAN	Tyco Electronics Harrisburg, PA 17105-3608
DIMENSIONS: mm	TOLERANCES UNLESS OTHERWISE SPECIFIED: 0 PLC ±. 1 PLC ±. 2 PLC ±. 3 PLC ±. 4 PLC ±. ANGLES ±	NAME INSERT ASSEMBLY, 4 CHANNEL, 1310nm SM, PRO BEAM JR.	RESTRICTED TO
MATERIAL STAINLESS ALLOYS & NBR	FINISH N/A	PRODUCT SPEC APPLICATION SPEC WEIGHT CUSTOMER DRAWING	SIZE CAGE CODE DRAWING NO A3 00779 C-1515740
AMP 1470-19 REV 31MAR2000		SCALE 4:1	SHEET 1 OF 1 REV D1