

4

3

2

1

THIS DRAWING IS UNPUBLISHED. RELEASED FOR PUBLICATION BY TYCO ELECTRONICS CORPORATION. ALL RIGHTS RESERVED. COPYRIGHT 20

REV	DATE	BY	CHKD	APPROV
A	06JUN04	KG	DW	
B	20APR06	KG	DW	
C	19JUN07	KG	DW	
D	21AUG07	KG	DW	

- NOTES:**
- THIS PRODUCT HAS NOT COMPLETED VALIDATION TESTING.
  - PROTECTIVE LABEL APPLIED AFTER FINAL CLEAN ROOM TEST TO PREVENT OPTICAL CAVITY CONTAMINATION. REMOVE ONLY WHEN READY TO ASSEMBLE.
  - DUAL WAVELENGTH 850/1300nm IDENTIFIER.
  - FOR USE WITH JACKETED CABLE FERRULE ASSEMBLY P/N 1754456-3, ONE PER FIBER. FERRULES MUST BE FLAT-POLISHED.
  - FOR USE WITH FERRULE ASSEMBLY KIT P/N 1754699-1, ONE PER FIBER. FERRULES MUST BE FLAT-POLISHED.

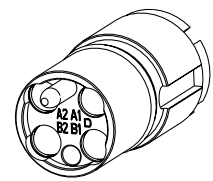

1374759-2

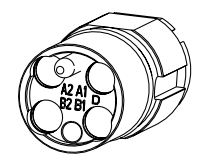

1374759-1

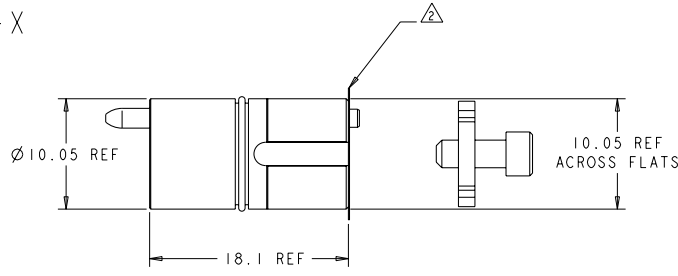

1374759-1

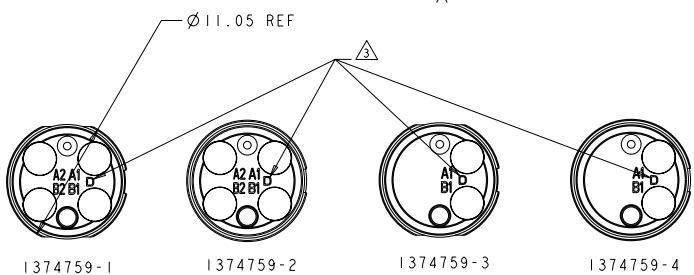

VIEW X-X (SHOWN WITHOUT PROTECTIVE LABEL)

2 CHANNEL, 850/1300nm MM	1374759-8
2 CHANNEL, 850/1300nm MM, ARINC	1374759-7
4 CHANNEL, 850/1300nm MM	1374759-6
4 CHANNEL, 850/1300nm MM, ARINC	1374759-5
2 CHANNEL, 850/1300nm MM	1374759-4
2 CHANNEL, 850/1300nm MM, ARINC	1374759-3
4 CHANNEL, 850/1300nm MM	1374759-2
4 CHANNEL, 850/1300nm MM, ARINC	1374759-1

DIMENSIONS: mm		TOLERANCES UNLESS OTHERWISE SPECIFIED:		DATE: 19APR2004		Tyco Electronics	
0 PLC ±.01		1 PLC ±.02		DESIGNER: R. GLATFELT		Harrisburg, PA 17105-3608	
2 PLC ±.03		3 PLC ±.04		CHECKED: D. WERTMAN		NAME: INSERT ASSEMBLY, MINI EB	
4 PLC ±.05		ANGLES ±.01		APPROVED: D. WERTMAN		850/1300nm, MM	
FINISH		MATERIAL: STAINLESS ALLOYS & NBR		WEIGHT: N/A		RESTRICTED TO: -	
CUSTOMER DRAWING		SCALE: 4:1		SHEET: 1 OF 1		REV: D	