

4

3

2

1

THIS DRAWING IS UNPUBLISHED. RELEASED FOR PUBLICATION 20
 © COPYRIGHT 20 BY TYCO ELECTRONICS CORPORATION. ALL RIGHTS RESERVED.

LOC	DIST	REVISIONS					
CE	16	P	LTR	DESCRIPTION	DATE	DWN	APVD
		C		RELESE PER 0A00-0031-03	03FEB03	KG	DW
		D		REVISE PER 0A00-0359-03	28OCT03	KG	DW
		DI		ECR-09-003452	16FEB2009	KG	DW

1. ALL DIMENSIONS ARE FOR REFERENCE ONLY.
2. OPTIMIZED FOR 1550nm OPERATION IDENTIFIER.
3. SINGLEMODE IDENTIFIER.
4. PROTECTIVE LABEL APPLIED AFTER FINAL CLEAN ROOM TEST TO PREVENT OPTICAL CAVITY CONTAMINATION. REMOVE ONLY WHEN READY TO ASSEMBLE.
5. USE WITH FERRULE ASSEMBLY KIT P/N 1515778-7 (125um), OR 1515895-1 (126um), OR 1588908-1 (SEALED 126um). FERRULE MUST BE PC-POLISHED DURING FIBER TERMINATION FOR BEST PERFORMANCE.
6. THIS PRODUCT HAS NOT COMPLETED VALIDATION TESTING.

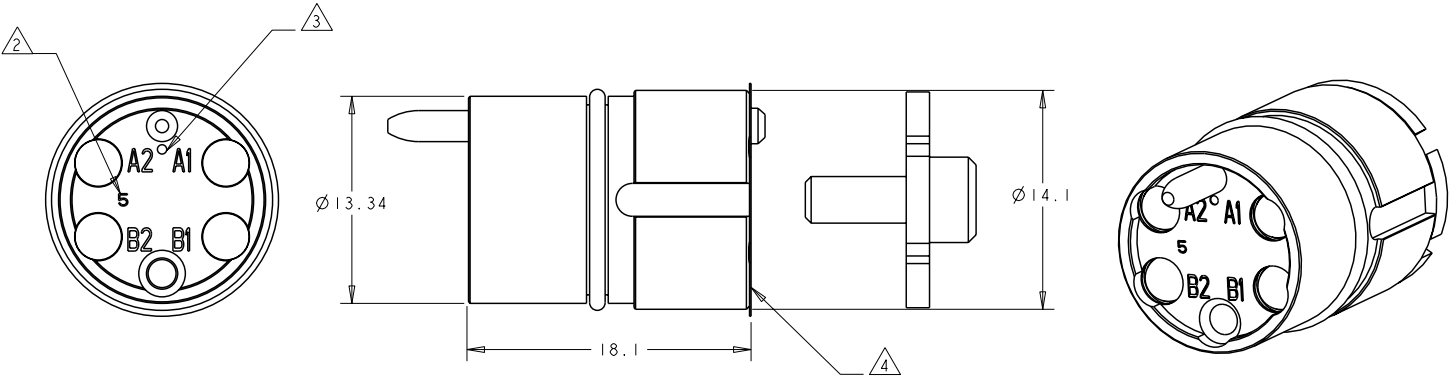

1516041-1
 PART NUMBER

<small>THIS DRAWING IS A CONTROLLED DOCUMENT FOR TYCO ELECTRONICS CORPORATION. IT IS SUBJECT TO CHANGE AND THE CONTROLLING ENGINEERING ORGANIZATION SHOULD BE CONTACTED FOR THE LATEST REVISION.</small>		DWN 22 JAN 2003 K. GLATFELTER CHG 23 JAN 2003 D. WERTMAN APVD 31 JAN 2003 D. WERTMAN	Tyco Electronics Harrisburg, PA 17105-3608
DIMENSIONS: mm	TOLERANCES UNLESS OTHERWISE SPECIFIED: 0 PLC ±- 1 PLC ±- 2 PLC ±- 3 PLC ±- 4 PLC ±- ANGLES ±-	NAME INSERT ASSEMBLY, PRO BEAM JR. 4 CHANNEL, 1550nm SM	RESTRICTED TO -
MATERIAL STAINLESS ALLOYS & NBR	FINISH N/A	PRODUCT SPEC APPLICATION SPEC WEIGHT CUSTOMER DRAWING	SIZE A3
		CAGE CODE 00779	DRAWING NO 1516041
		SCALE 4:1	SHEET 1 OF 1
		REV DI	

AMP 1470-19 REV 31MAR2000
 Pro/ENGINEER DRAWING