

THIS DRAWING IS UNPUBLISHED. RELEASED FOR PUBLICATION
 BY TYCO ELECTRONICS CORPORATION. ALL RIGHTS RESERVED.

REV	DATE	BY	CHKD	APPROV
I	02/20/08	KG	DW	
A	29/02/2008	KG	DW	
B	11/06/2010	KG	DW	

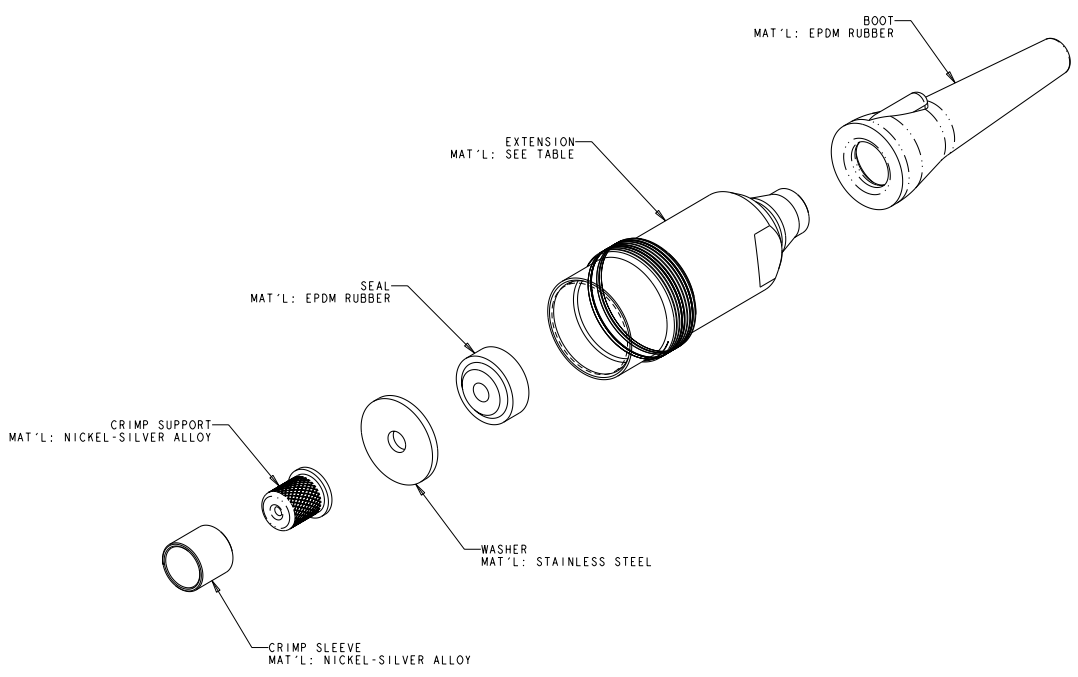

EXTENSION MATERIAL	MAXIMUM CABLE DIAMETER	PART NUMBER
ALUMINUM	7.5mm	2-1918932-4
	6.7mm	2-1918932-3
	6.0mm	2-1918932-2
	5.5mm	2-1918932-1
	5.0mm	2-1918932-0
	4.2mm	1-1918932-9
NICKEL ALUMINUM BRONZE	3.6mm	1-1918932-8
	3.2mm	1-1918932-7
	7.5mm	1-1918932-6
	6.7mm	1-1918932-5
	6.0mm	1-1918932-4
	5.5mm	1-1918932-3
ALUMINUM	5.0mm	1-1918932-2
	4.2mm	1-1918932-1
	3.6mm	1-1918932-0
	3.2mm	1918932-9
	7.5mm	1918932-8
	6.7mm	1918932-7
ALUMINUM	6.0mm	1918932-6
	5.5mm	1918932-5
	5.0mm	1918932-4
	4.2mm	1918932-3
	3.6mm	1918932-2
	3.2mm	1918932-1

1. PACKAGED LOOSE PIECE.
 2. DIMENSIONS ARE FOR REFERENCE ONLY.
- FINISH: HARD ANODIZE.
 - FINISH: OLIVE DRAB.

DIMENSIONS: mm 0 PLC ± 1 PLC ± 2 PLC ± 3 PLC ± 4 PLC ± ANGLES ± FINISH		OPERATING SPEC'S: 3 4	DWG: 270022006 DESIGNED BY: R. GLATFELT DATE: 02 JUN 2008 APPROVED BY: D. WERIMAN DATE: 02 JUN 2008 APPLICATION SPEC: WEIGHT: CUSTOMER DRAWING	NAME: CABLE ADAPTER KIT, SEALED BULKHEAD, PRO BEAM JR. CASE CODE: A200779 DRAWING NO: 1918932 SCALE: 2:1 SHEET: 1 OF 1 REV: B	Tyco Electronics Harrisburg, PA 17105-3608
---	--	--------------------------	---	--	---

AMP 1471-B REV 3/04/02/00
 Pre-ENGINEER DRAWING