

4

3

2

1

THIS DRAWING IS UNPUBLISHED. RELEASED FOR PUBLICATION
 © COPYRIGHT BY TYCO ELECTRONICS CORPORATION. ALL RIGHTS RESERVED.

LOC		DIBT		REVISIONS			
GP	00	P	LTR	DESCRIPTION	DATE	MIN	APD
		F		REVISED PER ECO-09-001588	12/JUN/2009	CJV	CWR
		F1		REVISED PER ECO-09-021826	6/JAN/10	KK	AEJ

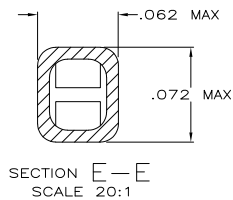
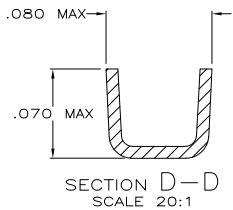
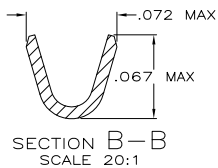
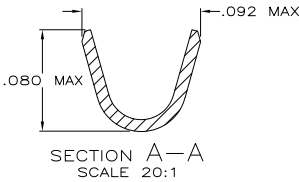
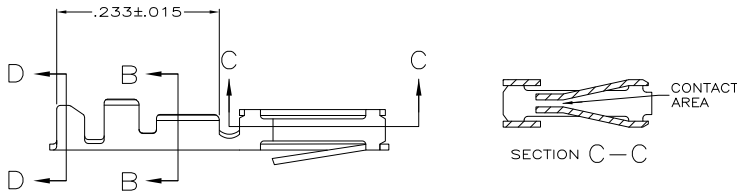
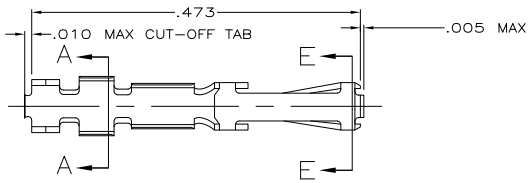

- △ FINISH: GOLD FLASH ALL OVER, .000015 MIN THK GOLD ON LOCALIZED CONTACT PLATING AREA OVER .000050 MIN THK NICKEL ON ENTIRE CONTACT,
-OR-
.000050 MIN THK NICKEL UNDERPLATE ON ENTIRE CONTACT, GOLD FLASH OVER PALLADIUM-NICKEL, .000015 MIN TOTAL THK ON LOCALIZED CONTACT PLATING AREA AND GOLD FLASH OVER REMAINDER OF CONTACT.
- △ FINISH: GOLD FLASH ALL OVER, .000030 MIN THK GOLD ON LOCALIZED CONTACT PLATING AREA OVER .000050 MIN THK NICKEL ON ENTIRE CONTACT,
-OR-
.000050 MIN THK NICKEL UNDERPLATE ON ENTIRE CONTACT, GOLD FLASH OVER PALLADIUM-NICKEL, .000030 MIN TOTAL THK ON LOCALIZED CONTACT PLATING AREA AND GOLD FLASH OVER REMAINDER OF CONTACT.
- △ FINISH: GOLD FLASH ALL OVER, .000050 MIN THK GOLD ON LOCALIZED CONTACT PLATING AREA OVER .000050 MIN THK NICKEL ON ENTIRE CONTACT,
-OR-
.000050 MIN THK NICKEL UNDERPLATE ON ENTIRE CONTACT, GOLD FLASH OVER PALLADIUM-NICKEL, .000050 MIN TOTAL THK ON LOCALIZED CONTACT PLATING AREA AND GOLD FLASH OVER REMAINDER OF CONTACT.
- △ FINISH: .000100 MIN THK BRIGHT TIN-LEAD OVER .000050 MIN THK NICKEL ON ENTIRE CONTACT.
- △ FINISH: .000050 MIN THK GOLD ON ALL EXTERIOR SURFACES, INSIDE OF RCPT. BOX (EXCLUDING PREPLATED CONTACT AREAS) MAY HAVE .000003 MIN THK GOLD, ALL OVER .000050 MIN THK GOLD ON LOCALIZED CONTACT PLATING AREA OVER .000050 MIN THK NICKEL ON ENTIRE CONTACT.
- 6. FOR 22-26 AWG WIRE WITH AN INSULATION RANGE OF .040-.056 DIA.
- △ FINISH: .000100 MIN THK TIN OVER .000050 MIN THK NICKEL ON ENTIRE CONTACT.
- △ OBSOLETE PARTS: OBSOLETE CIS STREAMLINING PER D.RENAUD/D.SINISI

OBSOLETE △	2-86566-0	△ 1-86571-1
△	1-86566-6	△ 1-86571-0
△	86566-8	86571-8
△	86566-6	86571-6
△	86566-4	86571-4
△	86566-2	86571-2
FINISH	REELED PART NO	PART NO

THIS DRAWING IS A CONTROLLED DOCUMENT.

DIMENSIONS: INCHES	DESIGNED BY: S. MOYER 6-8-89	DATE: 6-8-89	TYCO ELECTRONICS CORPORATION Harrisburg, PA 17105-3608
OTHER DIMENSIONS: OTHER UNITS: NONE	CHK: D.L. ROCKER 6-8-89	DATE: 6-8-89	CONTACT, RCPT., ROUND WIRE, .100 E FFC
APPROVED: S.G.D. MILLER 6-14-89	NAME: S.G.D. MILLER	DATE: 6-14-89	SIZE: A2
PRODUCT SPEC: 108-9024	APPLICATION SPEC: 114-16003	WEIGHT: -	RESTRICTED TO: -
MATERIAL: PHOS. BRONZE	FINISH: SEE TABLE	SCALE: 10:1	SHEET: 1 of 1
CUSTOMER DRAWING		REV: F1	

AMP 1471-9 REV 31MM2000

86571

A