

4

3

2

1

THIS DRAWING IS UNPUBLISHED. RELEASED FOR PUBLICATION. ALL RIGHTS RESERVED.

LOC	DIST	REVISIONS					
GP	00	P	LTR	DESCRIPTION	DATE	BY	APPD
		E1		REVISED PER ECO-11-004835	11MAR11	RK	HMR

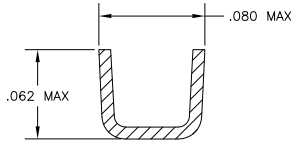
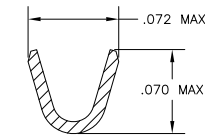
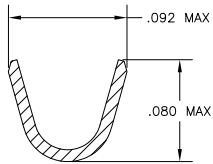
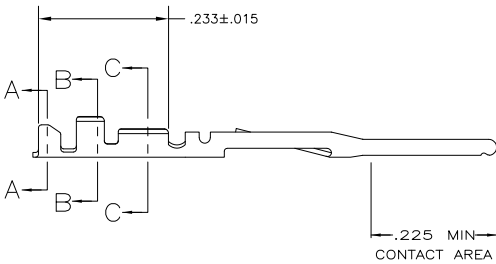
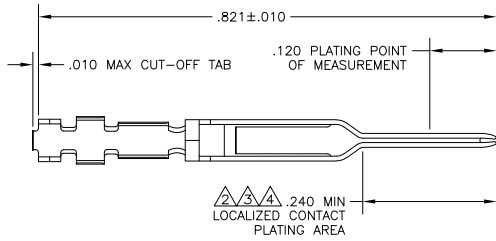

- 1 FINISH: .000100 MIN THK BRIGHT TIN LEAD OVER .000050 MIN THK NICKEL ON ENTIRE CONTACT.
- 2 FINISH: .000015 THK GOLD IN LOCALIZED CONTACT PLATING AREA AND GOLD FLASH IN OTHER AREAS OVER .000050 MIN NICKEL ON ENTIRE CONTACT.  
-OR-  
GOLD FLASH OVER PALLADIUM-NICKEL, .000015 MIN TOTAL THK IN LOCALIZED CONTACT PLATING AREA AND GOLD FLASH ON REMAINDER OVER .000050 MIN NICKEL ON ENTIRE CONTACT.
- 3 FINISH: .000030 THK GOLD IN LOCALIZED CONTACT PLATING AREA AND GOLD FLASH IN OTHER AREAS OVER .000050 MIN NICKEL ON ENTIRE CONTACT,  
-OR-  
GOLD FLASH OVER PALLADIUM-NICKEL, .000030 MIN TOTAL THK IN LOCALIZED CONTACT PLATING AREA AND GOLD FLASH ON REMAINDER OVER .000050 MIN NICKEL ON ENTIRE CONTACT.
- 4 FINISH: .000050 THK GOLD IN LOCALIZED CONTACT PLATING AREA AND GOLD FLASH IN OTHER AREAS OVER .000050 MIN NICKEL ON ENTIRE CONTACT,  
-OR-  
GOLD FLASH OVER PALLADIUM-NICKEL, .000050 MIN TOTAL THK IN LOCALIZED CONTACT PLATING AREA AND GOLD FLASH ON REMAINDER OVER .000050 MIN NICKEL ON ENTIRE CONTACT.
- 5. FOR 22-26 AWG WIRE WITH AN INSULATION RANGE OF .040-.056 DIA.
- 6 FINISH: .000100 MIN THK TIN OVER .000050 MIN THK NICKEL ON ENTIRE CONTACT.

SECTION B-B SCALE 20:1

SECTION C-C SCALE 20:1

SECTION A-A SCALE 20:1

6	1-86557-9	1-86561-0
4	1-86557-4	86561-9
4	86557-7	86561-7
4	86557-6	86561-6
4	86557-4	86561-4
FINISH	REELED PART NO	PART NO

THIS DRAWING IS A CONTROLLED DOCUMENT.

DESIGNED BY: J. GALLUCCI 6-27-89	DATE: 6-27-89
CHECKED BY: S.L. ROCKER 6-28-89	DATE: 6-28-89
APPROVED BY: S.D. MILLER 6-29-89	DATE: 6-29-89
PRODUCT SPEC: 108-9024	APPLICATION SPEC: 114-16003
WEIGHT: -	SIZE: A2
MATERIAL: PHOS. BRONZE	FINISH: SEE TABLE
CUSTOMER DRAWING	SCALE: 8:1

TE Connectivity  
CONTACT, PIN, .025 SQ  
ROUND WIRE, .100 CENTERLINE,  
FFC

RESTRICTED TO: -  
SHEET 1 of 1 REV E1