

- NOTES:
- MATERIALS:
    - HOUSING: GLASS FILLED LCP (LIQUID CRYSTAL POLYMER), UL 94V-0, COLOR: BLACK.
    - MOLDED STICK: GLASS FILLED LCP (LIQUID CRYSTAL POLYMER), UL 94V-0, COLOR: BLACK.
    - MALE TERMINAL: PHOSPHOR BRONZE
    - OUTER SHELL: DEEP DRAWN STEEL.
  - PLATING :
    - TERMINAL: .000030/(0.000762) MINIMUM GOLD IN SELECTIVE AREA; .000100/(0.00254) MINIMUM TIN IN SELECTIVE AREA; OVER NICKEL UNDERPLATE OVERALL.
    - OUTER SHELL: .000150/(0.00381) MINIMUM TIN OVER .000050/(0.00127) MINIMUM NICKEL OVER COPPER FLASH OVERALL (OPTIONAL).
  - CONFORMS TO PRODUCT SPECIFICATION PS-70928.
  - PARTS TO BE PACKAGED IN TUBES.
  - THREAD GAUGE MAY REQUIRE UP TO 1 IN.-LB. OF TORQUE DURING GAUGING PROCESS.

NOTE FOR LEAD FREE CONVERSION:  
 THE PRIMARY SHIPPING CARTON WILL BE LABELED \*COMPLIANT TO ROHS DIRECTIVE 2002/95/EC AND ELV ANNEX II OF DIRECTIVE 2000/53/EC\*. CARTONS WITHOUT THIS LABEL MAY CONTAIN PRODUCT WITH LEAD.

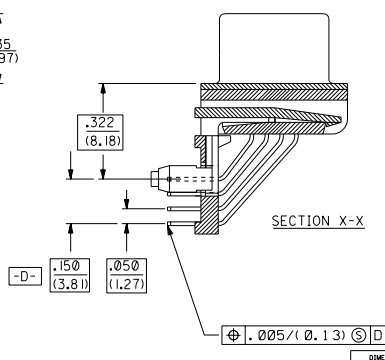
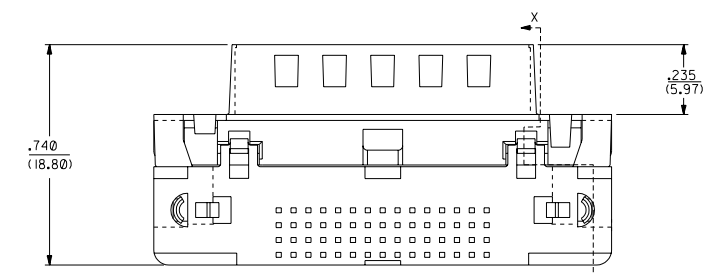

PART NUMBER	ENGINEERING NUMBER	DIM. 'A'
015-92-2250	70929-0001	.092±.012
015-92-2253	70929-0002	.104±.012

REV.	DATE	DESCRIPTION
2	F I	REVISIONS
1	G	REVISIONS
0	A	RELEASED PER ECR U10958 MOS 5.16.91
	B	MODIFIED PER ECR U12081 MOS 10.25.91
	C	MODIFIED PER ECR U12051 DRS 07.15.92
	C1	MODIFIED PER ECR U140503 DRS 4.15.94
	C2	REVISIED PER ECR U6641 DRS 12/01/95
	D	REVISIED PER ECR U61233 DRS 04/03/96
	D1	REVISIED PER ECR U61485 DRS 05/23/96
	F	REVISIED PER ECR U70417 SCHMIDG 96/11/08
	F1	REVISIED PER ECR U81031 O'DELL 97/10/24
	G	LEADFREE ECR* UCP2004-1998 DMORGAN 04/04/14

MOLE INCORPORATED 60532

SEE CHART SDA-70929-0001

DATE 12/17/90

SHEET NO. 1 OF 2

FILE NAME 570929X1

APP'D. CAB

SCALE 4:1

DRG. NO. 60532

NO DRAWING CONTAINS INFORMATION THAT IS PROPRIETARY TO MOLE INC. AND SHOULD NOT BE USED WITHOUT WRITTEN PERMISSION.

13 12 11 10 9 8 7 6 5 4 3 2 1

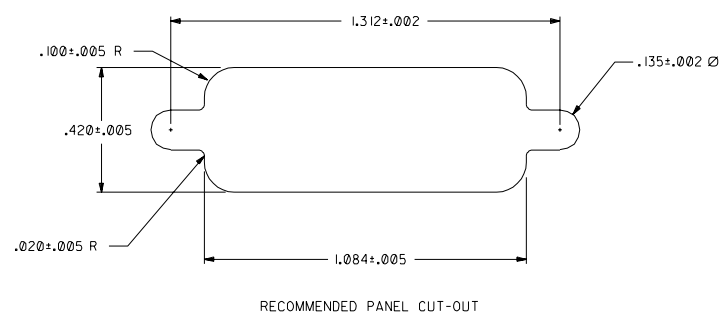
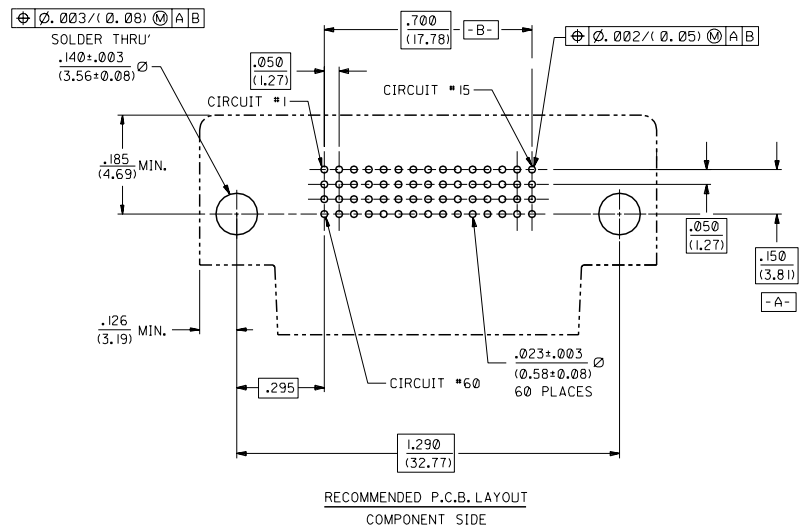

F1	SEE SHEET 1
E	SEE SHEET 1

MFG.	SH.	REV.	LTR.	REVISIONS
DIMENSIONS SHOWN IN METRICS INCH				
UNLESS OTHERWISE SPECIFIED				
TOLERANCES ANGULAR 1/2°				
INCH		METRIC		
3 PLACE	± .001	± .001	± .001	± .001
2 PLACE	± .005	± .005	± .005	± .005
1 PLACE	± .010	± .010	± .010	± .010
DRAFT WHERE APPLICABLE MUST REMAIN WITHIN DIMENSIONS				
DRWG. BY	MOS	CHK'D. BY	CAB	SCALE
APP'D.	CAB	SCALE	4: 1	
FILE NAME		S70929X1A		
SEE SHEET 1		NO DRAWING CONTAINS INFORMATION THAT IS PROPRIETARY TO MOLEX INC. AND SHOULD NOT BE USED WITHOUT WRITTEN PERMISSION.		
PART NO.		MOLEX INCORPORATED		
U.S.A.		68532		
SHEET NO.		DATE		
2		4/15/94		
PART NO.		SDA-70929-0001		
U.S.A.		CD		

13 12 11 10 9 8 7 6 5 4 3 2 1