

DRAWING MADE IN THIRD ANGLE PROJECTION
 THIS DRAWING IS UNPUBLISHED. RELEASED FOR PUBLICATION
 BY AMP INCORPORATED. ALL INTERNATIONAL RIGHTS RESERVED.

LOG	DATE	P	F	ZONE	LTR	DESCRIPTION	DATE	APPD
BD	39	0	✓	0	0	REL WAS 87-4870-16	-	-

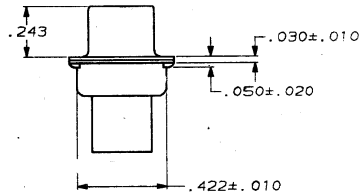
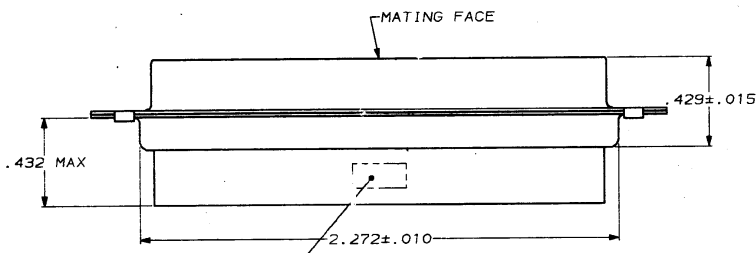
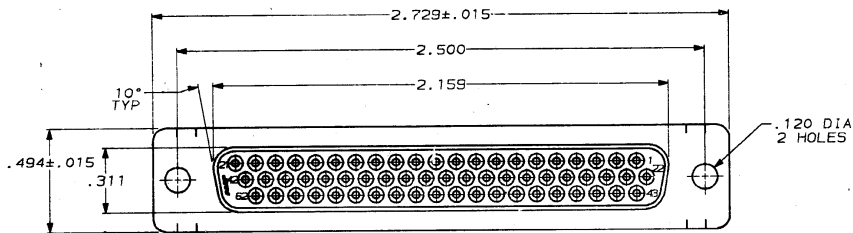

AMP, PART NO & DATE CODE, MARKED IN AREA INDICATED, ON FAR SIDE

- CONNECTOR ACCEPTS SIZE 22 DF SOCKET CONTACTS, RETENTION TINNES ARE AN INTEGRAL PART OF INSERT.
- FLAME RETARDANT 94V-0 RATED GLASS FILLED NYLON, COLOR: BLACK.
- STEEL PER ASTM A109.
- TIN PLATED PER MIL-T-10727.

748568-1

PART NO

DO NOT SCALE PRINT. UNLESS SPECIFIED DIMENSIONS IN INCHES. TOLERANCES ON: 2 PLC DEC ± .005 ANGLES ± 2° MATERIAL MOLDED PARTS: △ SHELLS: △		DR: <i>D. Richard</i> 1/12/88 CHK: <i>W.A. Linder</i> 1/14/88 APPD: <i>D. H. ...</i> 11/14/88 APPO: <i>V. Kumar</i> 1/17/88		AMP INCORPORATED Mansfield, Pa. 17105	
FINISH SHELLS: △		NAME: RECEPTACLE CONNECTOR, SIZE 4, 62 POSN, AMPLIMITE® HDP-22		SIZE: C 00779 DRAWING NO: 748568	
APPLICATION SPEC: -		SCALE: 3:1		SHEET: 1 OF 1	

CUSTOMER DRAWING

748568

1-1971-10 REV 3-87