

4

3

2

1

THIS DRAWING IS UNPUBLISHED. RELEASED FOR PUBLICATION. ALL RIGHTS RESERVED.

LOC	DIST	REVISIONS		
P	LR	DESCRIPTION	DATE	BY
Y		REV PER ECO 11-004686	4-4-11	CT RL

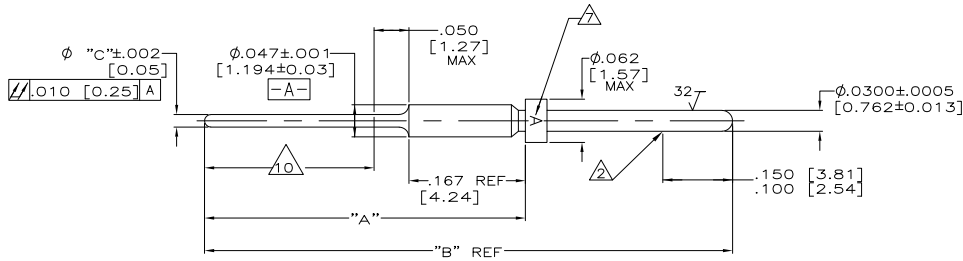

1. INSERTION/EXTRACTION TOOL AMP P/N 91067-1.

Δ POINT OF PLATING THICKNESS MEASUREMENT.

Δ FINISH: .000050 [0.00127] MIN THK GOLD PLATED PER ASTM-B-488, TYPE 3, CODE C, CLASS 1.25 OVER .000100 [0.00254] TO .000150 [0.00381] THK COPPER PER MIL-C-14550, CLASS IV.

Δ FINISH: .000050 [0.00127] MIN THK GOLD PLATED PER ASTM-B-488, TYPE 3, CODE C, CLASS 1.25 OVER .000050 [0.00127] TO .000150 [0.00381] THK NICKEL PER QQ-N-290.

Δ FINISH: .000050 [0.00127] MIN THK GOLD PLATED PER ASTM-B-488, TYPE 3, CODE C, CLASS 1.25 OVER .000200 [0.00508] TO .000250 [0.00635] THK NICKEL PER QQ-N-290.

6. CONTACTS MEET ALL APPLICABLE PERFORMANCE REQUIREMENTS OF MIL-C-39029.

Δ GOTHIC "A" LOCATED APPROX AS SHOWN.

Δ CONTACT BODY MAT'L: LEADED NICKEL COPPER (PROPRIETARY) EQUIVALENT ALTERNATE MAT'L: COPPER ALLOY PER ASTM-B-197

Δ FINISH: .000100 [0.00254] MIN THK GOLD PLATED PER ASTM-B-488, TYPE 3, CODE C, CLASS 1.25 OVER .000050 [0.00127] TO .000150 [0.00381] THK NICKEL PER QQ-N-290.

Δ SOLDER DIP WITH 63/37 TIN-LEAD. MUST MEET SOLDERABILITY REQUIREMENT OF MIL-STD-202, METHOD 208.

Δ	.018 [0.46]	.735 [18.67]	.435 [11.05]	2-207683-7	
PRELIMINARY NOT RELEASED FOR PROD.	Δ	.018 [0.46]	.642 [16.31]	.345 [8.76]	2-207683-3
PRELIMINARY NOT RELEASED FOR PROD.	Δ	.018 [0.46]	.707 [17.96]	.410 [10.41]	2-207683-1
PRELIMINARY NOT RELEASED FOR PROD.	Δ	.018 [0.46]	.707 [17.96]	.410 [10.41]	2-207683-0
Δ	.018 [0.46]	.665 [16.89]	.368 [9.35]	1-207683-8	
PRELIMINARY NOT RELEASED FOR PROD.	Δ Δ	.018 [0.46]	.760 [19.30]	.460 [11.68]	1-207683-4
Δ Δ	.018 [0.46]	.860 [21.84]	.560 [14.22]	1-207683-3	
Δ	.025 [0.64]	.860 [21.84]	.560 [14.22]	1-207683-2	
Δ	.018 [0.46]	.760 [19.30]	.460 [11.68]	1-207683-1	
Δ	.018 [0.46]	1.107 [28.12]	.810 [20.57]	207683-9	
Δ	.025 [0.64]	.860 [21.84]	.560 [14.22]	207683-8	
Δ	.018 [0.46]	.760 [19.30]	.460 [11.68]	207683-6	
Δ	.018 [0.46]	1.107 [28.12]	.810 [20.57]	207683-4	
Δ	.018 [0.46]	.860 [21.84]	.560 [14.22]	207683-2	
FINISH	ϕ "C"	"B"	"A"	PART NO	

THIS DRAWING IS A CONTROLLED DOCUMENT.

DESIGNED BY: T. ALEXANDER	DATE: 11-11-91
OK'D BY: F. KINSEY	DATE: 11-19-91
APPROVED BY: F. KINSEY	DATE: 11-19-91
PRODUCT SPEC: --	APPLICATION SPEC: --
WEIGHT: --	SIZE: A2
MATERIAL: --	CAGE CODE: 00779
FINISH: --	DRAWING NO: C-207683
CUSTOMER DRAWING	

TE Connectivity
PIN CONTACT, POSTED
SIZE 220

SCALE: 10:1 SHEET: 1 of 1 REV: Y