

4

3

2

1

THIS DRAWING IS UNPUBLISHED. RELEASED FOR PUBLICATION.
 © COPYRIGHT BY TYCO ELECTRONICS CORPORATION. ALL RIGHTS RESERVED.

LOC	DIST	REVISIONS					
GP	00	F	LNK	DESCRIPTION	DATE	BY	APPD
		K3		REVISED PER ECO-07-008164	10AUG07	JDP	CWR
		K4		REVISED PER ECO-09-021510	15SEP09	KK	AEQ

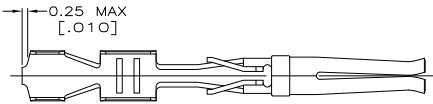

DETAIL Z
SCALE 8:1

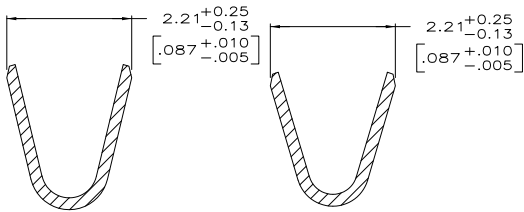
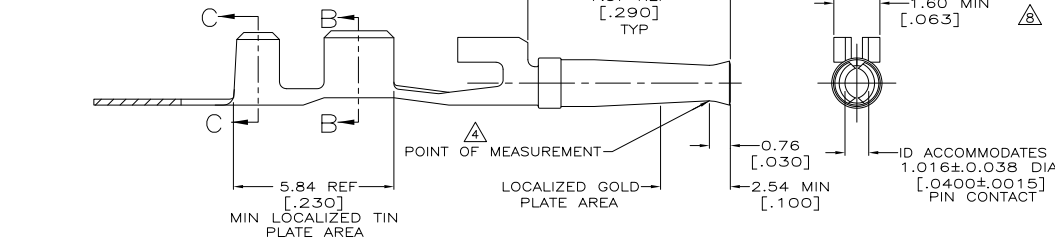
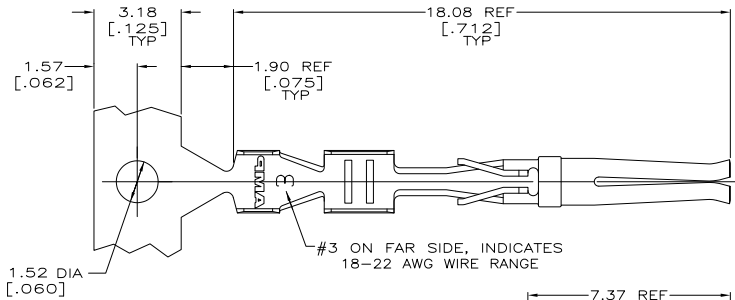

SECTION C-C
SCALE 20:1

SECTION B-B
SCALE 20:1

- △ GOLD PLATING PER MIL-G-45204, TIN PLATING PER MIL-T-10727, NICKEL PLATING PER QQ-N-290.
- △ 0.76 μm [.000030] MIN GOLD IN LOCALIZED GOLD PLATE AREA, 2.54 μm [.000100] MIN BRIGHT TIN OR BRIGHT TIN-LEAD IN MIN LOCALIZED TIN PLATE AREA, ALL OVER 0.76 μm [.000030] MIN NICKEL.
- △ GOLD FLASH IN LOCALIZED GOLD PLATE AREA, 2.54 μm [.000100] MIN BRIGHT TIN OR BRIGHT TIN-LEAD IN MIN LOCALIZED TIN PLATE AREA, ALL OVER 0.76 μm [.000030] MIN NICKEL.
- △ POINT OF MEASUREMENT FOR GOLD AND NICKEL IS ON THE INSIDE SURFACE FOR NOTE △ AND △ ONLY, AND OUTSIDE SURFACE FOR NOTE △ AND △.
- △ GOLD FLASH IN LOCALIZED GOLD PLATE AREA, 2.54 μm [.0001] MIN MATTE TIN IN LOCALIZED TIN PLATE AREA, ALL OVER 0.76 μm [.000030] MIN NICKEL UNDERPLATE.
- △ 0.76 μm [.00030] MIN GOLD IN LOCALIZED GOLD PLATE AREA, 2.54 μm [.0001] MIN MATTE TIN IN LOCALIZED TIN PLATE AREA, ALL OVER 1.27 μm [.000050] MIN NICKEL UNDERPLATE.
- △ PHOSPHOR BRONZE PER QQ-B-750.
- △ OBSOLETE PARTS: OBSOLETE CIS STREAMLINING PER D.RENAUD/D.SINISI

△ OBSOLETE	△	-	1-745270-1
△ OBSOLETE	△	-	1-745270-0
SUPERSEDED BY 745270-2	△	DETAIL Z	745270-9
△ OBSOLETE	△	-	745270-8
SUPERSEDED BY 745270-7	△	DETAIL Z	745270-7
△ OBSOLETE	△	-	745270-6
SUPERSEDED BY 745270-5	△	DETAIL Z	745270-5
SUPERSEDED BY 745270-4	△	-	745270-4
△ OBSOLETE	△	DETAIL Z	745270-3
SUPERSEDED BY 745270-2	△	-	745270-2
FINISH	△	LOOSE PIECE	PART NO

DIMENSIONS		TOLERANCES UNLESS OTHERWISE SPECIFIED		FINISH	
mm	[INCHES]	PLC	PLC	FINISH	SEE TABLE
0	PLC	±	-	SEE TABLE	
1	PLC	±	-		
2	PLC	±	0.13 [005]		
3	PLC	±	-		
4	PLC	±	-		
5	PLC	±	-		
6	PLC	±	-		
7	PLC	±	-		
8	PLC	±	-		
9	PLC	±	-		
10	PLC	±	-		
11	PLC	±	-		
12	PLC	±	-		
13	PLC	±	-		
14	PLC	±	-		
15	PLC	±	-		
16	PLC	±	-		
17	PLC	±	-		
18	PLC	±	-		
19	PLC	±	-		
20	PLC	±	-		
21	PLC	±	-		
22	PLC	±	-		
23	PLC	±	-		
24	PLC	±	-		
25	PLC	±	-		
26	PLC	±	-		
27	PLC	±	-		
28	PLC	±	-		
29	PLC	±	-		
30	PLC	±	-		
31	PLC	±	-		
32	PLC	±	-		
33	PLC	±	-		
34	PLC	±	-		
35	PLC	±	-		
36	PLC	±	-		
37	PLC	±	-		
38	PLC	±	-		
39	PLC	±	-		
40	PLC	±	-		
41	PLC	±	-		
42	PLC	±	-		
43	PLC	±	-		
44	PLC	±	-		
45	PLC	±	-		
46	PLC	±	-		
47	PLC	±	-		
48	PLC	±	-		
49	PLC	±	-		
50	PLC	±	-		
51	PLC	±	-		
52	PLC	±	-		
53	PLC	±	-		
54	PLC	±	-		
55	PLC	±	-		
56	PLC	±	-		
57	PLC	±	-		
58	PLC	±	-		
59	PLC	±	-		
60	PLC	±	-		
61	PLC	±	-		
62	PLC	±	-		
63	PLC	±	-		
64	PLC	±	-		
65	PLC	±	-		
66	PLC	±	-		
67	PLC	±	-		
68	PLC	±	-		
69	PLC	±	-		
70	PLC	±	-		
71	PLC	±	-		
72	PLC	±	-		
73	PLC	±	-		
74	PLC	±	-		
75	PLC	±	-		
76	PLC	±	-		
77	PLC	±	-		
78	PLC	±	-		
79	PLC	±	-		
80	PLC	±	-		
81	PLC	±	-		
82	PLC	±	-		
83	PLC	±	-		
84	PLC	±	-		
85	PLC	±	-		
86	PLC	±	-		
87	PLC	±	-		
88	PLC	±	-		
89	PLC	±	-		
90	PLC	±	-		
91	PLC	±	-		
92	PLC	±	-		
93	PLC	±	-		
94	PLC	±	-		
95	PLC	±	-		
96	PLC	±	-		
97	PLC	±	-		
98	PLC	±	-		
99	PLC	±	-		
100	PLC	±	-		

AMP 1471-9 REV 31MM2000

745270

A