

REV	DATE	DESCRIPTION	BY	CHKD
E	01/26/97	RELEASE PER NPR 23	MS	MS
F	03/20/97	REV PER EC 0320-109-97	ZP	MS
G	04/04/98	REV PER EC 0404-331-98	MS	MS
H	04/04/98	REV PER EC 0404-404-98	MS	MS

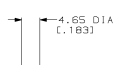
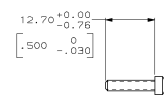
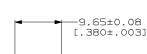
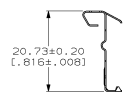
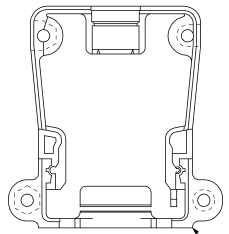
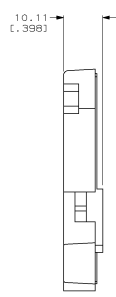

BACKSHELL  
 QTY=2 PER KIT  
 78B089-4

SPRING LATCH  
 QTY=2 PER KIT  
 78B424-1

SCREW, 4-40 UNC  
 QTY=4 PER KIT  
 4-24282-5

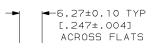
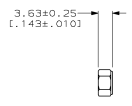

HEX NUT, LOCKING,  
 4-40 UNC  
 QTY=4 PER KIT  
 98B046-2

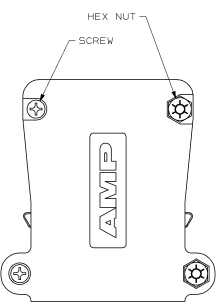
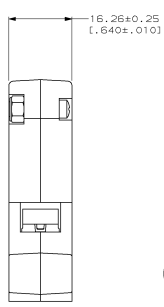
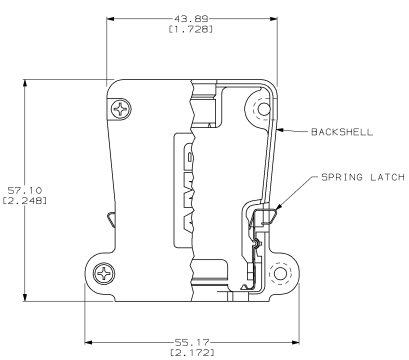
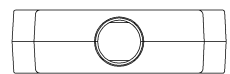

ASSEMBLED VIEWS

- ⚠ BACKSHELL; ABS, NATURAL.
- ⚠ SPRING LATCH; STAINLESS STEEL, HEAT TREATED.
- ⚠ SCREW AND HEX NUT; CARBON STEEL.
- ⚠ BACKSHELL; 4.57µm (0.000180) MIN NICKEL OVER 7.62µm (0.000300) MIN COPPER, ALL OVER 0.25µm (0.000100) MIN ELECTROLESS NICKEL.
- ⚠ SCREW AND HEX NUT; ZINC.
- ⚠ KITS ARE INDIVIDUALLY PACKED.
- ⚠ KITS ARE BULK PACKED.

78B089-2	△
78B089-1	△
PART NUMBER	

THIS DRAWING IS A CONTROLLED DOCUMENT.		DATE	09/01/97	AMP		AMP Incorporated
DESIGNED BY	REVISIONS	BY	STONE	DATE	12/09/97	Harrisburg, PA 17105-3608
DRAWN BY	108-40032-1	DATE	12/09/97	BACKSHELL KIT, UNASSEMBLED, SIZE 1, 180° CABLE EXIT, AMPLIMITE™		
CHKD BY	108-40032-1	DATE		REV	000000	78B089
APP'D BY		DATE		REV	000000	78B089
DATE		DATE		REV	000000	78B089
CUSTOMER DRAWING	A1	00779				