

# TECHNICAL DATA

'' D '' SUBMINIATURE CONNECTORS

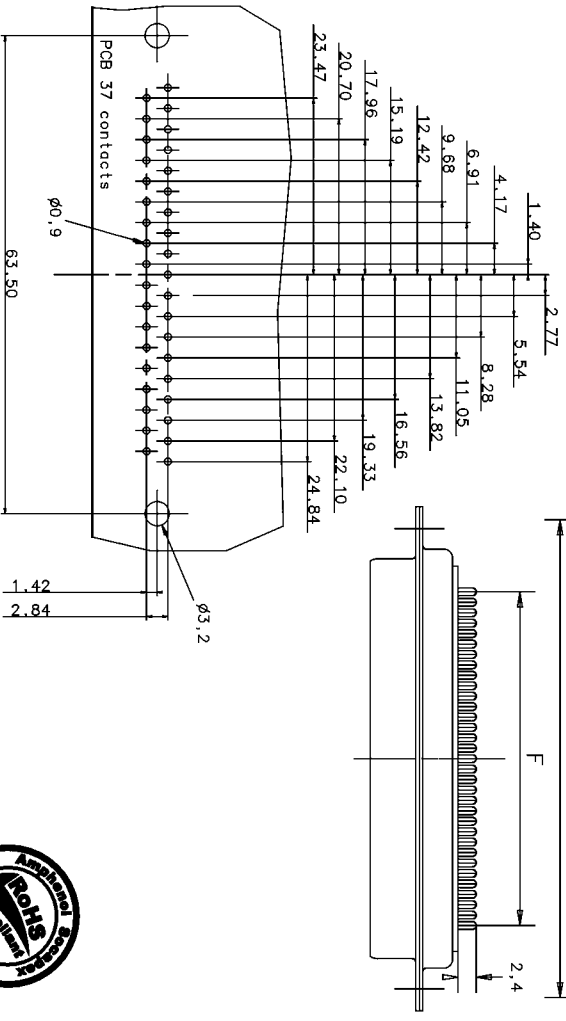
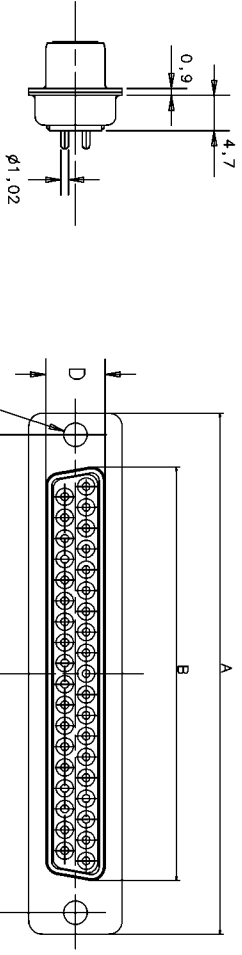
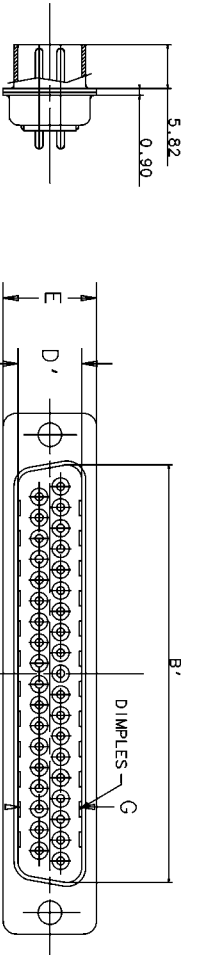

SHELL : Steel.

BODY : Glass filled thermoplastic.  
Flame retardant to UL 94 V-0.  
Colour : Black.

CONTACTS : Material for sockets : bronze.  
Material for pins : brass.  
Finish of contact mating area : Gold over Nickel.

ELECTRICAL : Voltage rating 300 V eff at 50Hz.  
Nominal current 7,5 A.  
Contact resistance <math>< 8,5m\ \Omega</math>.  
Insulation resistance >5000 M Ohms.

CLIMATIC : Temperature range -55°C up to +85°C  
Damp heat 21 days (40°C - 95% RH)  
Other climatic specifications in accordance with NF C 93-425

MECHANICAL : Mating and unmating force size

E	30 N max.	3,5 N mini.
A	50 N max.	4,4 N mini.
B	83 N max.	8,0 N mini.
C	123 N max.	11,0 N mini.
D	166 N max.	14,5 N mini.

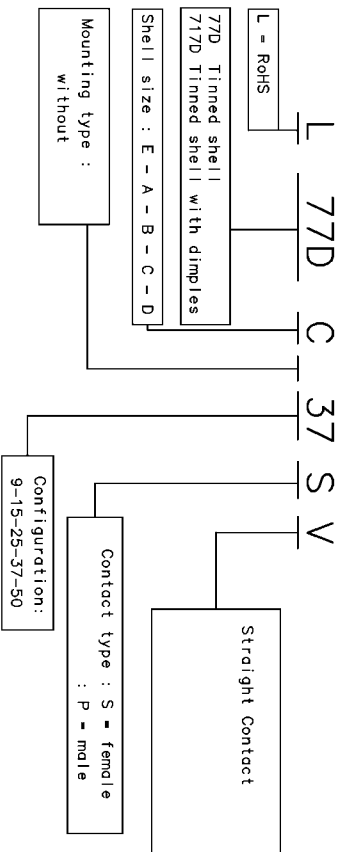

Foille feuille	A	B'	B	C	D'	D	E	F ±0,05	Pqs	G	*
E	30,43	16,41	17,94	25,12	9,93	8,48	12,93	10,98	2,74	7,62	2x3
A	39,52	24,79	25,32	33,20	9,93	8,48	12,93	19,20	2,74	7,62	2x5
B	53,45	38,25	39,09	46,91	9,93	8,48	12,93	33,12	2,76	7,62	2x8
C	68,94	54,97	55,30	63,37	9,93	8,48	12,93	49,68	2,76	7,62	2x12
D	86,31	82,30	82,88	80,29	10,82	10,33	14,25	44,20	2,76	10,5	2x12

IND. 1 MODIFICATION	DATE	Execut	Approuv
IND. 2 MODIFICATION	DATE	Execut	Approuv
IND. 3 MODIFICATION	DATE	Execut	Approuv
IND. 4 MODIFICATION	DATE	Execut	Approuv
IND. 5 MODIFICATION	DATE	Execut	Approuv
IND. 6 MODIFICATION	DATE	Execut	Approuv
IND. 7 MODIFICATION	DATE	Execut	Approuv
IND. 8 MODIFICATION	DATE	Execut	Approuv
IND. 9 MODIFICATION	DATE	Execut	Approuv
IND. 10 MODIFICATION	DATE	Execut	Approuv
IND. 11 MODIFICATION	DATE	Execut	Approuv
IND. 12 MODIFICATION	DATE	Execut	Approuv
IND. 13 MODIFICATION	DATE	Execut	Approuv
IND. 14 MODIFICATION	DATE	Execut	Approuv
IND. 15 MODIFICATION	DATE	Execut	Approuv
IND. 16 MODIFICATION	DATE	Execut	Approuv
IND. 17 MODIFICATION	DATE	Execut	Approuv
IND. 18 MODIFICATION	DATE	Execut	Approuv
IND. 19 MODIFICATION	DATE	Execut	Approuv
IND. 20 MODIFICATION	DATE	Execut	Approuv
IND. 21 MODIFICATION	DATE	Execut	Approuv
IND. 22 MODIFICATION	DATE	Execut	Approuv
IND. 23 MODIFICATION	DATE	Execut	Approuv
IND. 24 MODIFICATION	DATE	Execut	Approuv
IND. 25 MODIFICATION	DATE	Execut	Approuv
IND. 26 MODIFICATION	DATE	Execut	Approuv
IND. 27 MODIFICATION	DATE	Execut	Approuv
IND. 28 MODIFICATION	DATE	Execut	Approuv
IND. 29 MODIFICATION	DATE	Execut	Approuv
IND. 30 MODIFICATION	DATE	Execut	Approuv
IND. 31 MODIFICATION	DATE	Execut	Approuv
IND. 32 MODIFICATION	DATE	Execut	Approuv
IND. 33 MODIFICATION	DATE	Execut	Approuv
IND. 34 MODIFICATION	DATE	Execut	Approuv
IND. 35 MODIFICATION	DATE	Execut	Approuv
IND. 36 MODIFICATION	DATE	Execut	Approuv
IND. 37 MODIFICATION	DATE	Execut	Approuv
IND. 38 MODIFICATION	DATE	Execut	Approuv
IND. 39 MODIFICATION	DATE	Execut	Approuv
IND. 40 MODIFICATION	DATE	Execut	Approuv
IND. 41 MODIFICATION	DATE	Execut	Approuv
IND. 42 MODIFICATION	DATE	Execut	Approuv
IND. 43 MODIFICATION	DATE	Execut	Approuv
IND. 44 MODIFICATION	DATE	Execut	Approuv
IND. 45 MODIFICATION	DATE	Execut	Approuv
IND. 46 MODIFICATION	DATE	Execut	Approuv
IND. 47 MODIFICATION	DATE	Execut	Approuv
IND. 48 MODIFICATION	DATE	Execut	Approuv
IND. 49 MODIFICATION	DATE	Execut	Approuv
IND. 50 MODIFICATION	DATE	Execut	Approuv
IND. 51 MODIFICATION	DATE	Execut	Approuv
IND. 52 MODIFICATION	DATE	Execut	Approuv
IND. 53 MODIFICATION	DATE	Execut	Approuv
IND. 54 MODIFICATION	DATE	Execut	Approuv
IND. 55 MODIFICATION	DATE	Execut	Approuv
IND. 56 MODIFICATION	DATE	Execut	Approuv
IND. 57 MODIFICATION	DATE	Execut	Approuv
IND. 58 MODIFICATION	DATE	Execut	Approuv
IND. 59 MODIFICATION	DATE	Execut	Approuv
IND. 60 MODIFICATION	DATE	Execut	Approuv
IND. 61 MODIFICATION	DATE	Execut	Approuv
IND. 62 MODIFICATION	DATE	Execut	Approuv
IND. 63 MODIFICATION	DATE	Execut	Approuv
IND. 64 MODIFICATION	DATE	Execut	Approuv
IND. 65 MODIFICATION	DATE	Execut	Approuv
IND. 66 MODIFICATION	DATE	Execut	Approuv
IND. 67 MODIFICATION	DATE	Execut	Approuv
IND. 68 MODIFICATION	DATE	Execut	Approuv
IND. 69 MODIFICATION	DATE	Execut	Approuv
IND. 70 MODIFICATION	DATE	Execut	Approuv
IND. 71 MODIFICATION	DATE	Execut	Approuv
IND. 72 MODIFICATION	DATE	Execut	Approuv
IND. 73 MODIFICATION	DATE	Execut	Approuv
IND. 74 MODIFICATION	DATE	Execut	Approuv
IND. 75 MODIFICATION	DATE	Execut	Approuv
IND. 76 MODIFICATION	DATE	Execut	Approuv
IND. 77 MODIFICATION	DATE	Execut	Approuv
IND. 78 MODIFICATION	DATE	Execut	Approuv
IND. 79 MODIFICATION	DATE	Execut	Approuv
IND. 80 MODIFICATION	DATE	Execut	Approuv
IND. 81 MODIFICATION	DATE	Execut	Approuv
IND. 82 MODIFICATION	DATE	Execut	Approuv
IND. 83 MODIFICATION	DATE	Execut	Approuv
IND. 84 MODIFICATION	DATE	Execut	Approuv
IND. 85 MODIFICATION	DATE	Execut	Approuv
IND. 86 MODIFICATION	DATE	Execut	Approuv
IND. 87 MODIFICATION	DATE	Execut	Approuv
IND. 88 MODIFICATION	DATE	Execut	Approuv
IND. 89 MODIFICATION	DATE	Execut	Approuv
IND. 90 MODIFICATION	DATE	Execut	Approuv
IND. 91 MODIFICATION	DATE	Execut	Approuv
IND. 92 MODIFICATION	DATE	Execut	Approuv
IND. 93 MODIFICATION	DATE	Execut	Approuv
IND. 94 MODIFICATION	DATE	Execut	Approuv
IND. 95 MODIFICATION	DATE	Execut	Approuv
IND. 96 MODIFICATION	DATE	Execut	Approuv
IND. 97 MODIFICATION	DATE	Execut	Approuv
IND. 98 MODIFICATION	DATE	Execut	Approuv
IND. 99 MODIFICATION	DATE	Execut	Approuv
IND. 100 MODIFICATION	DATE	Execut	Approuv

017F

DESIGNATION

L \*\* 7D \*\* \*\* V

Amphenol Socapex  
Usine de Dole



COMMUNICATION ET UTILISATION INTERDITES SAUF AUTORISATION