

DESCRIPTION: .370" STAMPED MALE R/A D-SUB CONNECTOR

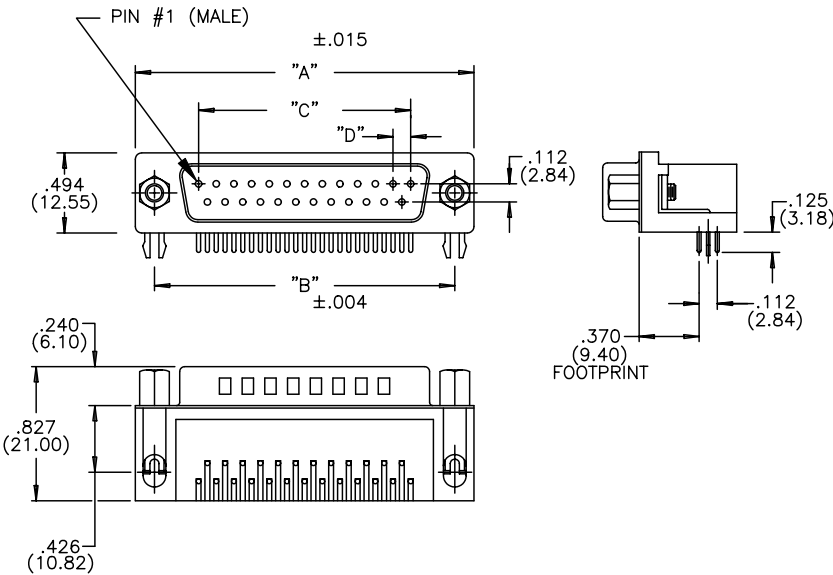

MATERIALS:

INSULATOR: NYLON 9T, UL94V-0, 260°C PROCESS TEMP  
CHEMICAL RESISTANCE, COLOR BLACK

SHELL: STEEL, NICKEL PLATED

CONTACT: MALE: BRASS; FEMALE: PHOSPHOR BRONZE

GOLD FLASH - MATING AREA

TIN PLATING ON TAIL ENDS

RoHS COMPLIANT

ELECTRICAL:

CURRENT RATING: 5 AMPERES

DIELECTRIC WITHSTANDING VOLTAGE: 1000VAC rms AT SEA LEVEL

INSULATION RESISTANCE: 5000 MEGOHMS MIN.

CONTACT RESISTANCE: 10 MILLIOHMS MAX.

WORKING TEMPERATURE: -55° TO +125° C

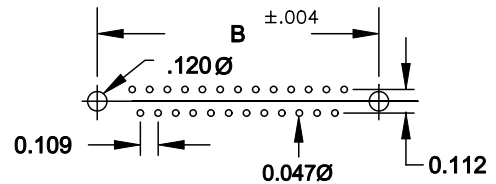

(9, 15, 25, 37 POSITIONS)

NUMBER OF CONTACTS	"A" Inch (mm)	"B" Inch (mm)	"C" Inch (mm)	"D" Inch (mm)
9	1.214 (30.84)	.984 (24.99)	.432 (10.97)	.109 (2.76)
15	1.545 (39.24)	1.312 (33.32)	.756 (19.20)	.109 (2.76)
25	2.088 (53.04)	1.852 (47.04)	1.304 (33.12)	.109 (2.76)
37	2.730 (69.34)	2.500 (63.50)	1.956 (49.68)	.109 (2.76)

192-025-Y13RYY1

SERIES \_\_\_\_\_  
NUMBER OF CONTACTS \_\_\_\_\_  
GENDER \_\_\_\_\_  
1 = MALE  
2 = FEMALE (NO GROUND INDENTS)  
PC MOUNT \_\_\_\_\_  
3 = NICKEL SHELL \_\_\_\_\_

HARDWARE OPTIONS:  
16 = .120 MATING HOLE WITH INSIDE GROUND STRAP  
17 = 4-40 INSERT WITH INSIDE GROUND STRAP  
18 = 4-40 STANDOFF WITH INSIDE GROUND STRAP  
53 = 4-40 INSERT WITH FORK BOARD LOCKS  
56 = 4-40 STANDOFF WITH FORK BOARD LOCKS

PLATING:  
1 = GOLD FLASH



THESE DRAWINGS AND SPECIFICATIONS ARE THE PROPERTY OF NorComp AND SHALL NOT BE REPRODUCED, COPIED OR USED AS THE BASIS FOR THE MANUFACTURE OF SALE OF APPARATUS WITHOUT WRITTEN PERMISSION.

DRAWN: PAM JENKINS DATE: 9-15-05

CHECKED: DATE:

**NorComp**

SCALE: SHEET 1 OF 1 REV 2

DWG NO. 192-YYY-113RYY1