

4

3

2

1

THIS DRAWING IS UNPUBLISHED. RELEASED FOR PUBLICATION
 BY TYCO ELECTRONICS CORPORATION. ALL RIGHTS RESERVED.

LOC	DIST	REVISIONS					
GP	00	P	LTR	DESCRIPTION	DATE	MIN	APD
		J		REVISED PER ECO-06-028334	11/DEC/06	ZMR	EDB

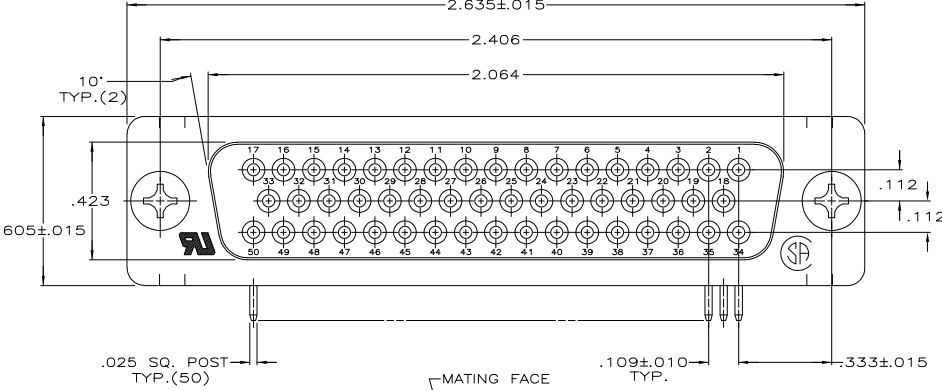

- 1. CONNECTOR MATES WITH ANY 50 POS. PLUG IN AMPLIMITE SERIES & COMPLIES WITH AMP SPEC. 108-40,005 WHERE APPLICABLE.
- △ MOLDED PARTS: FLAME RETARDANT 94V-0 RATED THERMOPLASTIC; COLOR, BLACK. SHELLS AND BRACKETS: STEEL. CONTACTS: PHOS. BRONZE.
- △ .000200 MIN TIN OR TIN-LEAD OVER .000100 MIN COPPER.
- △ GOLD PLATED FOR A LENGTH OF .100 MIN FROM MATING END, .000100 MIN TIN-LEAD ON OPPOSITE END, ALL OVER .000050 MIN NICKEL.
- △ .000030 MIN GOLD FOR A LENGTH OF .100 MIN FROM MATING END, .000100 MIN TIN-LEAD ON OPPOSITE END, ALL OVER .000050 MIN NICKEL. -OR- GOLD FLASH OVER .000030 MIN PALLADIUM NICKEL PLATED FOR LENGTH OF .100 MIN FROM MATING END, .000100 MIN TIN-LEAD ON OPPOSITE END, ALL OVER .000050 NICKEL.

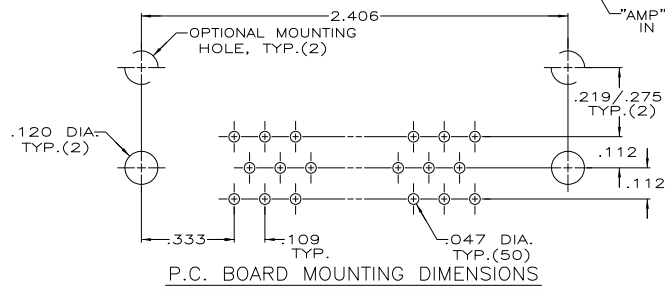
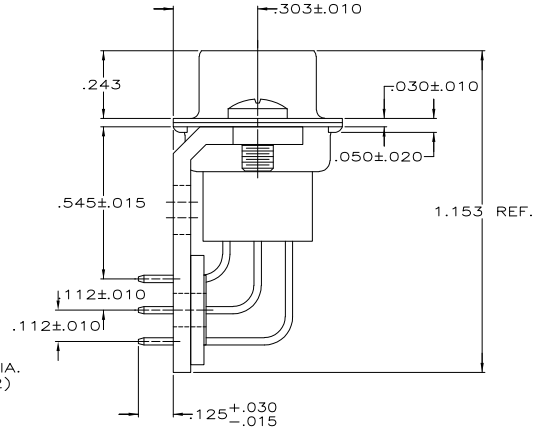
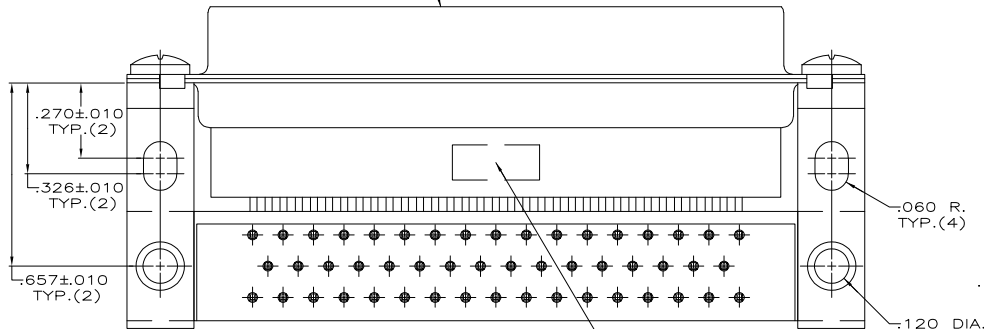

OBSOLETE	△	745116-2
	△	745116-1
		PART NUMBER

THIS DRAWING IS A CONTROLLED DOCUMENT.		DIM J. GERACE 12-19-83 OK S. WEIGARD 12-19-83 APD J. ASSINI 3-15-84 PRODUCT SPEC. NAME APPLICATION SPEC. WEIGHT FINISH SHELLS & BRACKETS: △ CONTACTS: SEE TABLE	Tyco Electronics Tyco Electronics Corporation Harrisburg, PA 17105-3608	RECEPTICLE ASSY, SIZE 5, 50 POS. RIGHT ANGLE, .545 SERIES, .025 SQ. POSTS, AMPLIMITE HDP	SIZE A2 QTY CODE 00779 DRAWING NO. C=745116 RESTRICTED TO SCALE SHEET 1 of 1 REV J
--	--	---	--	--	--

AMP 1471-9 REV 31MM2000

745116

A