

**Toggle Switches, Process Sealed, Vertical and Right Angle, Round Actuator**

**MATERIAL SPECIFICATIONS:**

Contacts .....Gold over nickel plate  
 Case Material .....Polyester 94V-0  
 Actuator Material .....Nickel plated copper alloy  
 Terminals .....Phosphor bronze  
 Terminal Seal .....Epoxy  
 Process Seal .....Tested to MIL-STD-202, method 112  
 (Internal O-Ring) test condition A and D, 85°C

**TYPICAL PERFORMANCE CHARACTERISTICS:**

Contact Rating .....0.4 VA Max. @ 20 VDC  
 Initial Contact Resistance .....100 Milliohms max.  
 Contact Timing .....Break-before-make  
 Insulation Resistance .....500 Megohms @ 250 VDC min.  
 Dielectric Strength .....500 Volts RMS @ sea level  
 Actuation Force .....400 Grams  
 Life Expectancy .....Up to 10,000 Cycles

**ENVIRONMENTAL SPECIFICATIONS**

Operating Temperature.....-4°F to +176°F (-20°C to +80°C)  
 Storage Temperature.....-40°F to +176°F (-40°C to +80°C)

**4PDT**



ATE4DGPC2

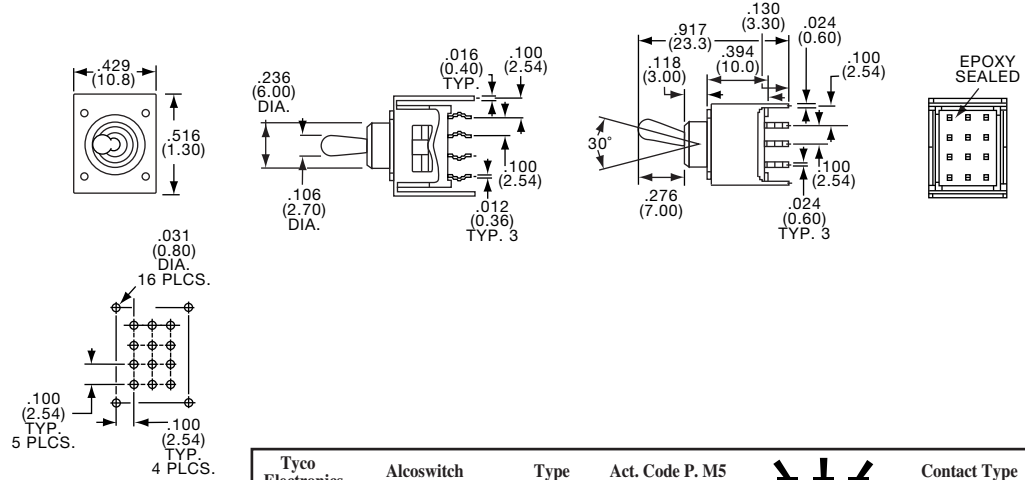

| Tyco Electronics | Alcoswitch | Type | Act. Code P. M5 | Contact Type    |
|------------------|------------|------|-----------------|-----------------|
| 2-1437557-1      | ATE4DGPC2  | 4PDT | 8               | On None On Gold |

**4PDT**

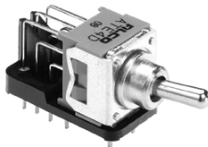

ATE4DGRA2

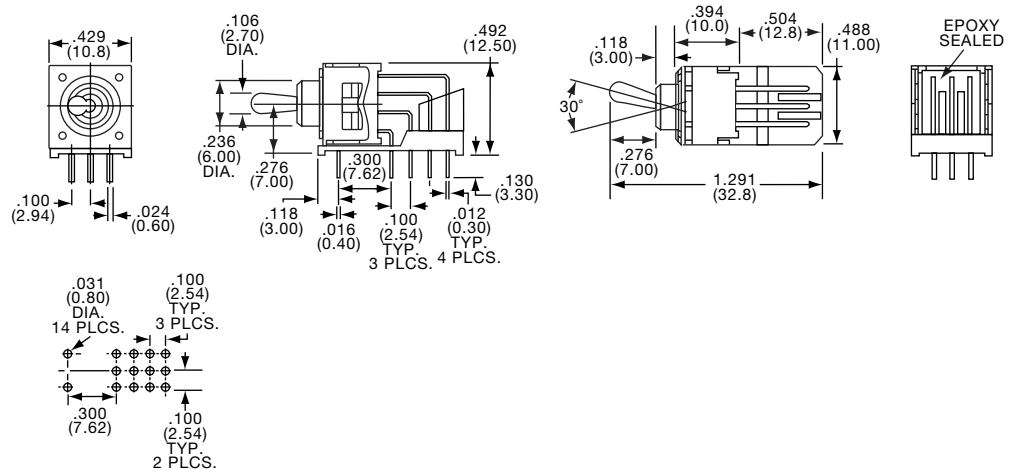

| Tyco Electronics | Alcoswitch | Type | Act. Code P. M5 | Contact Type    |
|------------------|------------|------|-----------------|-----------------|
| 2-1437557-2      | ATE4DGRA2  | 4PDT | 8               | On None On Gold |

**Toggle Switches, Process Sealed, Vertical, Round or Flat Actuators**

SEE PAGE C19 FOR PRODUCT SPECIFICATIONS

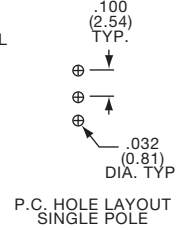
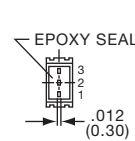
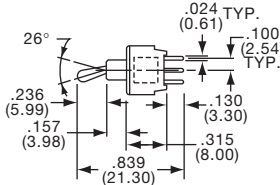
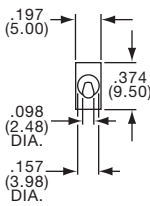

SPDT/DPDT



ATE1DGPC1

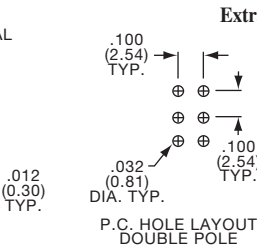
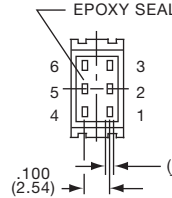
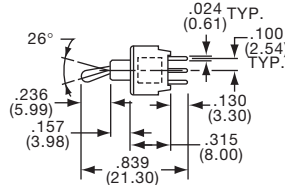
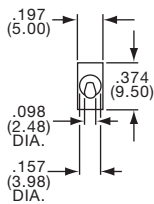

Extra compact double pole saves PCB real estate.



ATE2DGP1

| Tyco Electronics | Alcoswitch | Type | On                                 | None      | On      | Contact Type | Tyco Electronics     | Alcoswitch | Type | On  | None | On  | Contact Type |
|------------------|------------|------|------------------------------------|-----------|---------|--------------|----------------------|------------|------|-----|------|-----|--------------|
| 1437557-2        | ATE1DGPC1  | SPDT | On                                 | None      | On      | Gold         | 1-1437557-5          | ATE2DGP1   | DPDT | On  | None | On  | Gold         |
| 1437557-6        | ATE1EGPC1  | SPDT | On                                 | Off       | On      | Gold         | 1-1437557-9          | ATE2EGPC1  | DPDT | On  | Off  | On  | Gold         |
| 1-1437557-2      | ATE1GGPC1  | SPDT | On (On)                            | None (On) | On (On) | Gold         | Terminals Connected: |            |      |     |      |     |              |
|                  |            |      | 2-3                                |           | 2-1     |              |                      |            |      | 5-6 |      | 5-4 |              |
|                  |            |      | (On) indicates momentary position. |           |         |              |                      |            |      |     |      |     |              |

SPDT/DPDT

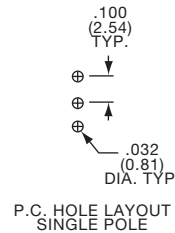
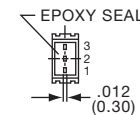
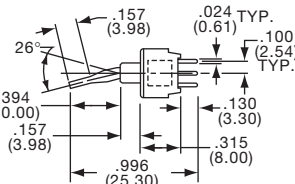
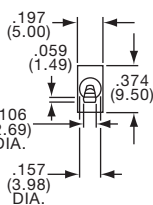

ATE1DGP7

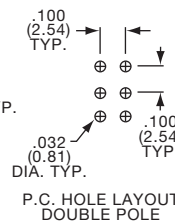
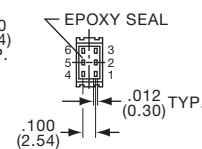
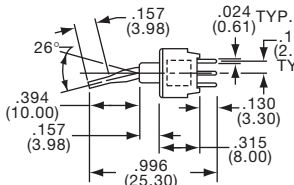
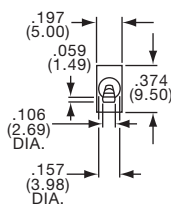

Extra compact double pole saves PCB real estate.



ATE2DGP7

| Tyco Electronics | Alcoswitch | Type | On                                 | None     | On      | Contact Type | Tyco Electronics     | Alcoswitch | Type | On  | None | On  | Contact Type |
|------------------|------------|------|------------------------------------|----------|---------|--------------|----------------------|------------|------|-----|------|-----|--------------|
| 1437557-3        | ATE1DGP7   | SPDT | On                                 | None     | On      | Gold         | 1-1437557-6          | ATE2DGP7   | DPDT | On  | None | On  | Gold         |
| 1-1437557-3      | ATE1GGPC7  | SPDT | On (On)                            | Off (On) | On (On) | Gold         | Terminals Connected: |            |      |     |      |     |              |
|                  |            |      | 2-3                                |          | 2-1     |              |                      |            |      | 5-6 |      | 5-4 |              |
|                  |            |      | (On) indicates momentary position. |          |         |              |                      |            |      |     |      |     |              |

