

CIRCUIT: SPDT

| SWITCH FUNCTION | | |
|-----------------|--------|--------|
| POS. 1 | POS. 2 | POS. 3 |
| DN | NONE | DN |
| 2-3 | DPEN | 2-1 |

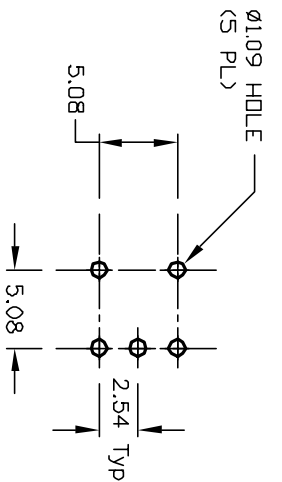

RECOMMENDED P.C.B LAYOUT

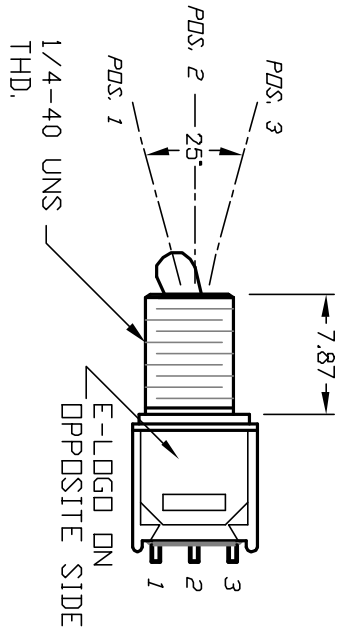
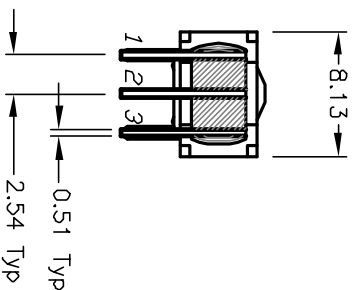
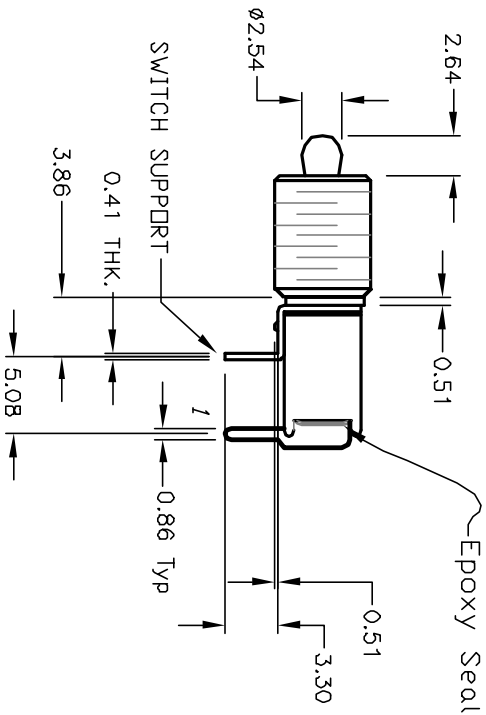
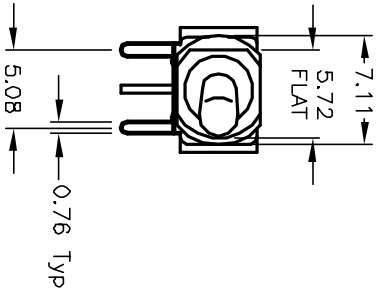

NOTES:

1. ALL DIMENSIONS IN MM
2. GENERAL TOLERANCE: X.X=±0.4 X.XX=±0.25
3. TERM. NOS. FOR REF. ONLY
4. CONTACT RATING: 0.4VA max. @20VAC or 28VDCmax.
5. FIXED TERMINAL & MOVING CONTACT: Copper Alloy w/GOLD plate over Nickel plate.
6. ELECTRIC LIFE: 30,000 make-and-break cycles at full load.
7. INSULATION RESISTANCE: 1,000 M ohm min.
8. DIELECTRIC STRENGTH: 1,000 V RMS @sea level.
9. OPERATING TEMP.: -30°C to 85°C

| REV. | ECN No. | DESCRIPTION | DATE | CHKD |
|------|---------|-------------------------|--------|------|
| A | 12208 | RELEASED FOR PRODUCTION | 6/5/02 | CJB |

| TITLE | SCALE | DATE | DR | DWG | REV |
|--|-------|--------|-----|---------|-----|
| 200 MSP-1 T2 B5 M6 R E (GOLD CONTACTS) | 2:1 | 6/5/02 | CJB | T211256 | A |

E-SWITCH®

THE INFORMATION CONTAINED IN THIS DOCUMENT IS PROPRIETARY TO E-SWITCH AND IS NOT TO BE COPIED OR TRANSMITTED