

# ST series

## Miniature toggle switches

Distinctive features and specifications

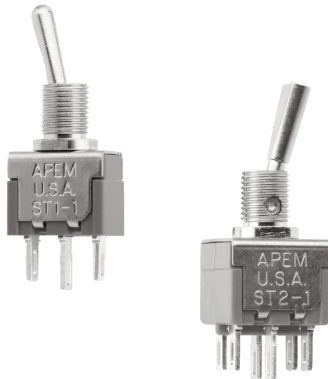

- Dry circuit through power ratings.
- Ultra-rugged construction SPDT & DPDT models with numerous options.
- PC and panel mount models.

### ELECTRICAL SPECIFICATIONS

- Max. current/voltage rating with resistive load :
  - gold over nickel plated brass contacts : 0.4VA - 20V Max.
  - coin silver contacts: 6A 125VAC, 3A 250VAC, 7A 30VDC
- Initial contact resistance: 3 milliohms max. at 3VDC, 0.1 Amp.
- Insulation resistance: 2,000 M $\Omega$  min. between terminals & case ground.
- Dielectric strength: 2,000 VAC for 1 minute between terminals & case ground.
- Electrical life: 100,000 cycles at full load for ST1-1 and ST2-1, all other models 40,000 cycles

### MATERIALS

- Case : Diallylphthalate (DAP), color blue
- Actuator : Brass, bright nickel or chrome plated.
- Bushing: nickel plated brass
- Strap: stainless steel
- Contacts
  - B: Gold
  - Q: Coin silver
  - G: Gold over silver
- Terminal seal: epoxy

### GENERAL SPECIFICATIONS

- Operating temperature : -30°C to +85°C

### AGENCY APPROVAL



**Availability:** All models with coin silver contacts (Q) only.

**Marking:** To order switches marked UL use "UL" prefix for series designation. For CSA marking, complete appropriate box on ordering format.

# ST series

## Miniature toggle switches

Overview

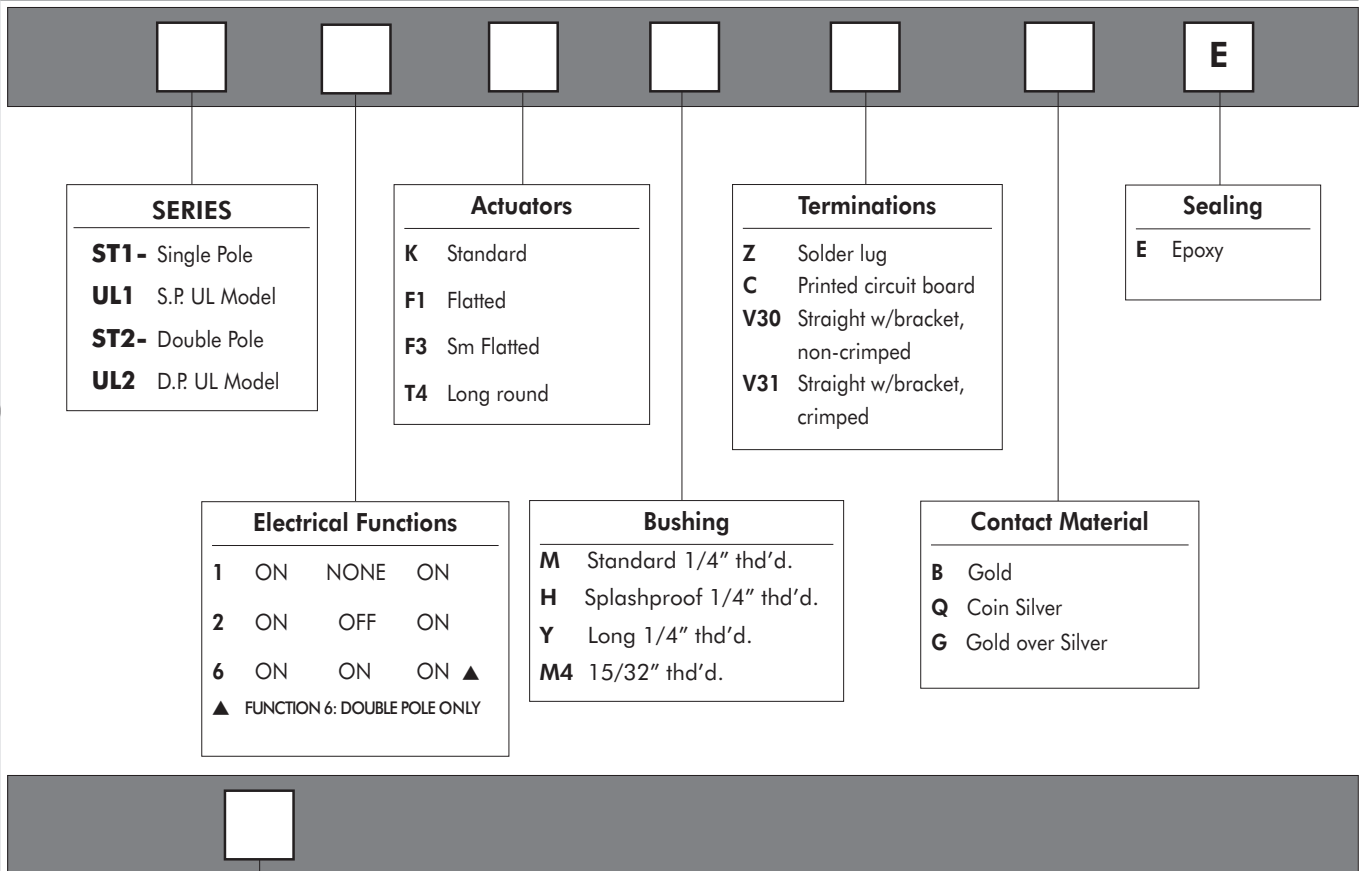

**Agency approval**

---

**No approval**

/CSA    **CSA Approval**  
(Q contact material only)

**Note: for UL, Select UL1 or UL2 series above**

### ABOUT THIS SERIES

On the following pages, you will find successively :

- model structure of switches
- options in the same order as in above chart

**Dimensions** : first dimensions are in mm while inches are shown as bracketed numbers.



**Sealing boots** are available to protect the switches against dust and water. They are presented in section H



**Mounting accessories** : standard hardware supplied with all models with Ø 6,35 (1/4) threaded bushing : 2 - 5/16" hex nuts , 1 locking ring and 1 lockwasher.  
Standard and special hardware available are presented in section I.



**Packaging unit** : 25 pieces for double pole  
50 pieces for single pole



**NOTICE** : please note that not all combinations of above numbers are available. Refer to the following pages for further information.





# ST series

## Miniature toggle switches

### Double pole panel mount with splashproof bushing → "D" flat



MODEL NO.	UL NO.	I	II	III
<b>ST2-1KHZQE</b>	<b>UL21KHZQE</b>	1-2	1-2	2-3
<b>ST2-2KHZQE</b>	<b>UL22KHZQE</b>	4-5	5-6	5-6
<b>ST2-6KHZQE</b>	<b>UL26KHZQE</b>	ON	-	ON
		ON	OFF	ON
		ON	ON	ON

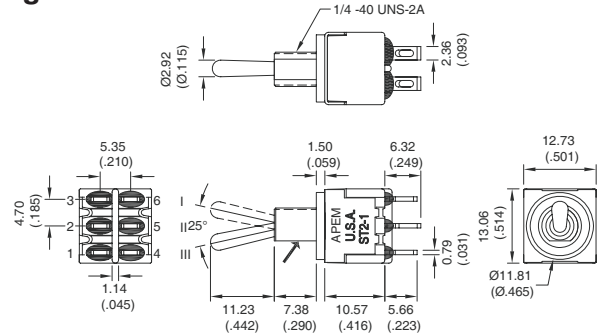

### Actuator

**F1**

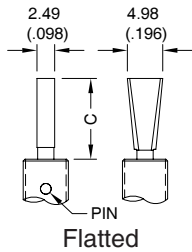

**F3**

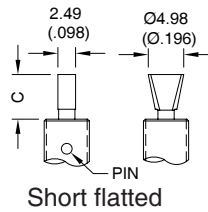

**K**

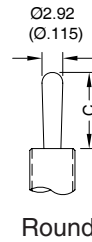

**T4**

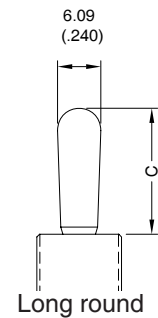

### Bushing options

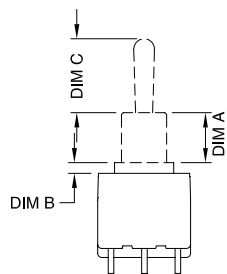
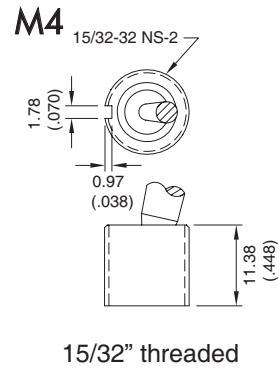
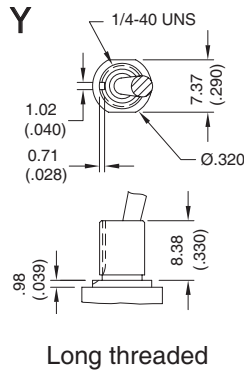
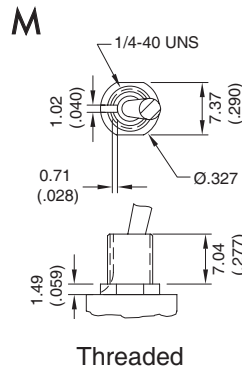
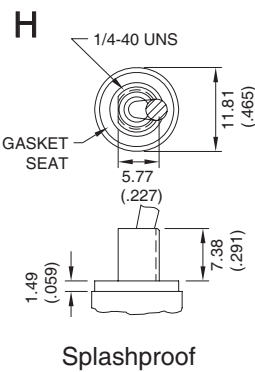

Bushing Option	Bushing Dims.		Actuator length Dim C			
	Dim A	Dim B	F1	F3	K	T4
H	7.37 (.290)	1.52 (.060)	N/A	N/A	10.41 (.410)	N/A
M	7.04 (.277)	1.52 (.060)	11.43 (.450)	6.35 (.250)	10.41 (.410)	N/A
Y	8.38 (.330)	1.02 (.040)	N/A	N/A	10.41 (.410)	N/A
M4	11.38 (.448)	-	N/A	N/A	N/A	17.45 (.687)

# ST series

## Miniature toggle switches

### V30 bracket option

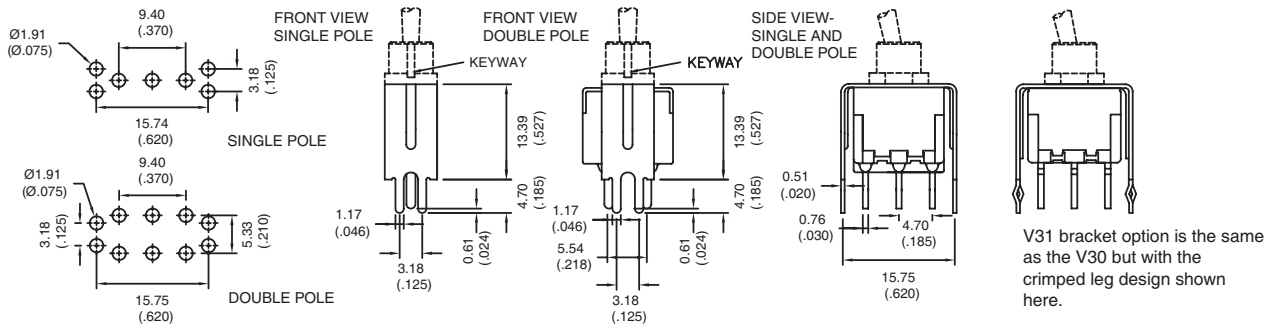

### Panel cut-outs

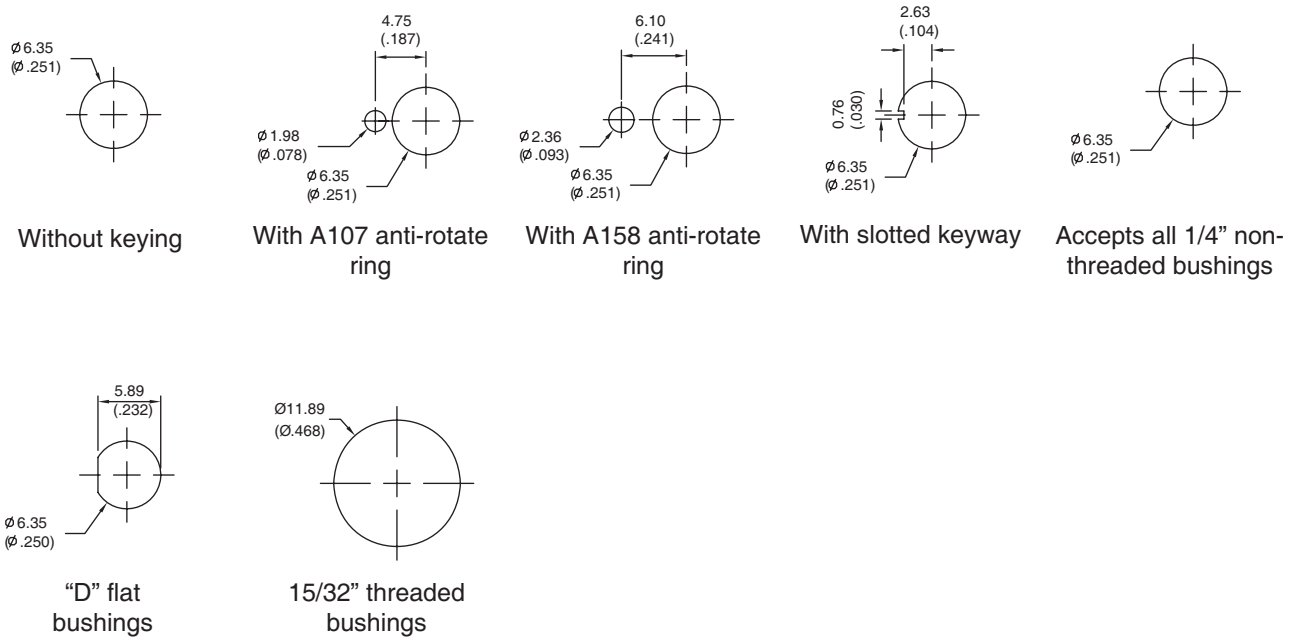

### Hardware

Anti-rotate ring A107  
Nickel plated brass

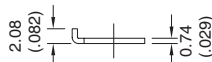
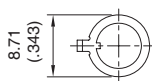

5/16" Hex nut A112  
Nickel plated brass 1/4-40

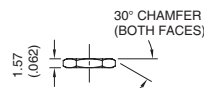
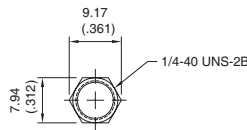

Anti-rotate ring A158  
Nickel plated brass

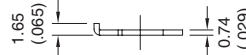
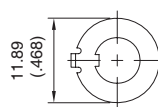

9/16" Hex nut A465  
Nickel plated brass 15/32-32

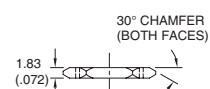
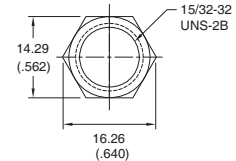

# ST series

## Miniature toggle switches

---

### Contact material specs.

---

- B** Dry circuit - gold over nickel over brass.  
RATING: 0.4 Volt-Amps (VA) max. at 20 V max.  
ELECTRIC LIFE: 100,000 cycles min. (ST1-1 & ST2-1 only - other models 40,000 cycles min.)
- Q** Power circuit - coin silver.  
RATING: 6 Amps at 125 VAC, 3 Amps at 250 VAC or 7 Amps at 30 VDC (resistive loads).  
ELECTRIC LIFE: 100,000 cycles min. (ST1-1 & ST2-1 only - other models 40,000 cycles min.)
- G** Dry circuit or power circuit - gold over nickel over coin silver.  
RATINGS & ELECTRIC LIFE: Same as B & Q above - i.e. - can be used in either dry circuit or power circuit, however once used in power circuit, switch cannot be re-used in dry circuit. This option satisfies those customers who have both dry circuit and power circuit requirements, but prefer to inventory only one switch for both.

---

### UL & CSA options

---



- UL** For power circuits - coin silver  
RATING: 6 Amps at 125 VAC or 3 Amps at 250 VAC (75% power factor).  
Underwriter Laboratories file no. E66367. Note - applicable only to terminations with coin silver contacts (Q option).
- CSA** For power circuits - coin silver  
RATING: 6 Amps at 125 VAC or 3 Amps at 250 VAC (75% power factor). Canadian Standards Association file no. LR54592-1. Note - applicable only to terminations with coin silver contacts (Q option) as CSA recognizes switches for power applications only.  
Note- Double pole switches with solder lug terminals are not CSA recognized .