

RECOMMENDED P.C.B. LAYOUT

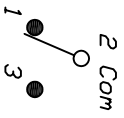

CIRCUIT: SPDT CONTACT CONFIGURATION

| SWITCH FUNCTION |        |        |
|-----------------|--------|--------|
| PDS. 1          | PDS. 2 | PDS. 3 |
| DN              | OFF    | DN     |
| 2-3             | OPEN   | 2-1    |

NOTES:

1. ALL DIMENSIONS IN MM [INCH]
2. GENERAL TOLERANCE: X.X=±0.4 X.XX=±0.25
3. TERM. NOS. FOR REF. ONLY
4. RATING: 0.4(YA) Max. @20V (AC or DC)
5. FIXED TERM. & MOVING CONTACT: Copper Alloy W/Gold plate over Ni Plate
6. ELECTRICAL LIFE: 50,000 make-and-break cycles at full load.
7. INSULATION RESISTANCE: 1,000M ohm min.
8. DIELECTRIC STRENGTH: 1,000V RMS @sea level.
9. OPERATING TEMP.: -30°C to 85°C.

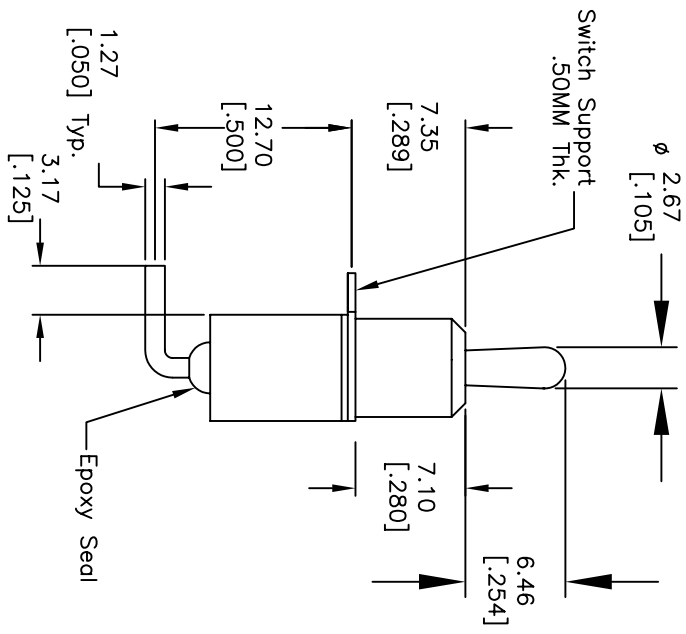
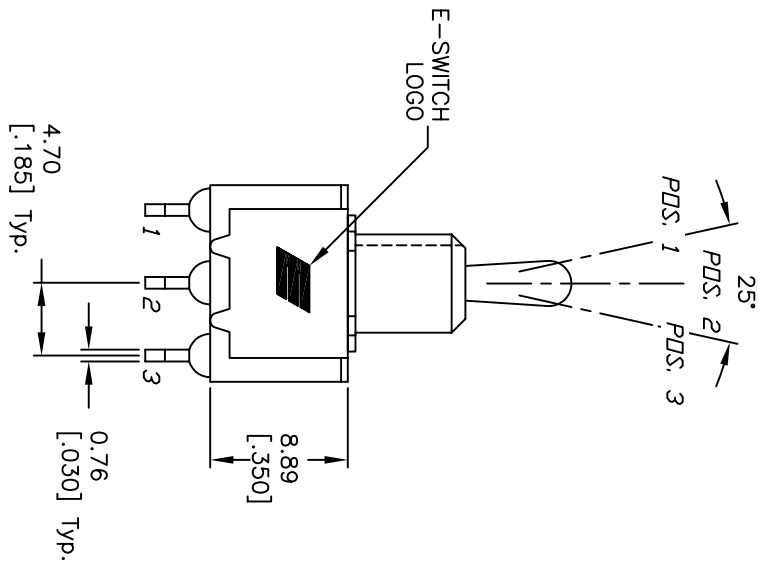
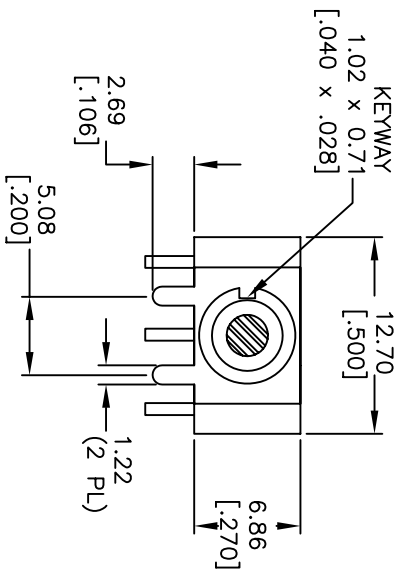

|      |         |                         |          |      |
|------|---------|-------------------------|----------|------|
| B    | 16567   | 6.86 TD 6.46 DIM.       | 10/23/06 | TN   |
| A    | 11520   | RELEASED FOR PRODUCTION | 5/31/01  | CJB  |
| REV. | ECN No. | DESCRIPTION             | DATE     | CHKD |

|       |         |                       |         |     |
|-------|---------|-----------------------|---------|-----|
| TITLE |         | 100 SP-3 T2 B4 M6 R E |         |     |
| SCALE | DATE    | DR                    | DWG     | REV |
| 2:1   | 5/31/01 | CJB                   | T113030 | B   |

