



4

3

2

1

THIS DRAWING IS UNPUBLISHED. RELEASED FOR PUBLICATION. ALL RIGHTS RESERVED.

### TOGGLES

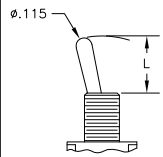
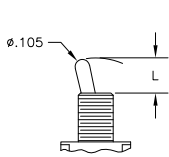

DIM L	BUSHING TYPE	DIM L	BUSHING TYPE
.200	Y, H	.410	Y, H
.270	D, D9	.480	D, D9

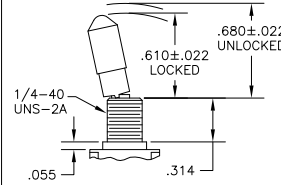
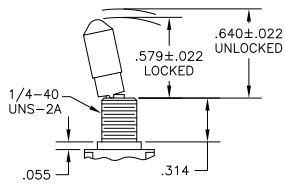

DIM L	BUSHING TYPE	DIM L	BUSHING TYPE
.840	Y, H	.640	Y, H
.910	D, D9	.710	D, D9

REV	DATE	BY	APP'D	DESCRIPTION
1				SEE SHEET 1

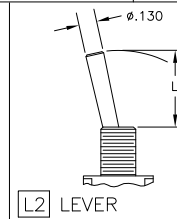
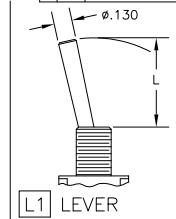
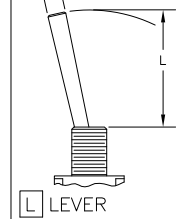

DIM L	BUSHING TYPE	DIM L	BUSHING TYPE	DIM L	BUSHING TYPE
.840	Y, H	.640	Y, H	.620	Y, H
.910	D, D9	.710	D, D9	.620	D, D9

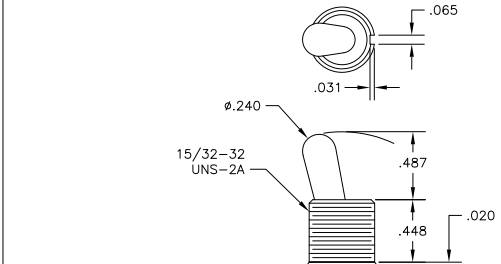
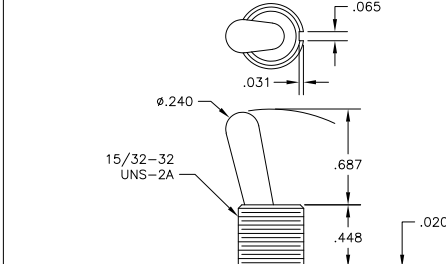
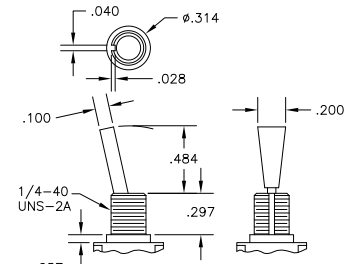

DIM L	BUSHING TYPE	DIM L	BUSHING TYPE
.100	Y, H	.200	Y, H
.057	D, D9	.297	D, D9

### BUSHINGS

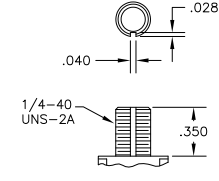
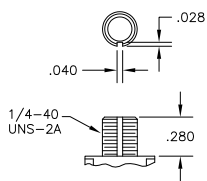

CONTAINS O-RING BETWEEN TOGGLE AND BUSHING AND BETWEEN BUSHING AND PANEL

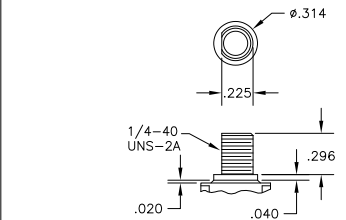
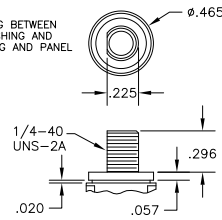

THIS DRAWING IS A CONTROLLED DOCUMENT.

DESIGNED BY: M. ZITTO	CHECKED BY: M. ZITTO	DATE: 00
APPROVED BY: M. ZITTO	NAME: M. ZITTO	TE Connectivity
APPLICATION SPEC: GEMINI A SERIES TOGGLE SWITCH, SINGLE POLE, 3 POSITION FUNCTIONS (03, 05 & 07)	SIZE: A2	CAGE CODE: 00779
WEIGHT: 1825137	SCALE: 2:1	SHEET: 2 of 4
MATERIAL: -	FINISH: -	REV: A4

CUSTOMER DRAWING

4

3

2

1

THIS DRAWING IS UNPUBLISHED. RELEASED FOR PUBLICATION. ALL RIGHTS RESERVED.

LOC	DIST	REVISIONS					
AD	00	P	LTR	DESCRIPTION	DATE	BY	APPD
		-	-	SEE SHEET 1			

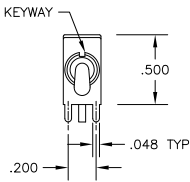

AV2 VERTICAL RIGHT ANGLE

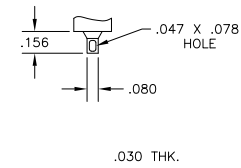
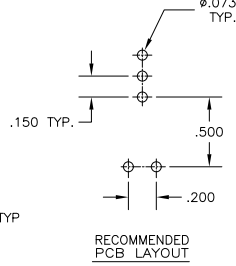
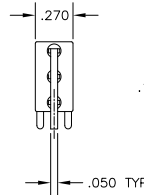
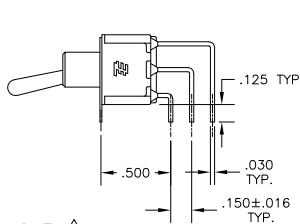

Z WIRE LUG

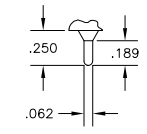

Z3 QUICK CONNECT

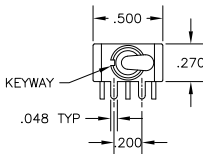

A RIGHT ANGLE

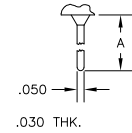
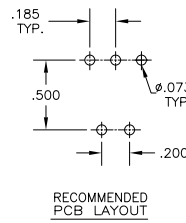
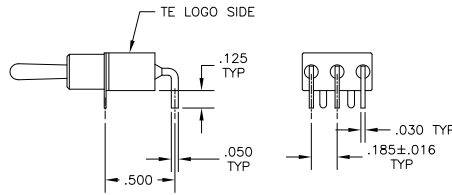

W W4 WIRE WRAP

OPTION	DIM A
W	.736
W4	1.062

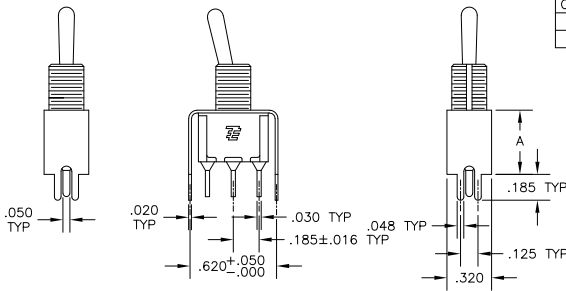

V30 V40 VERTICAL SUPPORT BRACKET

OPTION	DIM A
V30	.460
V40	.630

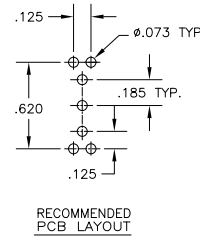

C PRINTED CIRCUIT

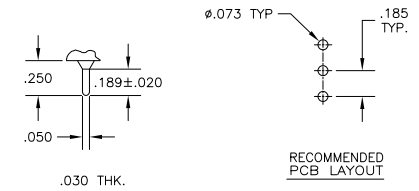

THIS DRAWING IS A CONTROLLED DOCUMENT.

DESIGNER: M. ZITTO	DATE: 10/14/05	 TE Connectivity
CHK: M. ZITTO		
APP: M. ZITTO		GEMINI A SERIES TOGGLE SWITCH, SINGLE POLE, 3 POSITION FUNCTIONS (03, 05 & 07)
PRODUCT SPEC: -		
APPLICATION SPEC: -	SIZE: A2	CAGE CODE: 00779 DRAWING NO: 1825137
WEIGHT: -	SCALE: 2:1	
MATERIAL: -	FINISH: -	RESTRICTED TO: -
CUSTOMER DRAWING		SHEET: 3 of 4

4

3

2

1

THIS DRAWING IS UNPUBLISHED. RELEASED FOR PUBLICATION. ALL RIGHTS RESERVED.

LOC	DIST	REVISIONS			
AD	00	P	LTR	DESCRIPTION	DATE
		-	-	SEE SHEET 1	-

Alco P/N	P/N	
A103KZQ04	1825137-1	
A103MD9AB04	1825137-2	
A103MD9AG04	1825137-3	
A103MD9AQ04	1825137-4	
A103MD9AV2B04	1825137-5	
A103P3ZQ04	1825137-6	
A103SD9AQ04	1825137-7	
A103SD9AV2B04	1825137-8	
A103SD9AV2Q04	1825137-9	
A103SDCB04	1-1825137-0	
A103SDCCQ04	1-1825137-1	
A103SDZQ04	1-1825137-2	
A103SYAQ04	1-1825137-3	
A103SYAV2Q04	1-1825137-4	
A103SYCB04	1-1825137-5	
A103SYCQ04	1-1825137-6	
A103SYWB04	1-1825137-7	
A103SYWQ04	1-1825137-8	
A103SYZB04	1-1825137-9	
A103SYZQ04	2-1825137-0	
A103T1CG04	2-1825137-1	
A103T1ZQ04	2-1825137-2	
A103TZQ04	2-1825137-3	
A105MD9AB04	2-1825137-4	
A105MD9AQ04	2-1825137-5	
A105MYV3Q004	2-1825137-6	
A105P3CG04	2-1825137-7	
A105P3CQ04	2-1825137-8	
A105P3ZQ04	2-1825137-9	
not assigned	3-1825137-0	
A105SD9AB04	3-1825137-1	
A105SD9AV2Q04	3-1825137-2	
A105SD9V30B04	3-1825137-3	
A105SYAB04	3-1825137-4	
A105SYAV2B04	3-1825137-5	
A105SYCB04	3-1825137-6	
A105SYCQ04	3-1825137-7	
A105SYZB04	3-1825137-8	
A105SYZQ04	3-1825137-9	
A105T1ZB04	4-1825137-0	
A105T1ZQ04	4-1825137-1	
A105TZQ04	4-1825137-2	
A107KAV2Q04	4-1825137-3	
A107KZB04	4-1825137-4	
A107MD9AV2B04	4-1825137-5	
A107MD9CQ04	4-1825137-6	
A107MD9V30Q04	4-1825137-7	
A107P3ZQ04	4-1825137-8	
A107SYAQ04	4-1825137-9	
A107SYCB04	5-1825137-0	
A107SYCQ04	5-1825137-1	
A107SYZQ04	5-1825137-2	
A107TZB04	5-1825137-3	
A105MD9AV2B	5-1825137-4	
A103MD9V30B04	5-1825137-5	PRELIMINARY
A103MCWC04	5-1825137-6	PRELIMINARY
A103SCWC04	5-1825137-7	PRELIMINARY

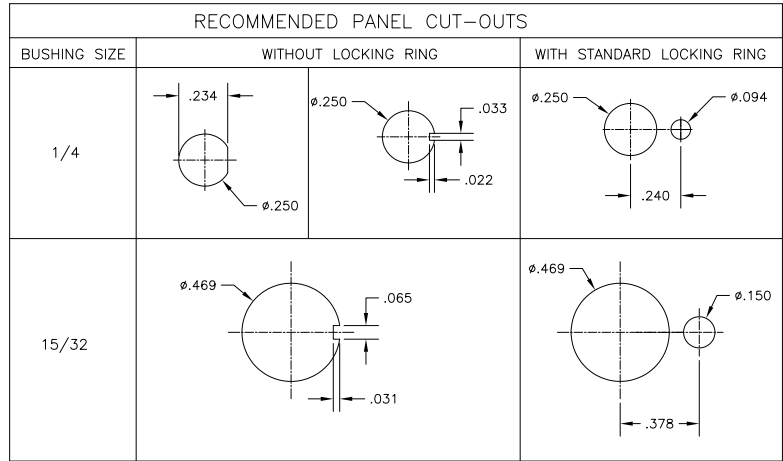

COMPONENT NAME	BASE MATERIAL	FINISH
CASE	DAP, RED, UL94 V-0	
FRAME	STAINLESS STEEL	
B TERMINALS & CONTACTS	COPPER	GOLD OVER NICKEL
G TERMINALS & CONTACTS	COPPER	GOLD OVER SILVER
Q TERMINALS & CONTACTS	COPPER	.000400 SILVER
ACTUATOR	PHENOLIC, BLACK, UL94 V-1	
LEVER	BRASS	CHROME
BUSHING	BRASS	NICKEL
SPRING	MUSIC WIRE	
SUPPORT BRACKET	BRASS	TIN
PIVOT PIN	STEEL	NICKEL
LOCK WASHER	STAINLESS STEEL	
LOCKING RING	STAINLESS STEEL	
NUTS	C3604BD BRASS	NICKEL
TERMINAL SEAL	EPOXY	

THIS DRAWING IS A CONTROLLED DOCUMENT. DIMENSIONS: INCHES. TOLERANCES UNLESS OTHERWISE SPECIFIED: 0 PLC ± .005, 1 PLC ± .004, 2 PLC ± .003, 3 PLC ± .010, 4 PLC ± .015, ANGLES ± .5°.

DATE: 01/11/00. BY: M. ZITTO. CHECKED: M. ZITTO. APPROVED: M. ZITTO. NAME: M. ZITTO. PRODUCT SPEC: APPLICATION SPEC: WEIGHT: CUSTOMER DRAWING. SCALE: 3:1. SHEET: 4 of 4. REV: A4.

TE Connectivity logo and text: GEMINI A SERIES TOGGLE SWITCH, SINGLE POLE, 3 POSITION FUNCTIONS (03, 05 & 07). SIZE: A2. CASE CODE: 00779. DRAWING NO: C=1825137. RESTRICTED TO: -.