

4

3

2

1

THIS DRAWING IS UNPUBLISHED. RELEASED FOR PUBLICATION. ALL RIGHTS RESERVED.

| LOC | DIST | REVISIONS | | |
|-----|------|---------------------------|---------|--------|
| P | LTR | DESCRIPTION | DATE | BY |
| AD | 00 | | | |
| A4 | | REVISED PER ECO-11-004587 | 11MAR11 | RK HMR |

NOTES:

- ALL MATERIALS AND FINISHES SHALL COMPLY WITH EU DIRECTIVE 2002/95/EC OF 27JAN2003 (ROHS).
- EACH SWITCH WITH THREADED BUSHINGS SUPPLIED WITH THE FOLLOWING MOUNTING HARDWARE:
(2) HEX NUTS
(1) INTERNAL TOOTH LOCKWASHER
(1) LOCATING RING.
- G CONTACT OPTION CAN BE USED FOR SIGNAL OR POWER LEVEL SWITCHING. IF SWITCH IS USED AT LEVELS EXCEEDING .4VA @ 20V AC/DC, SWITCH IS RENDERED FOR POWER SWITCHING ONLY DUE TO ARC REMOVAL OF GOLD PLATING. RATING STAMPED ON FRAME IS 2A 250VAC, 5A 120VAC.

- △4 DATE CODE AND COUNTRY OF ORIGIN MAY APPEAR ON EITHER SIDE OF SWITCH.
- △5 LENGTH OF TOGGLE REDUCED BY .020 WITH A, AV2, V30 OR V40 VERTICAL SUPPORT BRACKET OPTIONS.

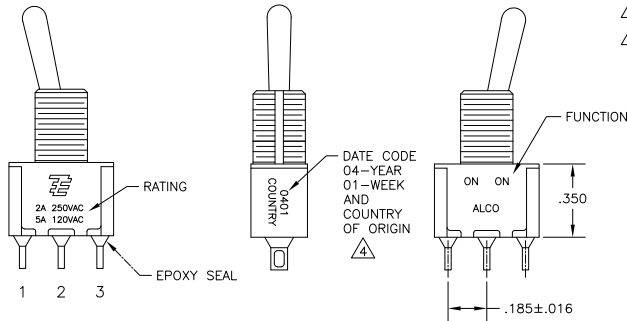
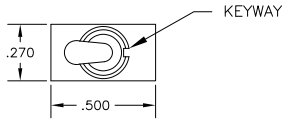

| FUNCTION CHART | | | |
|---------------------|-------|-------|-------|
| FUNCTION | 1 2 3 | 1 2 3 | 1 2 3 |
| 01 | ON | NONE | ON |
| 08 | ON | NONE | (ON) |
| TERMINALS CONNECTED | 2-3 | --- | 1-2 |

None: No mechanical position
Off: Mechanical position with no electrical connection
(On): Momentary action

| SPECIFICATIONS CHART | |
|---------------------------------|---|
| RATING, B CONTACTS | .4VA MAX @20V MAX. AC OR DC |
| RATING, G CONTACTS—SEE NOTE 3 | .4VA MAX @20V MAX. AC OR DC OR 5A @120 VAC OR 28 VDC (RESISTIVE) |
| RATING, Q CONTACTS | 2A @250 VAC (RESISTIVE) 5A @120 VAC OR 28 VDC (RESISTIVE) |
| ELECTRICAL LIFE | 6,000 CYCLES AT RATED LOAD |
| CONTACT RESISTANCE | 10 MILLIOHMS MAX INITIAL @ 2-4VDC, 100ma |
| INSULATION RESISTANCE | 1,000 MEGOHMS MIN |
| DIELECTRIC WITHSTANDING VOLTAGE | 1,000 V RMS AT SEA LEVEL |
| OPERATING TEMPRATURE | -30C TO 85C |

| PART NUMBER SEQUENCE CHART | | | | | | |
|----------------------------|----------|--------|---------|----------|---------|------|
| MODEL | FUNCTION | TOGGLE | BUSHING | TERMINAL | CONTACT | RoHS |
| A1 | 01 | K | CW | A | B | 04 |
| | 08 | K1 | D | AV2 | G | |
| | | L | D9 | C | Q | |
| | | L1 | H | V30 | | |
| | | L2 | Y | V40 | | |
| | | M | Y9 | W | | |
| | | P3 | | W4 | | |
| | | S | | Z | | |
| | | T | | Z3 | | |
| | | T1 | | | | |

EXAMPLE: A101SYCQ04

| | | | | | |
|--|--|----------------------|--|-----------------------|-------------------|
| THIS DRAWING IS A CONTROLLED DOCUMENT. | | DRN: S.S. VISVESWARA | 14MPRO5 | TE Connectivity | |
| DIMENSIONS: INCHES | | CHK: M. ZITTO | GEMINI A SERIES TOGGLE SWITCH, SINGLE POLE, 2 POSITION FUNCTIONS (01 & 08) | | |
| OTHER DIMENSIONS: MILLIMETERS | | APPD: P. BROUILLETTE | PRODUCT SPEC: APPLICATION SPEC: SIZE: A2 | | |
| MATERIAL: FINISH: | | WEIGHT: | CAGE CODE: 00779 | DRAWING NO: C=1825136 | RESTRICTED TO: A4 |
| | | | CUSTOMER DRAWING | SCALE: 3:1 | SHEET: 1 of 4 |

4

3

2

1

THIS DRAWING IS UNPUBLISHED. RELEASED FOR PUBLICATION. ALL RIGHTS RESERVED.

TOGGLES

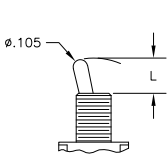

M SHORT

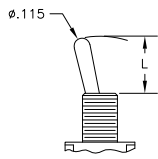

S STANDARD

| DIM L | BUSHING TYPE | DIM L | BUSHING TYPE |
|-------|--------------|-------|--------------|
| .200 | Y, H | .410 | Y, H |
| .270 | D, D9 | .480 | D, D9 |

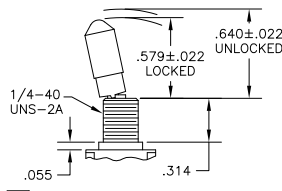

K NO BUSHING OPTION NEEDED

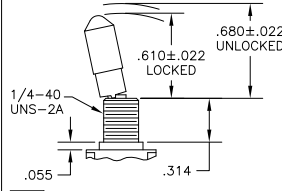

K1 NO BUSHING OPTION NEEDED

| REV. NO. | DATE | BY | APP'D | DESCRIPTION |
|----------|------|----|-------|-------------|
| 00 | | | | SEE SHEET 1 |

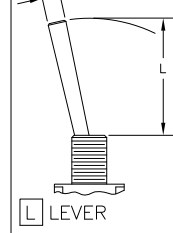

L LEVER

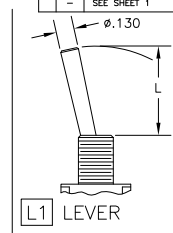

L1 LEVER

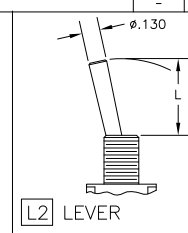

L2 LEVER

| DIM L | BUSHING TYPE | DIM L | BUSHING TYPE | DIM L | BUSHING TYPE |
|-------|--------------|-------|--------------|-------|--------------|
| .840 | Y, H | .640 | Y, H | .550 | Y, H |
| .910 | D, D9 | .710 | D, D9 | .620 | D, D9 |

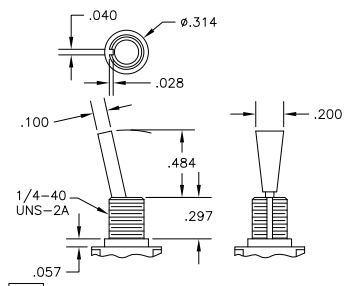

P3 NO BUSHING OPTION NEEDED

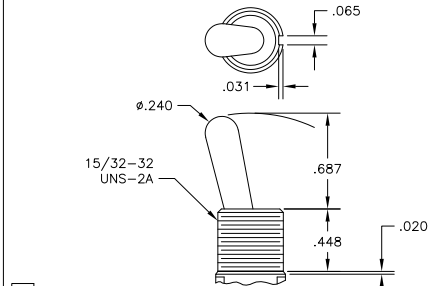

T NO BUSHING OPTION NEEDED

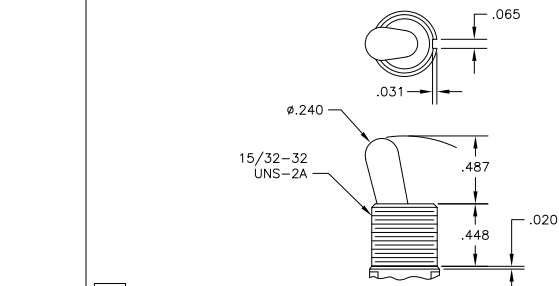

T1 NO BUSHING OPTION NEEDED

BUSHINGS

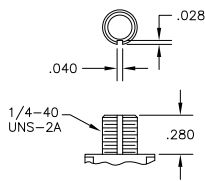

D THREADED
D9 UNTHREADED

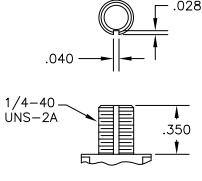

Y THREADED
Y9 UNTHREADED

CONTAINS O-RING BETWEEN TOGGLE AND BUSHING AND BETWEEN BUSHING AND PANEL

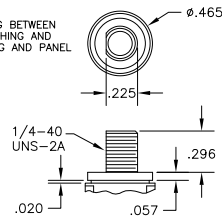

CW THREADED SPLASHPROOF

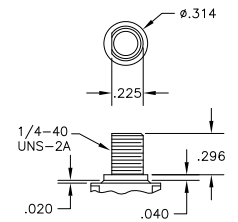

H HIGH TORQUE

THIS DRAWING IS A CONTROLLED DOCUMENT.

| DIMENSIONS: | UNLESS OTHERWISE SPECIFIED: |
|-------------|-----------------------------|
| INCHES: | |
| Ø | PLC ± .010 |
| PLC | ± .010 |
| PLC | ± .010 |
| PLC | ± .010 |
| PLC | ± .010 |
| ANGLES | ± .2° |
| MATERIAL | |
| FINISH | |

| DESIGN | DATE | NAME | TE Connectivity |
|------------------|---------|----------------|-----------------|
| S. S. VISWESWARA | 14MAY08 | M. ZITTO | |
| CH | | P. BROUILLETTE | |
| PRODUCT SPEC | | | |
| APPLICATION SPEC | | | |
| WEIGHT | | | |
| CUSTOMER DRAWING | | | |

GEMINI A SERIES TOGGLE SWITCH, SINGLE POLE, 2 POSITION FUNCTIONS (01 & 08)

SIZE: A2 CAGE CODE: 00779 DRAWING NO: 1825136

RESTRICTED TO: SCALE: 2:1 SHEET: 2 of 4 REV: A4

4

3

2

1

THIS DRAWING IS UNPUBLISHED. RELEASED FOR PUBLICATION
 © COPYRIGHT - By - ALL RIGHTS RESERVED.

| LOC | DIST | REVISIONS | | |
|-----|------|-------------|------|----|
| P | LTR | DESCRIPTION | DATE | BY |
| AD | 00 | SEE SHEET 1 | - | - |

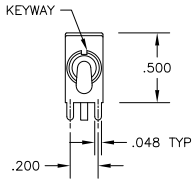

AV2 VERTICAL RIGHT ANGLE \triangle

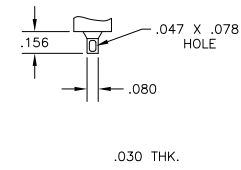
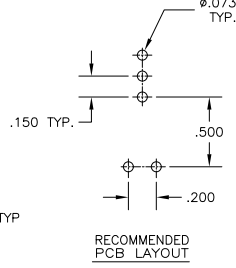
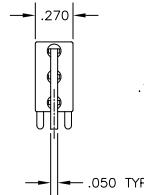
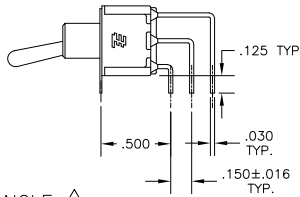

Z WIRE LUG

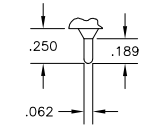

Z3 QUICK CONNECT

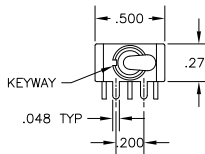

A RIGHT ANGLE \triangle

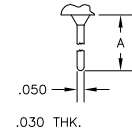
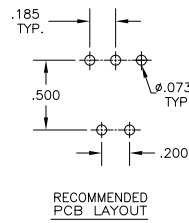
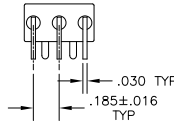
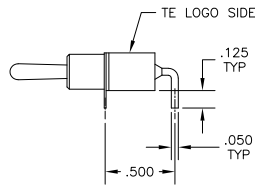

W W4 WIRE WRAP

| OPTION | DIM A |
|--------|-------|
| W | .736 |
| W4 | 1.062 |

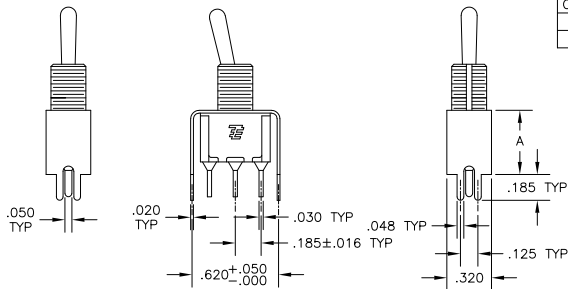

V30 V40 \triangle
 VERTICAL SUPPORT BRACKET

| OPTION | DIM A |
|--------|-------|
| V30 | .460 |
| V40 | .630 |

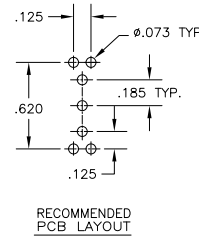

C PRINTED CIRCUIT

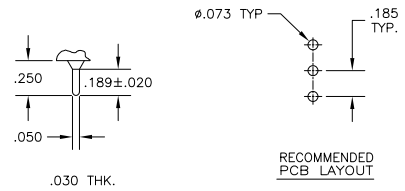

| | | | | | |
|--|--|----------------------|----------------------|--|------------------|
| THIS DRAWING IS A CONTROLLED DOCUMENT. | | DRN: S.S. VISWESWARA | 14MPROD | TE Connectivity | |
| DIMENSIONS: INCHES | | CHK: M. ZITTO | APPD: P. BROUILLETTE | GEMINI A SERIES TOGGLE SWITCH, SINGLE POLE, 2 POSITION FUNCTIONS (01 & 08) | |
| OTHER DIMENSIONS: MILLIMETERS | | PROJCT SPEC: - | APPLICATION SPEC: - | SIZE: A2 | CAGE CODE: 00779 |
| MATERIAL: - | | FINISH: - | WEIGHT: - | SCALE: 2:1 | SHEET: 3 of 4 |
| CUSTOMER DRAWING | | DRAWING NO: 1825136 | | RESTRICTED TO: - | REV: A4 |

4

3

2

1

THIS DRAWING IS UNPUBLISHED. RELEASED FOR PUBLICATION. ALL RIGHTS RESERVED.

| | | | | | | |
|-----|------|-----------|-----|-------------|----|------|
| LOC | DIST | REVISIONS | | DATE | BY | APPD |
| AD | 00 | P | LTR | DESCRIPTION | | |
| | | - | - | SEE SHEET 1 | - | - |

| Alco P/N | P/N |
|---------------|-------------|
| A101K1V30B04 | 1825136-1 |
| A101KAB04 | 1825136-2 |
| A101KAQ04 | 1825136-3 |
| A101P3YV30B04 | 1825136-4 |
| A101KCQ04 | 1825136-5 |
| A101KD9AQ04 | 1825136-6 |
| A101KZQ04 | 1825136-7 |
| A101SYAV2B04 | 1825136-8 |
| A101LD9V30Q04 | 1825136-9 |
| A101L1YZB04 | 1-1825136-0 |
| A101LDZQ04 | 1-1825136-1 |
| A101MD9AB04 | 1-1825136-2 |
| A101MD9AG04 | 1-1825136-3 |
| A101MD9AQ04 | 1-1825136-4 |
| A101MD9AV2B04 | 1-1825136-5 |
| A101MD9AV2G04 | 1-1825136-6 |
| A101MD9AV2Q04 | 1-1825136-7 |
| A101MD9V30B04 | 1-1825136-8 |
| A101MDAQ04 | 1-1825136-9 |
| A101MDAV2B04 | 2-1825136-0 |
| A101MDCG04 | 2-1825136-1 |
| A101MDZQ04 | 2-1825136-2 |
| A101MYCQ04 | 2-1825136-3 |
| A101MYZQ04 | 2-1825136-4 |
| A103SYAV2B04 | 2-1825136-5 |
| A101P3CB04 | 2-1825136-6 |
| A101P3ZQ04 | 2-1825136-7 |
| A101KAV2Q04 | 2-1825136-8 |
| not assigned | 2-1825136-9 |
| A101SCWCQ004 | 3-1825136-0 |
| A101SCWZQ04 | 3-1825136-1 |
| A101SD9AB04 | 3-1825136-2 |
| A101SD9AQ04 | 3-1825136-3 |
| A101SD9AV2B04 | 3-1825136-4 |
| A101SD9AV2Q04 | 3-1825136-5 |
| A101SD9V30B04 | 3-1825136-6 |
| A101SD9V30Q04 | 3-1825136-7 |
| A101SDCQ04 | 3-1825136-8 |
| A101SDZQ04 | 3-1825136-9 |
| A101SHZQ04 | 4-1825136-0 |
| A101SY9CQ04 | 4-1825136-1 |
| A101SYAB04 | 4-1825136-2 |
| A101SYAQ04 | 4-1825136-3 |
| A101SYCB04 | 4-1825136-4 |
| A101SYCQ04 | 4-1825136-5 |
| not assigned | 4-1825136-6 |
| A101SYWQ04 | 4-1825136-7 |
| A101SYZB04 | 4-1825136-8 |

| Alco P/N | P/N |
|--------------|-------------|
| A101SYZQ04 | 4-1825136-9 |
| not assigned | 5-1825136-0 |
| not assigned | 5-1825136-1 |
| A101T1ZB04 | 5-1825136-2 |
| A101T1ZQ04 | 5-1825136-3 |
| A101TCQ04 | 5-1825136-4 |
| A101TZQ04 | 5-1825136-5 |
| A108MD9AB04 | 5-1825136-6 |
| not assigned | 5-1825136-7 |
| A108P3CQ04 | 5-1825136-8 |
| A108P3ZQ04 | 5-1825136-9 |
| A108SD9AQ04 | 6-1825136-0 |
| A108SDZQ04 | 6-1825136-1 |
| A108SYCB04 | 6-1825136-2 |
| A108SYCQ04 | 6-1825136-3 |
| A108SYZQ04 | 6-1825136-4 |
| not assigned | 6-1825136-5 |
| A101SYAG04 | 6-1825136-6 |

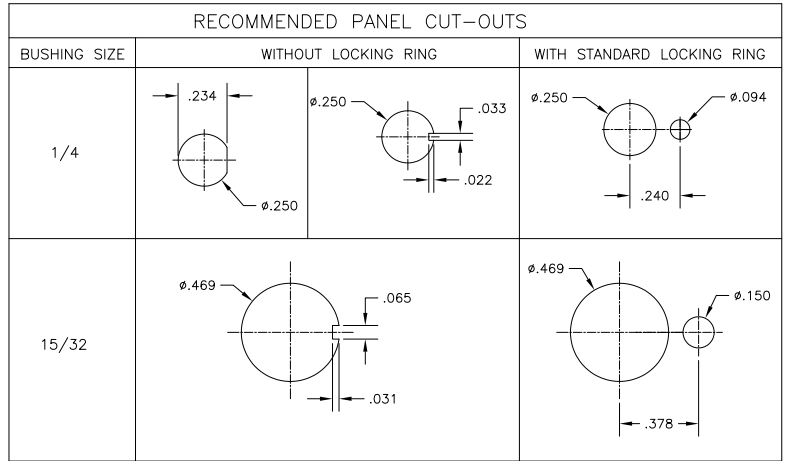

| COMPONENT NAME | BASE MATERIAL | FINISH |
|------------------------|---------------------------|------------------|
| CASE | DAP, RED, UL94 V-0 | |
| FRAME | STAINLESS STEEL | |
| B TERMINALS & CONTACTS | COPPER | GOLD OVER NICKEL |
| G TERMINALS & CONTACTS | COPPER | GOLD OVER SILVER |
| Q TERMINALS & CONTACTS | COPPER | .000400 SILVER |
| ACTUATOR | PHENOLIC, BLACK, UL94 V-1 | |
| LEVER | BRASS | CHROME |
| BUSHING | BRASS | NICKEL |
| SPRING | MUSIC WIRE | |
| SUPPORT BRACKET | BRASS | TIN |
| PIVOT PIN | STEEL | NICKEL |
| LOCK WASHER | STAINLESS STEEL | |
| LOCKING RING | STAINLESS STEEL | |
| NUTS | C3604BD BRASS | NICKEL |
| TERMINAL SEAL | EPOXY | |

THIS DRAWING IS A CONTROLLED DOCUMENT. DIM: S. S. VISVESWARA 14MPROD

DATE: 08/01/00

BY: M. ZITTO

APPD: P. BROUILLETTE

NAME: GEMINI A SERIES TOGGLE SWITCH, SINGLE POLE, 2 POSITION FUNCTIONS (01 & 08)

PRODUCT SPEC: --

APPLICATION SPEC: --

WEIGHT: --

SIZE: A2

CAGE CODE: 00779

DRAWING NO: C=1825136

RESTRICTED TO: --

CUSTOMER DRAWING

SCALE: 3:1

SHEET: 4 of 4

REV: A4