

CIRCUIT DIAGRAM:

- NOTES:
1. ALL DIMENSIONS IN MM [INCH]
  2. GENERAL TOLERANCE: X.X=±0.4 X:XX=±0.25
  3. TERM. NOS. FOR REFERENCE ONLY.
  4. RATINGS: 12VDC, 50mA
  5. CONTACT MATERIAL: SILVER
  6. OPERATING FORCE: 180±50gf (B)
  7. TRAVEL: 0.25±0.1mm
  8. CONTACT RESISTANCE: 100Ω Max.
  9. LIFE: 50,000 Cycles min.
  10. PACKAGING: BULK
  11. ▲ DENOTES CRITICAL PARAMETER.
  12. 2002/95/EC (ROHS) COMPLIANT

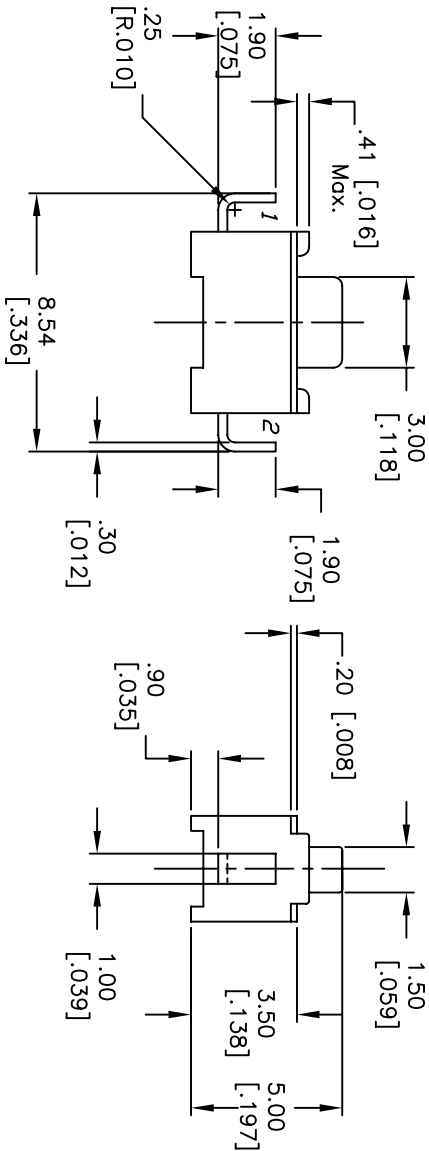
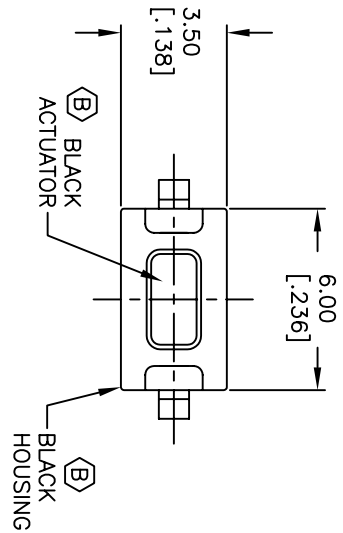

REV.	ECN No.	DESCRIPTION	DATE	CHKD
C	16634	UPDATED NOTES	11/9/06	TN
B	14881	CHANGED NOTE 6 & WHT- BLK	4/28/05	JB
A	14435	RELEASED FOR PRODUCTION	10/27/04	AR

REV.	ECN No.	DESCRIPTION	DATE	CHKD	SCALE	DATE	DR	DWG	REV
		THE INFORMATION CONTAINED IN THIS DOCUMENT IS PROPRIETARY TO E-SWITCH AND IS NOT TO BE COPIED OR TRANSMITTED			4:1	11/9/2006	TN	D310319	C



TL1107BF180EQ