

SHEET 1 OF 1

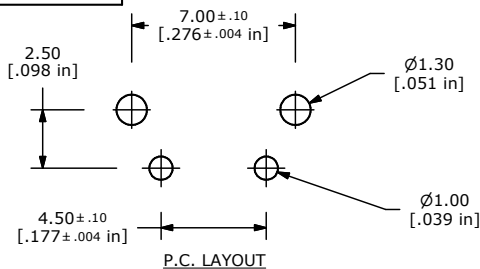

P.C. LAYOUT

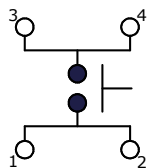

CIRCUIT: SPST

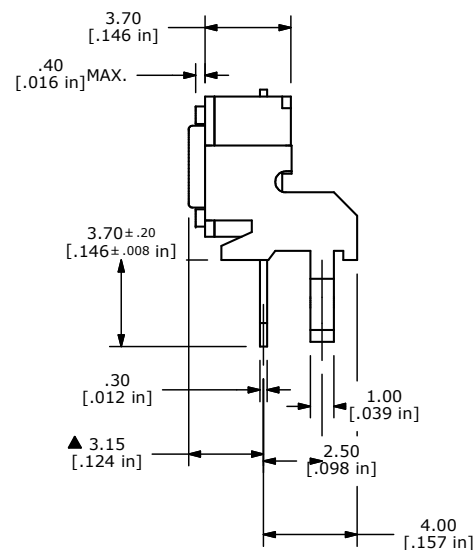
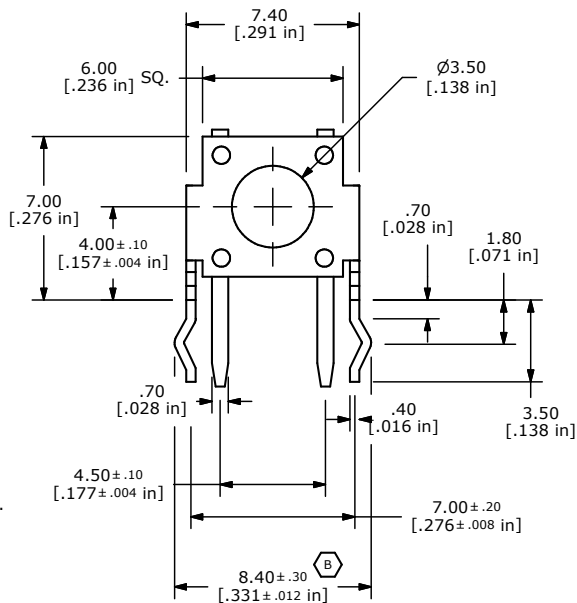
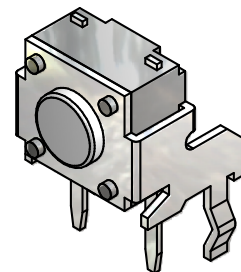
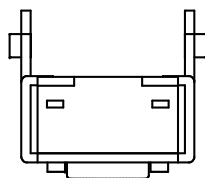

NOTES:

1. ALL DIMENSIONS IN MM [INCH]
2. GENERAL TOLERANCE: X.X ± 0.4
X.XX ± 0.30
3. TERM. NOS. FOR REF. ONLY
4. RATING: 50mA, @12V DC
5. TRAVEL: 0.25 +0.20 /-0.10 mm
6. CONTACT RESISTANCE: 50m ohms max initial.
(CMOS & TTL COMPATIBLE)
7. ELECTRICAL LIFE: 1,000,000 CYCLES
8. INSULATION RESISTANCE: 100M ohms min.
9. DIELECTRIC STRENGTH: 250VAC, 1 MIN.
10. OPERATING TEMP.: -20°C to 70°C
11. ▲ DENOTES CRITICAL PARAMETER
- ▲12. CONTACTS: SILVER
- ▲13. OPERATING FORCE: 65± 20 GRAMS
14. PACKAGING: 1000 PCS PER POLYBAG
15. 2002/95/EC (ROHS) COMPLIANT



E-SWITCH®



B	18742	LEG TOLERANCE WAS +/- 0.1	1/4/2010	BLR
A	16277	RELEASED FOR PRODUCTION	8/8/06	BO
REV	PCR NO	DESCRIPTION	DATE	BY

TITLE LL1105WF065Q				
SCALE	DATE	DR	DWG	REV
4:1	1/4/2010	BLR	P090006	B

THE INFORMATION CONTAINED IN THIS DOCUMENT IS PROPRIETARY TO E-SWITCH AND IS NOT TO BE COPIED OR TRANSFERRED