

SHEET 1 OF 1

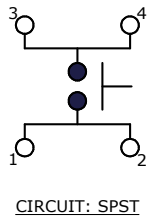

- NOTES:
1. ALL DIMENSIONS IN MM [INCH]
  2. GENERAL TOLERANCE:  $x.xx \pm 0.4$   
 $x.xx \pm 0.25$
  3. TERM. NOS. FOR REF. ONLY
  4. RATING: 50mA, @12V DC
  5. TRAVEL:  $0.25 \pm 0.1$ mm
  6. CONTACT RESISTANCE: 50m ohms max initial.MOS & TTC COMPATIBLE
  7. ELECTRICAL LIFE: 5 MILLION CYCLES.
  8. INSULTION RESISTANCE: 100M ohms min.
  9. OPERATING TEMP.: -30°C to 85°C
  10. ▲ DENOTES CRITICAL PARAMETER
  - ▲11. CONTACTS: SILVER
  - ▲12. OPENING FORCE: 65 GRAMS
  13. PACKAGE: BULK, 750 PIECES PER POLYBAG
  14. 2002/95/EC (ROHS) COMPLIANT

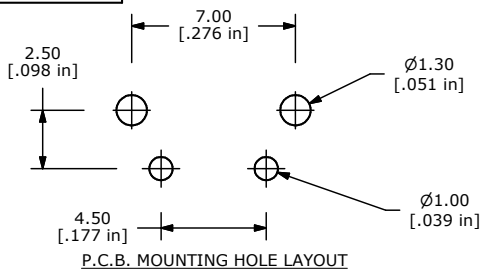
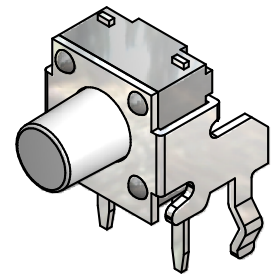
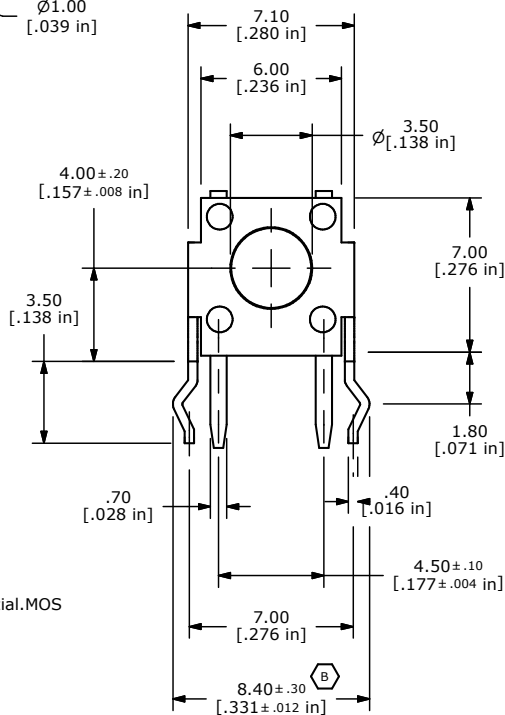

ISOMETRIC

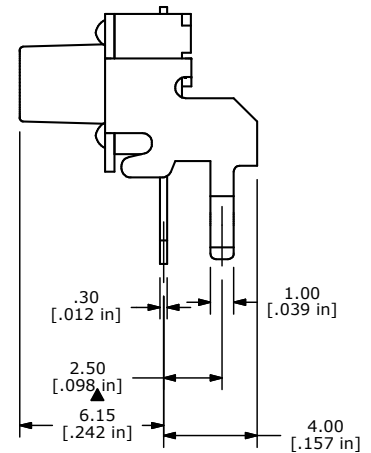

B	18742	LEG TOLERANCE WAS +/- 0.1	1/4/2010	BLR
A	16608	RELEASED FOR PRODUCTION	11/8/2006	TN
REV	PCR NO	DESCRIPTION	DATE	BY

THE INFORMATION CONTAINED IN THIS DOCUMENT IS PROPRIETARY TO E-SWITCH AND IS NOT TO BE COPIED OR TRANSFERRED

TITLE LL1105RF065Q			
SCALE	DATE	DR	DWG
4:1	1/4/2010	BLR	P010243
			REV
			B