

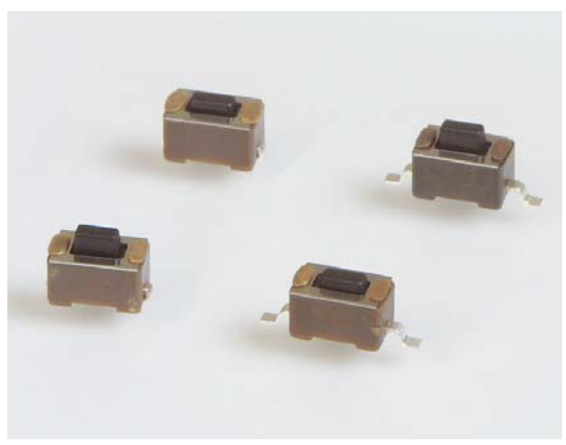

SERIES TL 3302 SWITCHES

TACT SWITCHES SMT - RECTANGULAR



SPECIFICATIONS

Contact Rating:	50mA @ 12 VDC
Life Expectancy:	20,000 - 50,000 cycles, depending on model
Contact Resistance:	100mΩ max., typical @ 2-4 VDC 100mA for both silver and gold plated contacts
Insulation Resistance:	100MΩ min.
Dielectric Strength:	250 VAC
Actuation Force:	130 ± 50 gf, 180 ± 50 gf, 260 ± 50 gf
Operating Temperature:	-20°C to 70°C
Travel:	0.25 Typ.

MATERIALS

Housing:	PPS
Actuator:	PPS
Cover:	Tin plated steel
Contacts:	Silver plated phosphor bronze
Terminals:	Silver plated brass

FEATURES & BENEFITS

- ▶ 3.5 x 6mm packaged design
- ▶ Reliable dome contact technology
- ▶ Strong tactile/audible feedback

APPLICATIONS/MARKETS

- ▶ Telecommunications
- ▶ Consumer Electronics
- ▶ Audio/visual
- ▶ Medical
- ▶ Testing/instrumentation
- ▶ Computer/servers/peripherals

HOW TO ORDER

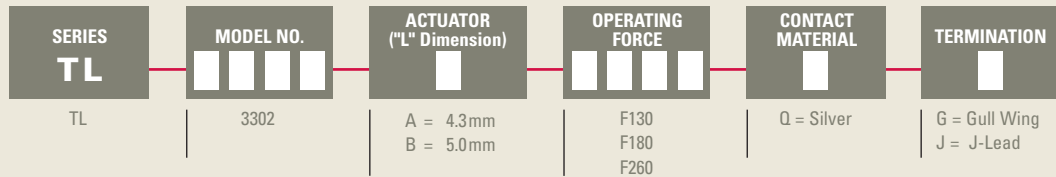

Example Ordering Number

TL-3302-A-F180-Q-G

Specifications subject to change without notice.

TACT SWITCHES

NAVIGATION SWITCHES

PUSHBUTTON SWITCHES

TOGGLE SWITCHES

ROCKER SWITCHES

SLIDE SWITCHES

SNAP-ACTION SWITCHES

DIP SWITCHES

KEYLOCK SWITCHES

ROTARY SWITCHES

DETECTOR SWITCHES

CAP OPTIONS

SERIES TL 3302 SWITCHES

TACT SWITCHES SMT - RECTANGULAR

TACT SWITCHES

TL 3302

GULL WING TERMINATION

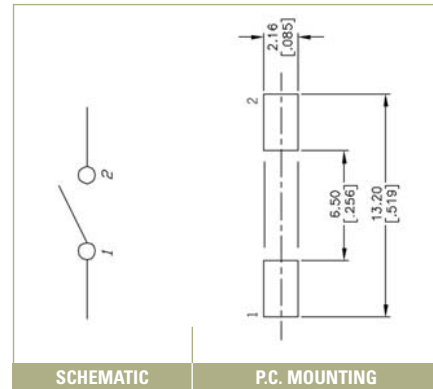
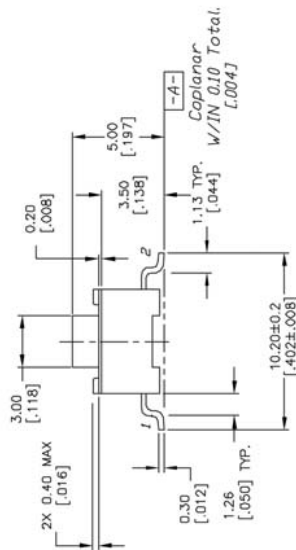
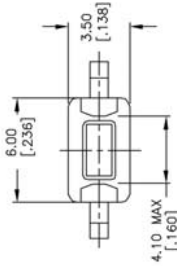

NAVIGATION SWITCHES

PUSHBUTTON SWITCHES

TOGGLE SWITCHES

ROCKER SWITCHES

TL 3302

J-LEAD TERMINATION

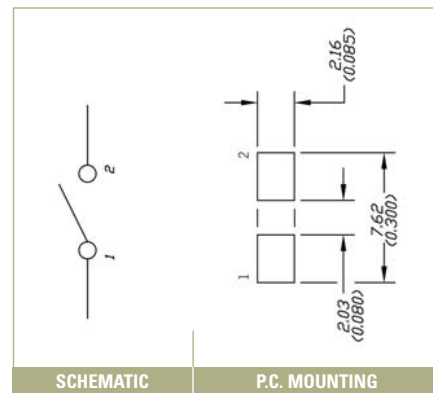
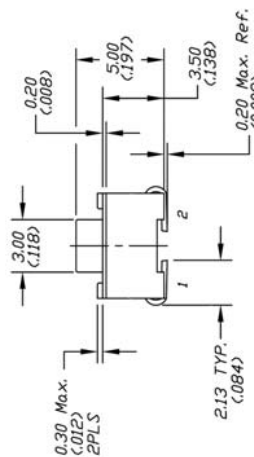
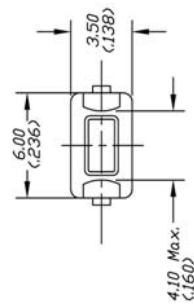

SLIDE SWITCHES

SNAP-ACTION SWITCHES

DIP SWITCHES

KEYLOCK SWITCHES

TL 3302 STANDARD REEL

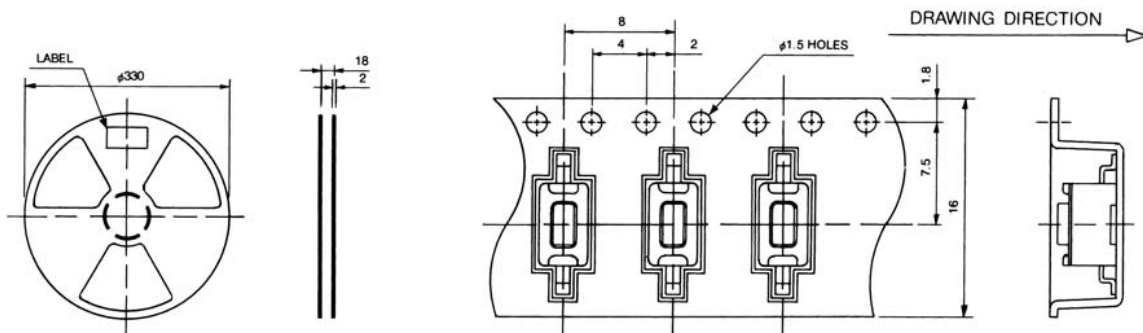

ROTARY SWITCHES

DETECTOR SWITCHES

CAP OPTIONS