

ISOMETRIC

O.P. (MM)	P.T. (MM)
8.5 ±0.3	1.1 MAX.

O.P. = OPERATING POINT  
P.T. = PRE-TRAVEL

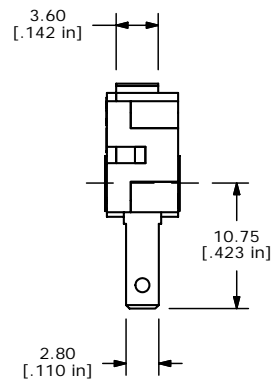
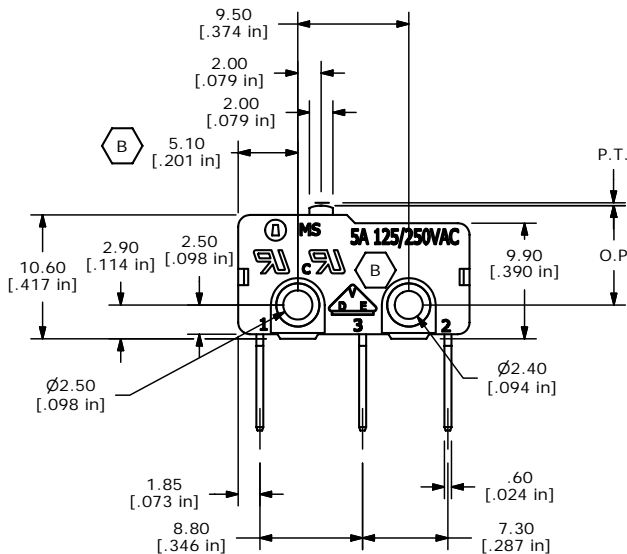
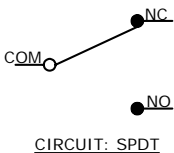

NOTES:

1. ALL DIMENSIONS IN MM [INCH]
2. GENERAL TOLERANCE: X.X=±0.4  
X.XX=±0.25
3. RATING: 5A @125/250VAC UL, CUL, VDE APPROVED
- ▲4. OPERATING FORCE: 150±40 GRAMS
5. OPERATING TEMP: -25°C TO 85°C
6. ELECTRICAL LIFE: 50,000 CYCLES MIN.
7. MECHANICAL LIFE: 1,000,000 CYCLES TYP.
8. INSULATION RESISTANCE: 100 MEGA-OHMS
9. DIELECTRIC STRENGTH: 1000VAC 1 MINUTE (INITIAL VALUE)
10. CONTACT RESISTANCE: 100 MILLI-OHMS MAX.
11. ▲ DENOTES CRITICAL PARAMETER
12. 2002/95/EC (ROHS) COMPLIANT



**E-SWITCH®**

B	15662	CHANGES NOTED	1/5/06	PH
A	15050	RELEASED FOR PRODUCTION	7/1/05	JB
REV	PCR NO	DESCRIPTION	DATE	BY

TITLE MS0850500F150C1A				
SCALE	DATE	DR	DWG	REV
2:1	1/5/2006	JB	Q970023	B

THE INFORMATION CONTAINED IN THIS DOCUMENT IS PROPRIETARY TO E-SWITCH AND IS NOT TO BE COPIED OR TRANSFERRED