

FO-55111-A

HONEYWELL PART NUMBER
21SX39-T2
PRODUCT CODE
VDM3905
JG-NUMBER
JG-80957
MILITARY PART NUMBER
24547-4

REV	DOCUMENT	CHANGED BY	CHECK
12	0038449	VS 28APR08	BLR

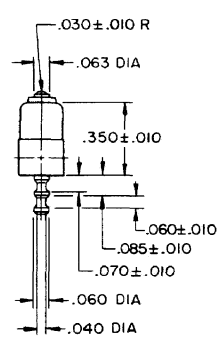
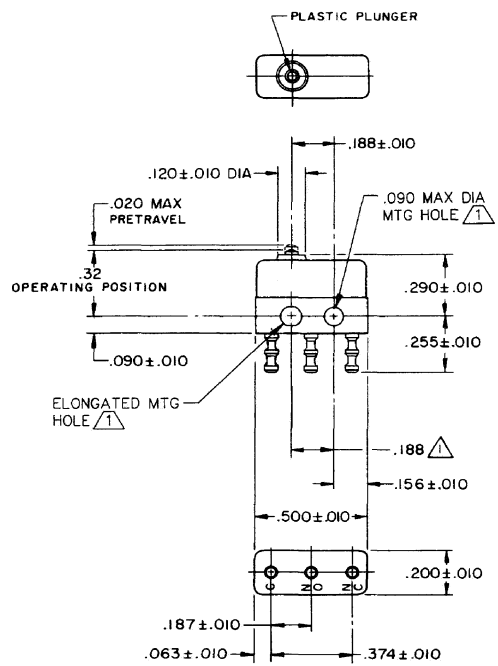

NOTES

- 1 MOUNTING HOLES WILL ACCEPT PINS OR SCREWS OF .087 MAX DIA ON .188 ± .002 CENTERS
- 2 - TERMINALS ARE PLATED FOR SOLDERING
- 3 - SWITCH WILL WITHSTAND TEMPERATURE OF 185° F

RELEASE NO.	PR-534
REPLACES	

CHARACTERISTICS
OPERATING FORCE - - - 5 OZ MAX
RELEASE FORCE - - - 1 OZ MIN
DIFFERENTIAL TRAVEL - - .005 MAX
OVERTRAVEL - - - - .004 MIN

ELECTRICAL DATA			
CONTACT ARRANGEMENT S P D T			
28 VOLTS DC RATING		115 VOLTS AC, 60 CPS	
SEA LEVEL	50,000 FT	SEA LEVEL	
INDUCTIVE	4 AMP	2.5 AMP	7 AMP
RESISTIVE	7 AMP	4 AMP	7 AMP
LAMP	2.5 AMP	2.5 AMP	2 AMP
APPROVALS	KEMA CE 7A 250 V - T125 5E4 CE UL CSA 7A 250 VAC		

DESIGN UNITS: INCH
TOLERANCES UNLESS NOTED:
NO PLACE .X ±
ONE PLACE .X ±
TWO PLACE .XX ±
THREE PLACE .XXX ±
FOUR PLACE .XXXX ±
ANGLES ±
THIRD ANGLE PROJECTION

DRAWN	SPK	20FEB08
CHECK	RJ	20FEB08
THIS DRAWING COVERS A PROPRIETARY ITEM AND IS THE PROPERTY OF HONEYWELL. THIS DRAWING IS NOT TO BE COPIED OR USED WITHOUT THE PERMISSION OF HONEYWELL.		
INTERPRET PER ANSI Y14.5M-1982 OTHER HONEYWELL ENGINEERING STANDARDS MAY APPLY		
RASTER		

Honeywell			
TITLE SWITCH - BASIC			
SIZE	TYPE	DRAWING NAME	REV
B	I	21SX39-T2	12
SCALE	-	WEIGHT:.003 LB MAX	SHEET 1 OF 1

4

3

2

1