

**MICRO SWITCH**  
a Honeywell Division  
FED. MFG. CODE 91929

**SWITCH - BASIC**

CATALOG LISTING  
**US SERIES CHART 2**

THIS DRAWING COVERS A PROPRIETARY ITEM AND IS THE PROPERTY OF MICRO SWITCH, A DIVISION OF HONEYWELL. THIS DRAWING IS NOT TO BE COPIED OR USED WITHOUT THE APPROVAL OF MICRO SWITCH

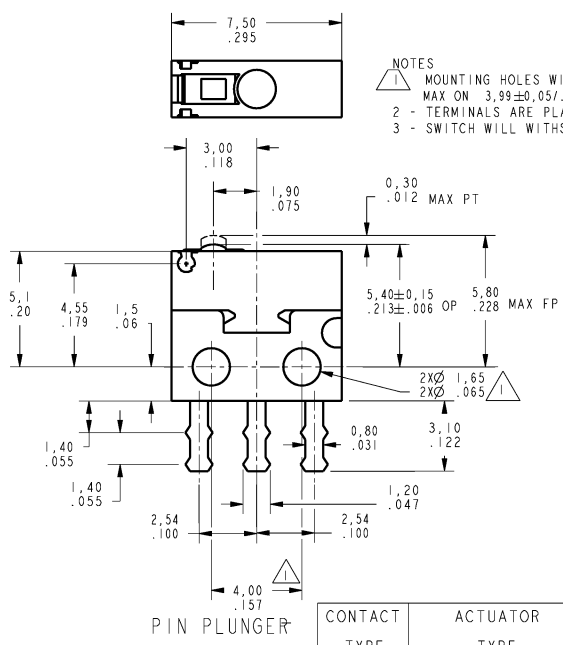

- NOTES**
- 1 - MOUNTING HOLES WILL ACCEPT PINS OR SCREWS OF  $\varnothing 1.40$  MAX ON  $3.99 \pm 0.05 / 1.57 \pm 0.02$  CENTERS
  - 2 - TERMINALS ARE PLATED FOR SOLDERING
  - 3 - SWITCH WILL WITHSTAND A TEMPERATURE OF  $82.2^\circ\text{C} / 180^\circ\text{F}$

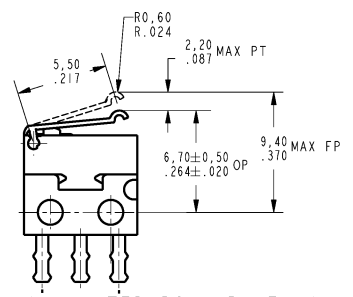
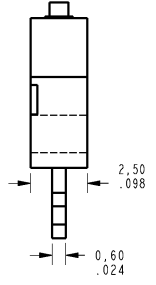

SIMULATED ROLLER LEVER  
SCALE 4:1

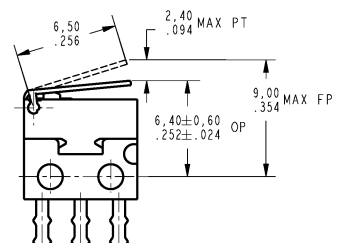

FLAT LEVER  
SCALE 4:1

CONTACT TYPE	ACTUATOR TYPE	CAT. LISTING	SOLDER TERMINAL CHARACTERISTICS						
			OPERATING FORCE MAX	RELEASE FORCE MIN	PRE-TRAVEL MAX	DIFFERENTIAL TRAVEL MAX	OVER-TRAVEL MIN	OPERATING POSITION	FREE POSITION
			grams OUNCES	grams OUNCES	mm INCHES	mm INCHES	mm INCHES	mm INCHES	mm INCHES
SILVER	PIN PLUNGER	(A)	100 3.527	10 .353	0.3 .012	0.1 .004	0.1 .004	5.40 ± 0.15 .213 ± .006	5.80 .228
	FLAT LEVER	(A)	25 .862	2.0 .035	2.4 .094	0.7 .028	0.4 .016	6.40 ± 0.60 .252 ± .024	9.00 .354
	SIM ROLLER LEVER	US20D10E00	30 1.058	2.0 .035	2.2 .087	0.7 .028	0.3 .012	6.70 ± 0.50 .264 ± .020	9.40 .370
GOLD	PIN PLUNGER	(A)	100 3.527	10 .353	0.3 .012	0.1 .004	0.1 .004	5.40 ± 0.15 .213 ± .006	5.80 .228
	FLAT LEVER	US10D10C00	25 .862	2.0 .035	2.4 .094	0.7 .028	0.4 .016	6.40 ± 0.60 .252 ± .024	9.00 .354
	SIM ROLLER LEVER	US10D10E00	30 1.058	2.0 .035	2.2 .087	0.7 .028	0.3 .012	6.70 ± 0.50 .264 ± .020	9.40 .370

THIRD ANGLE PROJECTION

SCALE 6 : 1

DO NOT SCALE PRINT

TOLERANCES

APPLY TO DESIGN UNITS. CONVERSIONS ARE ONLY FOR REFERENCE. UNLESS NOTES, TOLERANCES ARE:

NO PLACES	1 PLACE	TWO PLACES	THREE PLACES	SI METRIC	US CUSTOMARY
1	0.1 / .04	0.01 / .001	0.001 / .0001	<input checked="" type="checkbox"/>	<input type="checkbox"/>

DESIGN UNITS:  SI METRIC  US CUSTOMARY

WEIGHT

ANSI Y14.5M-1982 APPLIES