

CW-B1672

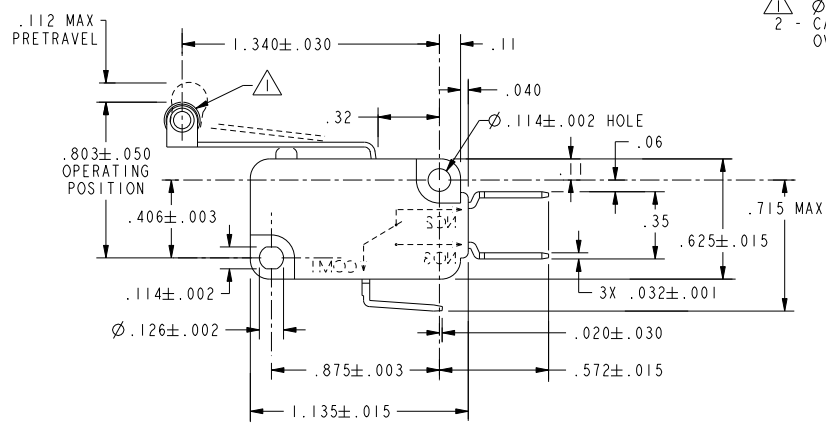
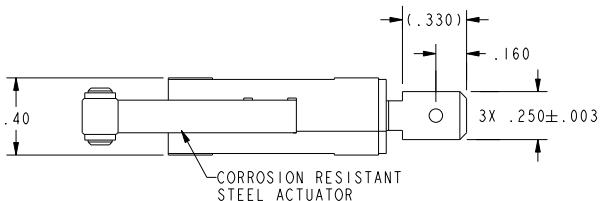

NOTES
 1 - \varnothing .19 X .19 WIDE OIL BRONZE ROLLER (CONCENTRICITY .005 FIM)
 2 - CAUTION: OVERTRAVEL FORCE ON LEVER MUST NOT RESULT IN AN OVERTRAVEL FORCE ON PLUNGER EXCEEDING 5 POUNDS

CHARACTERISTICS OPERATING FORCE---- 86 GRAMS MAX RELEASE FORCE ----- 9 GRAMS MIN DIFFERENTIAL TRAVEL ---- .025 MAX OVERTRAVEL ----- .064 MIN RELEASE TRAVEL ----- .016 MIN		ELECTRICAL DATA CONTACT ARRANGEMENT S P D T L215 15.1A 1/2HP 125, 250 OR 277 VAC 1/2A 125 VDC 1/4A 250 VDC; 5A 125 VAC "L" 		UNLESS OTHERWISE SPECIFIED TOLERANCES ARE: NO PLACE X ±.040 ±1 ONE PLACE .X ±.030 ±0,4 TWO PLACE .XX ±.015 ±0,15 THREE PLACE .XXX ±.005 ± ANGLES ± RAW MATERIAL-COMMERCIAL STANDARD THIRD ANGLE PROJECTION 		DRAWN TSM 7FEB03 CHECK SAV 7FEB03 THIS DRAWING COVERS A PROPRIETARY ITEM AND IS THE PROPERTY OF HONEYWELL. THIS DRAWING IS NOT TO BE COPIED OR USED WITHOUT THE PERMISSION OF HONEYWELL. DIMENSIONS ARE TO BE MET BEFORE PROTECTIVE COATINGS ARE APPLIED PTC 2D ASME Y14.5M-1994		Honeywell TITLE SWITCH, BASIC SIZE DWG TYPE DRAWING NAME REV B I V7-1C17E9-207 4	
				SCALE 2:1		WEIGHT SHEET 1 OF 1			