

CW-B8438

REV	DOCUMENT	CHANGED BY	CHECK
2	202161	DCS 19 JAN 01	SAV

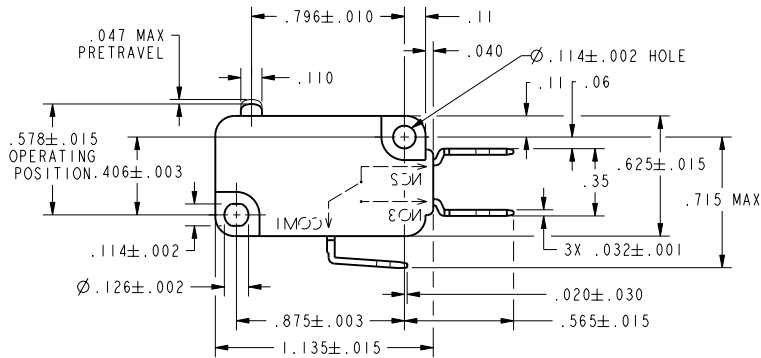
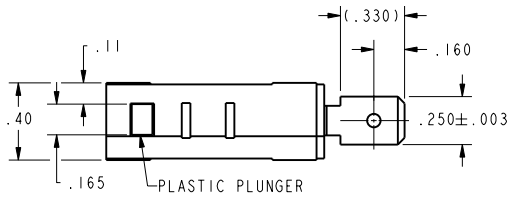

CHARACTERISTICS OPERATING FORCE --- 50 GRAMS MAX RELEASE FORCE --- 5 GRAMS MIN DIFFERENTIAL TRAVEL --- .002-.010 OVERTRAVEL --- .050 MIN FREE POSITION --- .625 MAX RELEASE TRAVEL --- .010 MIN		ELECTRICAL DATA CONTACT ARRANGEMENT S P D T L216 10A 1/3HP 125, 250 OR 277 VAC 1/2A 125 VDC 1/4A 250 VDC; 4A 125 VAC "L"		UNLESS OTHERWISE SPECIFIED TOLERANCES ARE: NO PLACE X ±.040 ±1 ONE PLACE .X ±.030 ±0.4 TWO PLACE .XX ±.015 ±0.15 THREE PLACE .XXX ±.005 ± ANGLES ± 5° ± RAW MATERIAL-COMMERCIAL STANDARD		DRAWN DCS 19 JAN 01 CHECK SAV 19 JAN 01		Honeywell Sensing and Control	
		THIRD ANGLE PROJECTION		THIS DRAWING COVERS A PROPRIETARY ITEM AND IS THE PROPERTY OF HONEYWELL SENSING AND CONTROL. THIS DRAWING IS NOT TO BE COPIED OR USED WITHOUT THE PERMISSION OF HONEYWELL.		TITLE SWITCH - BASIC		SIZE DWG TYPE DRAWING NAME REV B M V7-3E19E9 2	
		DIMENSIONS ARE TO BE MET BEFORE PROTECTIVE COATINGS ARE APPLIED		PTC 2D ASME Y14.5M-1994		SCALE 2:1 WEIGHT SHEET 1 OF 1			