

4

3

2

1

THIS DRAWING IS UNPUBLISHED. RELEASED FOR PUBLICATION
 BY TYCO ELECTRONICS CORPORATION. ALL RIGHTS RESERVED.

LOC	DIST	REVISIONS					
AD	00	F	LTR	DESCRIPTION	DATE	BY	APP'D
		A1		ECO-06-029077	05/FEB/2007	RB	MS

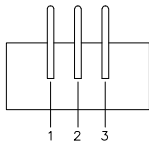
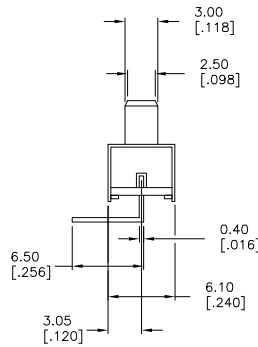
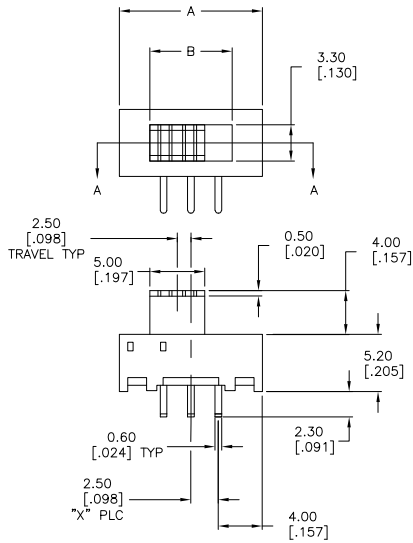

1825160-1 AS SHOWN

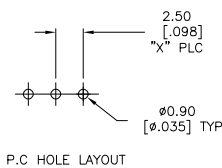

SPECIFICATIONS:
 MAKE-BEFORE-BREAK

MATERIALS:
 FRAME: STEEL, ZINC PLATE
 ACTUATOR: POM UL94HB, BLACK
 FIXED CONTACT/TERMINAL: COPPER ALLOY,
 SILVER OVER NICKEL PLATE
 MOVING CONTACT: COPPER ALLOY, SILVER CLAD
 COIL SPRING: TEMPERED STEEL WIRE
 BALL: TEMPERED CARBON STEEL
 TERMINAL BOARD: PHENOLIC, UL94HB
 TERMINAL SEAL: PHENOLIC RESIN

ELECTRICAL:
 CONTACT RATING: 250 MILLIAMPS@125V AC
 CONTACT RESISTANCE: 30 MILLIOHMS MAX (INITIAL),
 60 MILLIOHMS AFTER TEST
 INSULATION RESISTANCE: 500 MEGOHMS MIN AT 500V DC
 DIELECTRIC STRENGTH: 500 VAC RMS AT SEA LEVEL
 LIFE EXPECTANCY: 10,000 CYCLES MIN. NO LOAD

MECHANICAL:
 ACTUATION FORCE: 250 +150/-100 GRAMS
 TRAVEL: 2.49 (.098)

ENVIRONMENTAL:
 OPERATING TEMPERATURE: -10 TO +60 DEGREES C
 STORAGE TEMPERATURE: -10 TO +60 DEGREES C
 RESISTANCE TO SOLDER HEAT: 260 C FOR 10 SEC PER 109-202,
 COND. B
 SOLDERABILITY: PER EIA-364-56A, PROCEDURE 3, COND. B

NOTES:

1. ALL MATERIALS AND FINISHES SHALL COMPLY WITH EU DIRECTIVE 2002/95/EC OF 27JAN2003 (ROHS)
2. SEE SHEET 2 FOR FUNCTION DIAGRAM
3. ALL PERFORMANCE SPECIFICATIONS WERE TESTED IN ACCORDANCE WITH JIS-C-5441 UNLESS OTHERWISE STATED.

6	17.50[.689]	23.01[.906]	SP6T	STS161RA04	1825160-5
5	15.01[.591]	20.50[.807]	SP5T	STS151RA04	1825160-4
4	12.50[.492]	18.01[.709]	SP4T	STS141RA04	1825160-3
3	10.01[.394]	15.50[.610]	SP3T	STS131RA04	1825160-2
2	7.49[.295]	13.00[.512]	SPDT	STS121RA04	1825160-1
X PLC	DIM B	DIM A	FUNCTION	T&B PART NUMBER	TYCO PART NUMBER

DIMENSIONS		TOLERANCES UNLESS OTHERWISE SPECIFIED		REMARKS	
mm	[INCHES]	Ø	PLC	±	—
		1	PLC	±	—
		2	PLC	±	—
		3	PLC	±	0.20 (.008)
		4	PLC	±	—
		5	PLC	±	—
		6	PLC	±	—
		7	PLC	±	—
		8	PLC	±	—
		9	PLC	±	—
		10	PLC	±	—
		11	PLC	±	—
		12	PLC	±	—
		13	PLC	±	—
		14	PLC	±	—
		15	PLC	±	—
		16	PLC	±	—
		17	PLC	±	—
		18	PLC	±	—
		19	PLC	±	—
		20	PLC	±	—
		21	PLC	±	—
		22	PLC	±	—
		23	PLC	±	—
		24	PLC	±	—
		25	PLC	±	—
		26	PLC	±	—
		27	PLC	±	—
		28	PLC	±	—
		29	PLC	±	—
		30	PLC	±	—
		31	PLC	±	—
		32	PLC	±	—
		33	PLC	±	—
		34	PLC	±	—
		35	PLC	±	—
		36	PLC	±	—
		37	PLC	±	—
		38	PLC	±	—
		39	PLC	±	—
		40	PLC	±	—
		41	PLC	±	—
		42	PLC	±	—
		43	PLC	±	—
		44	PLC	±	—
		45	PLC	±	—
		46	PLC	±	—
		47	PLC	±	—
		48	PLC	±	—
		49	PLC	±	—
		50	PLC	±	—
		51	PLC	±	—
		52	PLC	±	—
		53	PLC	±	—
		54	PLC	±	—
		55	PLC	±	—
		56	PLC	±	—
		57	PLC	±	—
		58	PLC	±	—
		59	PLC	±	—
		60	PLC	±	—
		61	PLC	±	—
		62	PLC	±	—
		63	PLC	±	—
		64	PLC	±	—
		65	PLC	±	—
		66	PLC	±	—
		67	PLC	±	—
		68	PLC	±	—
		69	PLC	±	—
		70	PLC	±	—
		71	PLC	±	—
		72	PLC	±	—
		73	PLC	±	—
		74	PLC	±	—
		75	PLC	±	—
		76	PLC	±	—
		77	PLC	±	—
		78	PLC	±	—
		79	PLC	±	—
		80	PLC	±	—
		81	PLC	±	—
		82	PLC	±	—
		83	PLC	±	—
		84	PLC	±	—
		85	PLC	±	—
		86	PLC	±	—
		87	PLC	±	—
		88	PLC	±	—
		89	PLC	±	—
		90	PLC	±	—
		91	PLC	±	—
		92	PLC	±	—
		93	PLC	±	—
		94	PLC	±	—
		95	PLC	±	—
		96	PLC	±	—
		97	PLC	±	—
		98	PLC	±	—
		99	PLC	±	—
		100	PLC	±	—

THIS DRAWING IS A CONTROLLED DOCUMENT.		REVISIONS		TYCO ELECTRONICS CORPORATION	
DRAWN BY: S.S. VISWESWARA		DATE: 05/FEB/2007		1825160-5	
CHECKED BY: M.S. SARVER		DESCRIPTION: SLIDE SWITCH, STS121RA TO STS161RA SERIES		1825160-4	
APPROVED BY: [Signature]		PART NUMBER: 1825160		1825160-3	
MATERIAL: [Blank]		SCALE: 4:1		1825160-2	
FINISH: [Blank]		SHEET: 1 OF 2		1825160-1	
CUSTOMER DRAWING		REV: A1		1825160	

1825160

A

4

3

2

1

THIS DRAWING IS UNPUBLISHED. RELEASED FOR PUBLICATION
 © COPYRIGHT BY TYCO ELECTRONICS CORPORATION. ALL RIGHTS RESERVED.

LOC	DIST	REVISIONS					
AD	00	P	LWR	DESCRIPTION	DATE	OWN	APPD
		-	-	SEE SHEET 1	-	-	-

PART NUMBER	FUNCTION	BOTTOM VIEW
-------------	----------	-------------

FUNCTION DIAGRAM	
------------------	--

1825160-1	SPDT	
-----------	------	--

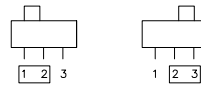

1825160-2	SP3T	
-----------	------	--

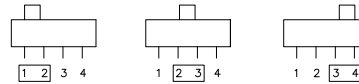

1825160-3	SP4T	
-----------	------	--

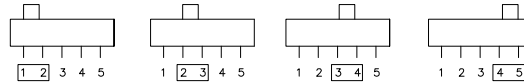

1825160-4	SP5T	
-----------	------	--

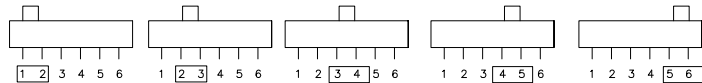

1825160-5	SP6T	
-----------	------	--

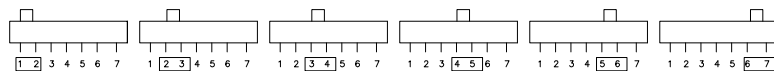

THIS DRAWING IS A CONTROLLED DOCUMENT.		DRN	S.S. VISWESWARA	REMARKS	
DIMENSIONS: mm [INCHES]		CHK	M.S. SARVER		
TOLERANCES UNLESS OTHERWISE SPECIFIED:		APPD			
0 PLC ±		PRODUCT SPEC			
1 PLC ±		APPLICATION SPEC			
2 PLC ± 0.20 (0.008)		WEIGHT			
3 PLC ±		FINISH			
4 PLC ±					
ANGLES ±					
MATERIAL					
FINISH					
		CUSTOMER DRAWING			
		SIZE	A2	CAGE CODE	00779
		DRAWING NO.	1825160		RESTRICTED TO
		SCALE	1:1	SHEET	2 OF 2
		REV	A1		

1825160

B

A