

### 4S1 & 4SS-Series

Sub-Miniature & **Sealed** Sub-Miniature Slide Switches

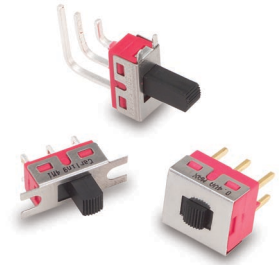

### 4M1-Series

Miniature Slide Switch

### Specifications

Contact Rating . . . . . refer to ordering scheme  
 Electrical Life . . . . . 30,000 make & break cycles at full load  
 Contact Resistance. . . . . 10 mΩ max. initial @ 2-4 VDC  
 100mA for both silver & gold plated contacts.  
 Insulation Resistance . . . 1000 MΩ min.  
 Dielectric Strength . . . . . 1500 Volts RMS @ sea level  
 Operating Temperature . . . -30°C to +85°C  
 Solder Heat Resistance. . . MIL-STD-202, Method 210  
 Actuator Travel . . . . . 25°

### Materials

Case . . . . . Diallyl phthalate (DAP) (UL 94V-0)  
 Slide Handle. . . . . Nylon  
 Housing. . . . . Stainless Steel  
 Terminal Seal . . . . . Epoxy

### 4S1-Series Ordering Scheme



<b>1 SERIES</b> <b>4S1</b> Sub-Miniature Slide Switch																
<b>2 POLES</b> <b>FSP</b> single pole																
<b>3 CIRCUIT</b> <table style="width: 100%; border-collapse: collapse;"> <tr> <td colspan="4" style="text-align: center;"><b>Switching Position:</b></td> </tr> <tr> <td style="width: 10%;"></td> <td style="width: 15%;">2-1</td> <td style="width: 20%;">OPEN</td> <td style="width: 15%;">2-3</td> </tr> <tr> <td><b>1</b></td> <td>ON</td> <td>NONE</td> <td>ON</td> </tr> <tr> <td><b>3</b></td> <td>ON</td> <td>OFF</td> <td>ON</td> </tr> </table>	<b>Switching Position:</b>					2-1	OPEN	2-3	<b>1</b>	ON	NONE	ON	<b>3</b>	ON	OFF	ON
<b>Switching Position:</b>																
	2-1	OPEN	2-3													
<b>1</b>	ON	NONE	ON													
<b>3</b>	ON	OFF	ON													
<b>4 TERMINATION</b> <b>M2</b> PCB <b>M6</b> PC Mount, 90° horizontal																

<b>5 CONTACT</b>		
<i>Material</i>	<i>Terminal Plating</i>	<i>Rating</i>
<b>G</b> silver <sup>1</sup>	gold over silver <sup>3</sup>	3A@125VAC or 28VDC; 1.5A @ 250VAC
<b>K</b> gold <sup>2</sup>	tin-lead <sup>4</sup>	0.4VA max. @20V max (AC/DC)
<b>P</b> silver <sup>1</sup>	tin-lead <sup>4</sup>	3A@125VAC or 28VDC; 1.5A @ 250VAC
<b>Q</b> silver <sup>1</sup>	silver <sup>1</sup>	3A@125VAC or 28VDC; 1.5A @ 250VAC
<b>R</b> gold <sup>2</sup>	gold <sup>2</sup>	0.4VA max. @20V max (AC/DC)
NOTE: Tin-lead option available with PC type terminations only. 1 Moveable contact & terminals: copper alloy, silver plate 2 Moveable contact & terminals: copper alloy with gold plate over nickel plate 3 Terminals: silver plate with outer layer in gold plating		

<b>6 EPOXY SEAL</b> <b>E</b> epoxy seal
--

<b>7 PACKAGING</b> Switches are bulk packed, unless T/R is specified at the end of the part number. <b>T/R</b> tape reel - 500 pieces per reel
--

### 4SS-Series Ordering Scheme



<b>1 SERIES</b> <b>4SS</b> Sealed Sub-Miniature Slide Switch																
<b>2 POLES</b> <b>FSP</b> single pole																
<b>3 CIRCUIT</b> <table style="width: 100%; border-collapse: collapse;"> <tr> <td colspan="4" style="text-align: center;"><b>Switching Position:</b></td> </tr> <tr> <td></td> <td style="text-align: center;">2-1</td> <td style="text-align: center;">OPEN</td> <td style="text-align: center;">2-3</td> </tr> <tr> <td style="text-align: center;"><b>1</b></td> <td style="text-align: center;">ON</td> <td style="text-align: center;">NONE</td> <td style="text-align: center;">ON</td> </tr> <tr> <td style="text-align: center;"><b>3</b></td> <td style="text-align: center;">ON</td> <td style="text-align: center;">OFF</td> <td style="text-align: center;">ON</td> </tr> </table>	<b>Switching Position:</b>					2-1	OPEN	2-3	<b>1</b>	ON	NONE	ON	<b>3</b>	ON	OFF	ON
<b>Switching Position:</b>																
	2-1	OPEN	2-3													
<b>1</b>	ON	NONE	ON													
<b>3</b>	ON	OFF	ON													
<b>4 TERMINATION</b> <b>Termination options for switches with brick color actuators</b> <b>M2</b> PCB <b>M6</b> PC Mount, 90° horizontal <b>M7</b> PC Mount, 90° vertical <b>Termination options for switches with white color actuators</b> <b>L6</b> Surface Mount, 90° flat <b>S6</b> Surface Mount, 90° horizontal <b>S7</b> Surface Mount, 90° vertical																

<b>5 CONTACT</b> <table style="width: 100%; border-collapse: collapse;"> <thead> <tr> <th style="text-align: left;">Material</th> <th style="text-align: left;">Terminal Plating</th> <th style="text-align: left;">Rating</th> </tr> </thead> <tbody> <tr> <td><b>G</b> silver<sup>1</sup></td> <td>gold over silver</td> <td>3A@125VAC or 28VDC; 1.5A @ 250VAC</td> </tr> <tr> <td><b>K</b> gold<sup>2</sup></td> <td>tin-lead<sup>4</sup></td> <td>0.4VA max. @20V max (AC/DC)</td> </tr> <tr> <td><b>P</b> silver<sup>1</sup></td> <td>tin-lead</td> <td>3A@125VAC or 28VDC; 1.5A @ 250VAC</td> </tr> <tr> <td><b>R</b> gold<sup>2</sup></td> <td>gold<sup>2</sup></td> <td>0.4VA max. @20V max (AC/DC)</td> </tr> </tbody> </table> <p>NOTE:            Tin-lead option available with PC type terminations only.            1 Moveable contact &amp; terminals: copper alloy, silver plate            2 Moveable contact &amp; terminals: copper alloy with gold plate over nickel plate            3 Terminals: silver plate with outer layer in gold plating            4 Outer terminals: copper alloy with tin-lead over nickel plate</p>	Material	Terminal Plating	Rating	<b>G</b> silver <sup>1</sup>	gold over silver	3A@125VAC or 28VDC; 1.5A @ 250VAC	<b>K</b> gold <sup>2</sup>	tin-lead <sup>4</sup>	0.4VA max. @20V max (AC/DC)	<b>P</b> silver <sup>1</sup>	tin-lead	3A@125VAC or 28VDC; 1.5A @ 250VAC	<b>R</b> gold <sup>2</sup>	gold <sup>2</sup>	0.4VA max. @20V max (AC/DC)
Material	Terminal Plating	Rating													
<b>G</b> silver <sup>1</sup>	gold over silver	3A@125VAC or 28VDC; 1.5A @ 250VAC													
<b>K</b> gold <sup>2</sup>	tin-lead <sup>4</sup>	0.4VA max. @20V max (AC/DC)													
<b>P</b> silver <sup>1</sup>	tin-lead	3A@125VAC or 28VDC; 1.5A @ 250VAC													
<b>R</b> gold <sup>2</sup>	gold <sup>2</sup>	0.4VA max. @20V max (AC/DC)													
<b>6 EPOXY SEAL</b> <b>E</b> epoxy seal															
<b>7 PACKAGING</b> Switches are bulk packed, unless <b>T/R</b> is specified at the end of the part number. <b>T/R</b> tape reel - 500 pieces per reel															

### 4M1-Series Ordering Scheme

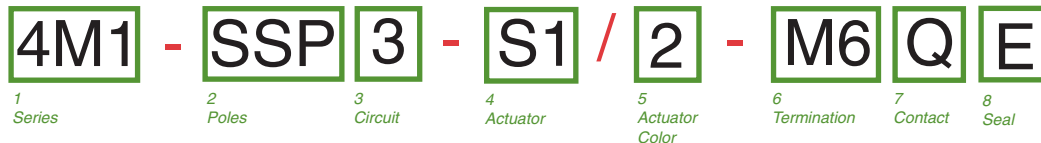

<b>1 SERIES</b> <b>4M1</b> Miniature Slide Switch																
<b>2 POLES</b> <b>SSP</b> single pole <span style="float: right;"><b>SDP</b> double pole</span>																
<b>3 CIRCUIT</b> <table style="width: 100%; border-collapse: collapse;"> <tr> <td colspan="4" style="text-align: center;"><b>Switching Position</b></td> </tr> <tr> <td></td> <td style="text-align: center;">2-1, 5-4</td> <td style="text-align: center;">OPEN</td> <td style="text-align: center;">2-3, 5-6</td> </tr> <tr> <td style="text-align: center;"><b>1</b></td> <td style="text-align: center;">ON</td> <td style="text-align: center;">NONE</td> <td style="text-align: center;">ON</td> </tr> <tr> <td style="text-align: center;"><b>3</b></td> <td style="text-align: center;">ON</td> <td style="text-align: center;">OFF</td> <td style="text-align: center;">ON</td> </tr> </table>	<b>Switching Position</b>					2-1, 5-4	OPEN	2-3, 5-6	<b>1</b>	ON	NONE	ON	<b>3</b>	ON	OFF	ON
<b>Switching Position</b>																
	2-1, 5-4	OPEN	2-3, 5-6													
<b>1</b>	ON	NONE	ON													
<b>3</b>	ON	OFF	ON													
<b>4 ACTUATOR</b> <table style="width: 100%; border-collapse: collapse;"> <tr><td><b>S1</b> .201 [5.10] high</td></tr> <tr><td><b>S2</b> .285 [7.25] high</td></tr> <tr><td><b>S3</b> .370 [9.40] high</td></tr> <tr><td><b>S4</b> .140 [3.55] high</td></tr> <tr><td><b>S5</b> .053 [1.35] high (for DPDT only)</td></tr> <tr><td><b>S6</b> .482 [12.25] high</td></tr> <tr><td><b>S7</b> .311 [7.90] high</td></tr> <tr><td><b>T1</b> .201 [5.10] high (for DPDT only)</td></tr> </table>	<b>S1</b> .201 [5.10] high	<b>S2</b> .285 [7.25] high	<b>S3</b> .370 [9.40] high	<b>S4</b> .140 [3.55] high	<b>S5</b> .053 [1.35] high (for DPDT only)	<b>S6</b> .482 [12.25] high	<b>S7</b> .311 [7.90] high	<b>T1</b> .201 [5.10] high (for DPDT only)								
<b>S1</b> .201 [5.10] high																
<b>S2</b> .285 [7.25] high																
<b>S3</b> .370 [9.40] high																
<b>S4</b> .140 [3.55] high																
<b>S5</b> .053 [1.35] high (for DPDT only)																
<b>S6</b> .482 [12.25] high																
<b>S7</b> .311 [7.90] high																
<b>T1</b> .201 [5.10] high (for DPDT only)																
<b>5 ACTUATOR COLOR<sup>1</sup></b> <table style="width: 100%; border-collapse: collapse;"> <tr> <td style="text-align: center;"><b>1</b> white</td> <td style="text-align: center;"><b>3</b> red</td> <td style="text-align: center;"><b>5</b> yellow</td> <td style="text-align: center;"><b>7</b> blue</td> <td style="text-align: center;"><b>9</b> gray</td> </tr> <tr> <td style="text-align: center;"><b>2</b> black</td> <td style="text-align: center;"><b>4</b> orange</td> <td style="text-align: center;"><b>6</b> green</td> <td style="text-align: center;"><b>8</b> brown</td> <td></td> </tr> </table> <p><small>1 White, black &amp; red are standard. Other colors available for quantities of 5K or more.</small></p>	<b>1</b> white	<b>3</b> red	<b>5</b> yellow	<b>7</b> blue	<b>9</b> gray	<b>2</b> black	<b>4</b> orange	<b>6</b> green	<b>8</b> brown							
<b>1</b> white	<b>3</b> red	<b>5</b> yellow	<b>7</b> blue	<b>9</b> gray												
<b>2</b> black	<b>4</b> orange	<b>6</b> green	<b>8</b> brown													

<b>6 TERMINATION</b> <table style="width: 100%; border-collapse: collapse;"> <tbody> <tr> <td><b>M1</b> Solder Lug</td> <td><b>M5-3</b> Wire Wrap [10.80]</td> </tr> <tr> <td><b>M2</b> PCB</td> <td><b>M5-4</b> Wire Wrap [26.97]</td> </tr> <tr> <td><b>M3</b> Quick Connect</td> <td><b>M6</b> PC Mount, 90° horizontal</td> </tr> <tr> <td><b>M5-1</b> Wire Wrap .750 [19.05]</td> <td><b>M7</b> PC Mount, 90° vertical</td> </tr> <tr> <td><b>M5-2</b> Wire Wrap [24.48]</td> <td><b>VS2</b> PC Mount, U bracket, .620 mounting x .460 high</td> </tr> </tbody> </table>	<b>M1</b> Solder Lug	<b>M5-3</b> Wire Wrap [10.80]	<b>M2</b> PCB	<b>M5-4</b> Wire Wrap [26.97]	<b>M3</b> Quick Connect	<b>M6</b> PC Mount, 90° horizontal	<b>M5-1</b> Wire Wrap .750 [19.05]	<b>M7</b> PC Mount, 90° vertical	<b>M5-2</b> Wire Wrap [24.48]	<b>VS2</b> PC Mount, U bracket, .620 mounting x .460 high														
<b>M1</b> Solder Lug	<b>M5-3</b> Wire Wrap [10.80]																							
<b>M2</b> PCB	<b>M5-4</b> Wire Wrap [26.97]																							
<b>M3</b> Quick Connect	<b>M6</b> PC Mount, 90° horizontal																							
<b>M5-1</b> Wire Wrap .750 [19.05]	<b>M7</b> PC Mount, 90° vertical																							
<b>M5-2</b> Wire Wrap [24.48]	<b>VS2</b> PC Mount, U bracket, .620 mounting x .460 high																							
<b>7 CONTACT</b> <table style="width: 100%; border-collapse: collapse;"> <thead> <tr> <th style="text-align: left;">Material</th> <th style="text-align: left;">Terminal Plating</th> <th style="text-align: left;">Rating</th> <th style="text-align: left;">Approvals</th> </tr> </thead> <tbody> <tr> <td><b>G</b> silver<sup>1</sup></td> <td>gold over silver<sup>2</sup></td> <td>5A@125VAC or 28VDC; 2A @ 250VAC</td> <td>UL, CSA</td> </tr> <tr> <td><b>K</b> gold<sup>2</sup></td> <td>tin-lead<sup>4</sup></td> <td>0.4VA max. @20V max (AC/DC)</td> <td></td> </tr> <tr> <td><b>P</b> silver<sup>1</sup></td> <td>tin-lead<sup>4</sup></td> <td>5A@125VAC or 28VDC; 2A @ 250VAC</td> <td>UL, CSA</td> </tr> <tr> <td><b>Q</b> silver<sup>1</sup></td> <td>silver<sup>1</sup></td> <td>5A@125VAC or 28VDC; 2A @ 250VAC</td> <td>UL, CSA</td> </tr> <tr> <td><b>R</b> gold<sup>2</sup></td> <td>gold<sup>2</sup></td> <td>0.4VA max. @20V max (AC/DC)</td> <td></td> </tr> </tbody> </table> <p>NOTE:            Tin-lead option available with PC type terminations only.            1 Moveable contact &amp; terminals: copper alloy, silver plate            2 Moveable contact &amp; terminals: copper alloy with gold plate over nickel plate            3 Terminals: silver plate with outer layer in gold plating            4 Outer terminals: copper alloy with tin-lead over nickel plate</p>	Material	Terminal Plating	Rating	Approvals	<b>G</b> silver <sup>1</sup>	gold over silver <sup>2</sup>	5A@125VAC or 28VDC; 2A @ 250VAC	UL, CSA	<b>K</b> gold <sup>2</sup>	tin-lead <sup>4</sup>	0.4VA max. @20V max (AC/DC)		<b>P</b> silver <sup>1</sup>	tin-lead <sup>4</sup>	5A@125VAC or 28VDC; 2A @ 250VAC	UL, CSA	<b>Q</b> silver <sup>1</sup>	silver <sup>1</sup>	5A@125VAC or 28VDC; 2A @ 250VAC	UL, CSA	<b>R</b> gold <sup>2</sup>	gold <sup>2</sup>	0.4VA max. @20V max (AC/DC)	
Material	Terminal Plating	Rating	Approvals																					
<b>G</b> silver <sup>1</sup>	gold over silver <sup>2</sup>	5A@125VAC or 28VDC; 2A @ 250VAC	UL, CSA																					
<b>K</b> gold <sup>2</sup>	tin-lead <sup>4</sup>	0.4VA max. @20V max (AC/DC)																						
<b>P</b> silver <sup>1</sup>	tin-lead <sup>4</sup>	5A@125VAC or 28VDC; 2A @ 250VAC	UL, CSA																					
<b>Q</b> silver <sup>1</sup>	silver <sup>1</sup>	5A@125VAC or 28VDC; 2A @ 250VAC	UL, CSA																					
<b>R</b> gold <sup>2</sup>	gold <sup>2</sup>	0.4VA max. @20V max (AC/DC)																						
<b>8 EPOXY SEAL</b> <span style="float: right;"><b>E</b> epoxy seal</span>																								

**4S-Series Dimensional Specifications: in. [mm]**

**4S1-Series**

**TERMINATION**

**PC MOUNTING**

**M2**

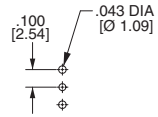
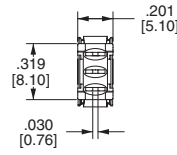
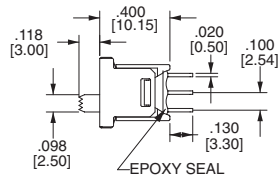
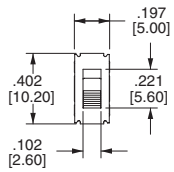

**M6**

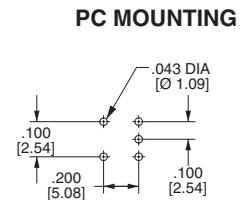
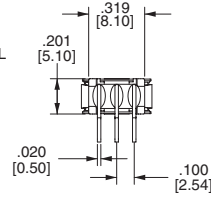
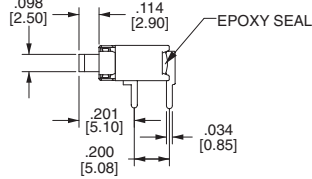
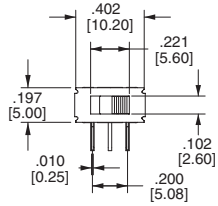

**4SS-Series**

**TERMINATION**

**PC MOUNTING**

**M2**

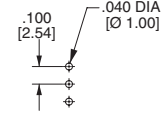
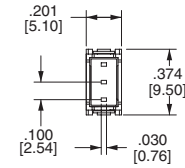
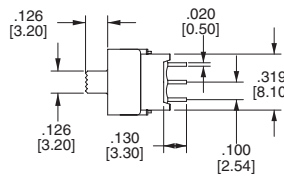
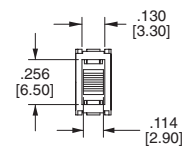

**M6**

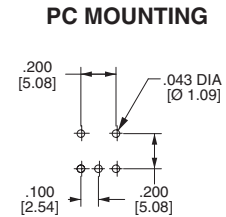
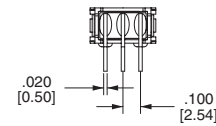
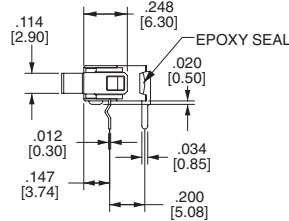
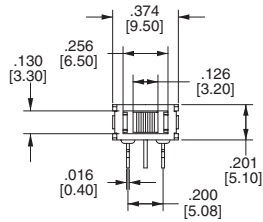

**M7**

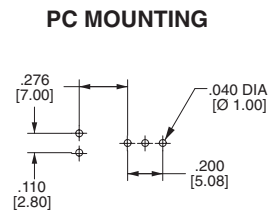
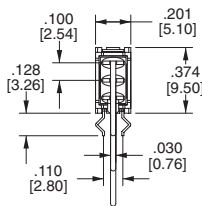
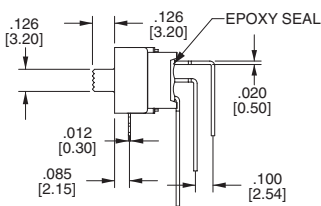
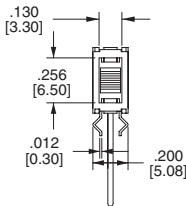

**L6**

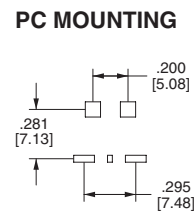
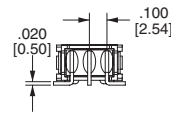
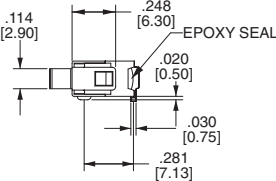
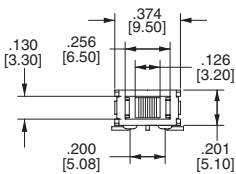

**4SS-Series Dimensional Specifications: in. [mm]**

**TERMINATION**

**S6**

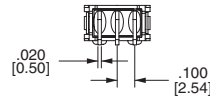
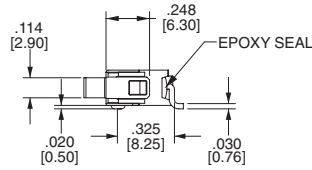
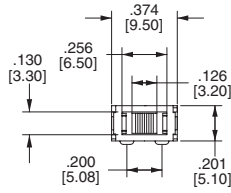

**PC MOUNTING**

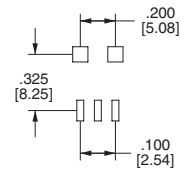

**S7**

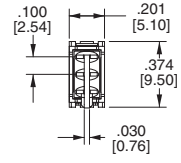
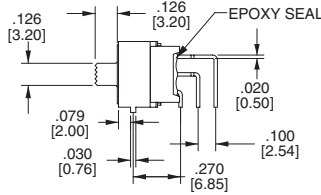
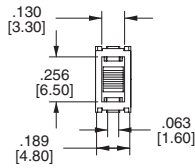

**PC MOUNTING**

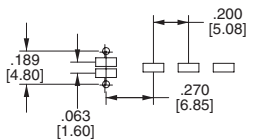

**REEL TAPING**

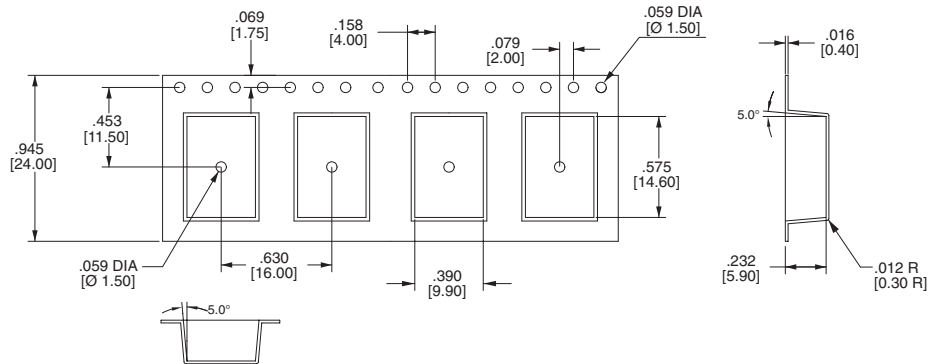

**FOR S6, L6 ONLY**

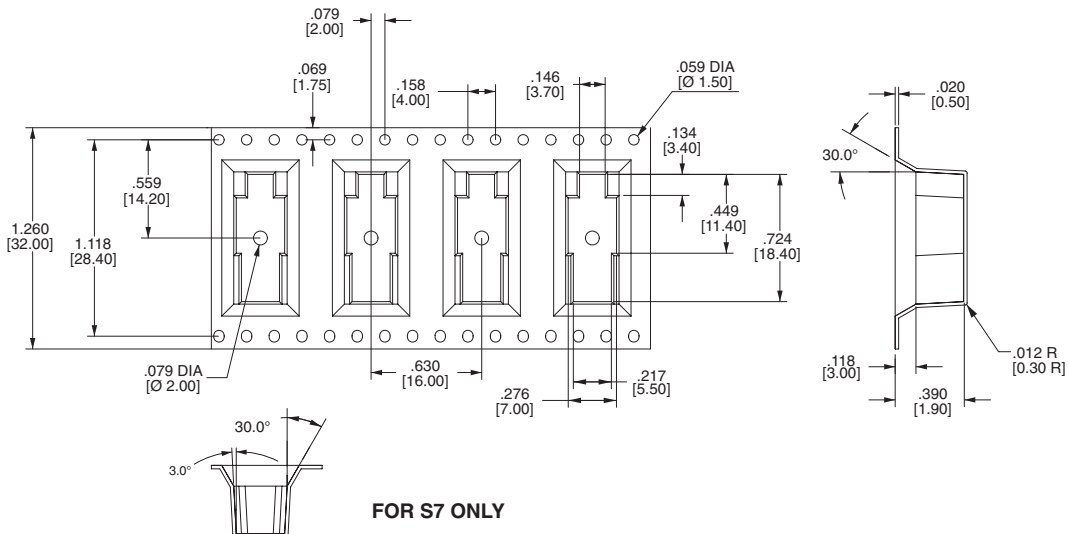

**FOR S7 ONLY**

## 4M1-Series Dimensional Specifications: in. [mm]

### ACTUATOR

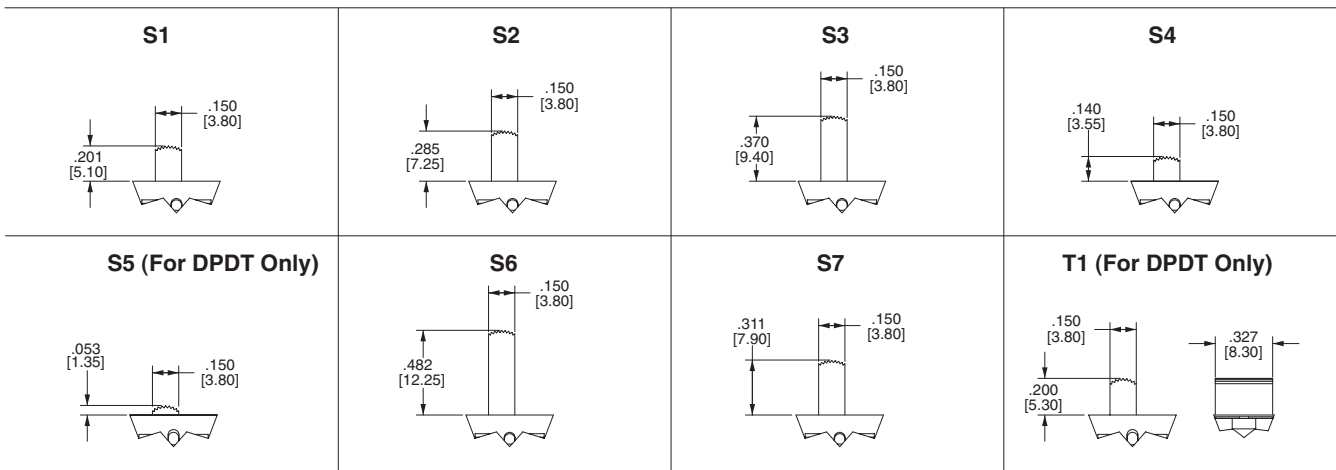

### TERMINATION

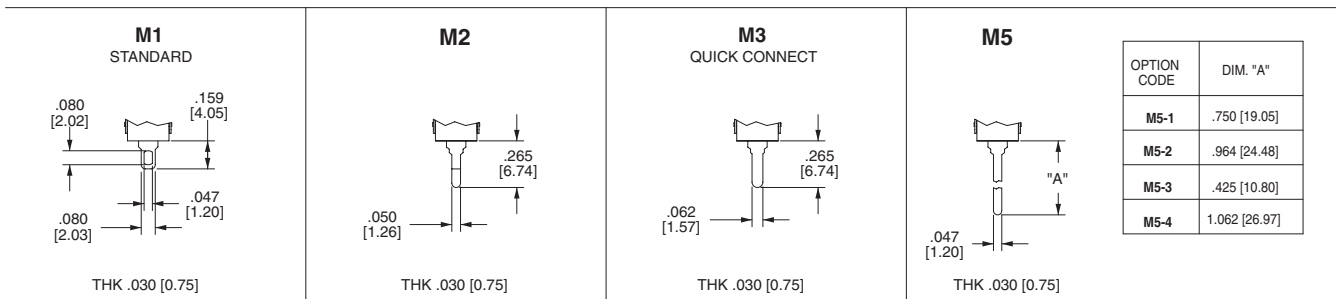

### SINGLE POLE

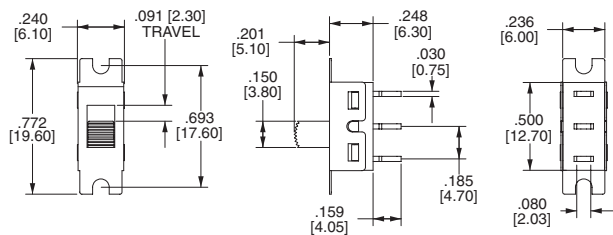

### DOUBLE POLE

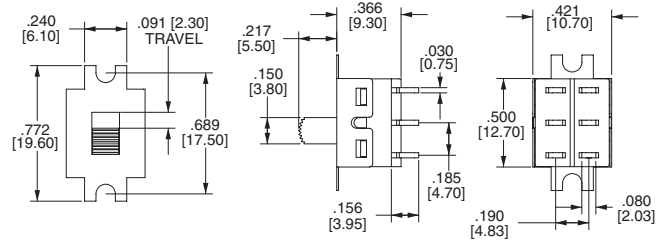

### M6

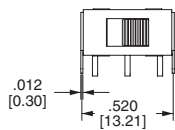

### SINGLE POLE

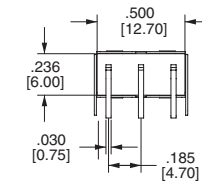
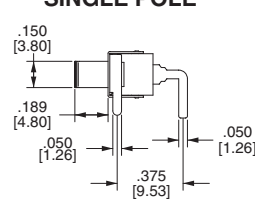

### PC MOUNTING

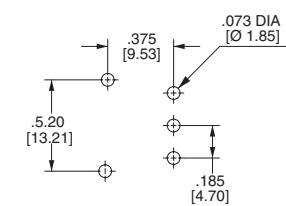

### DOUBLE POLE

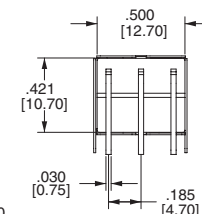
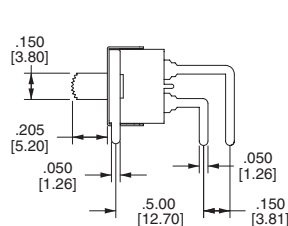

### PC MOUNTING

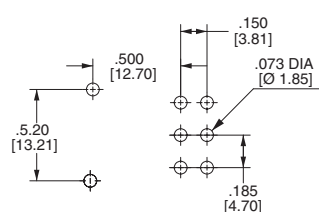

**4M1-Series Dimensional Specifications: in. [mm]**

**TERMINATION**

**M7**

**SINGLE POLE**

**PC MOUNTING**

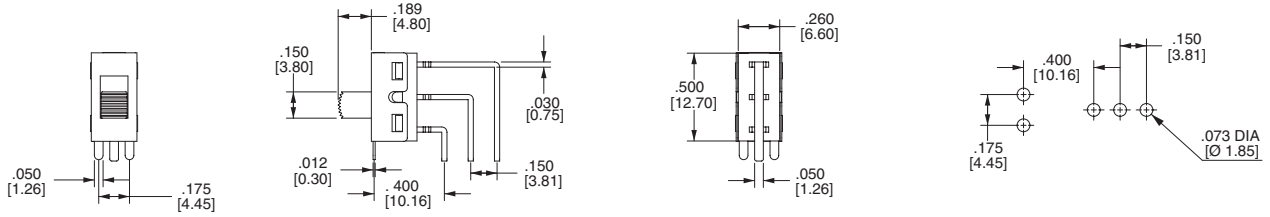

**DOUBLE POLE**

**PC MOUNTING**

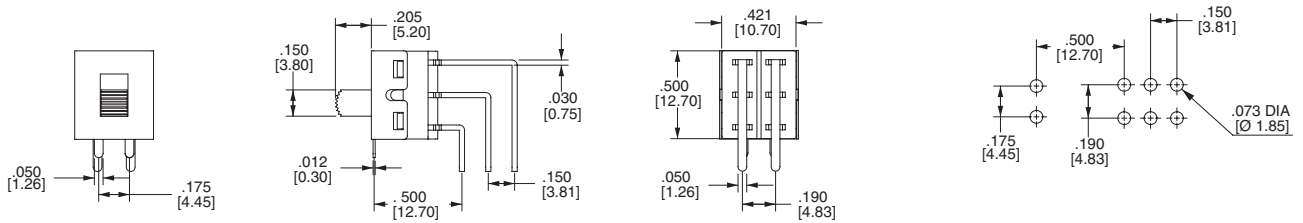

**VS2**

**SINGLE POLE**

**PC MOUNTING**

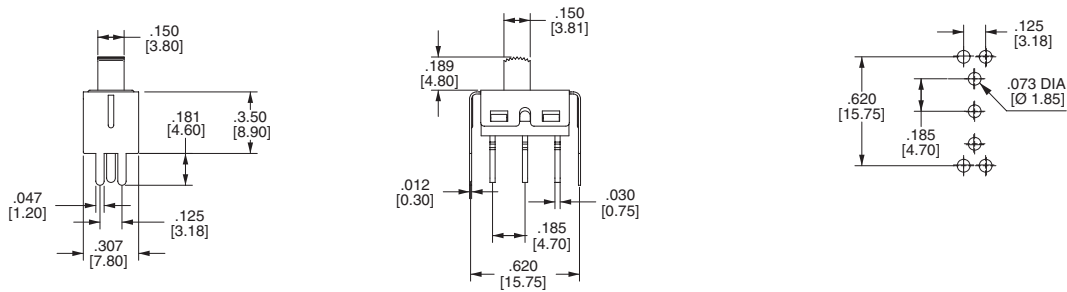

**DOUBLE POLE**

**PC MOUNTING**

