

RECOMMENDED P.C.B. LAYOUT (SCALE 5:1)

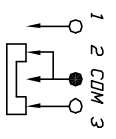
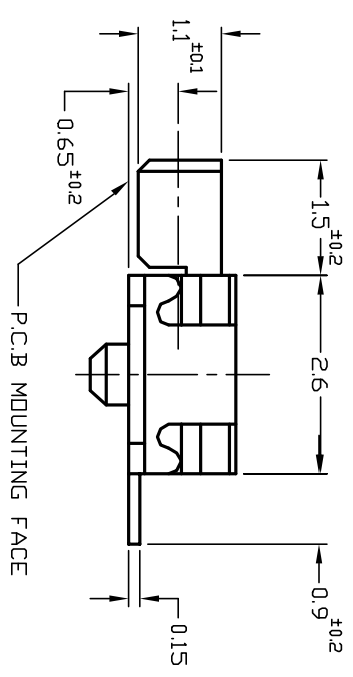
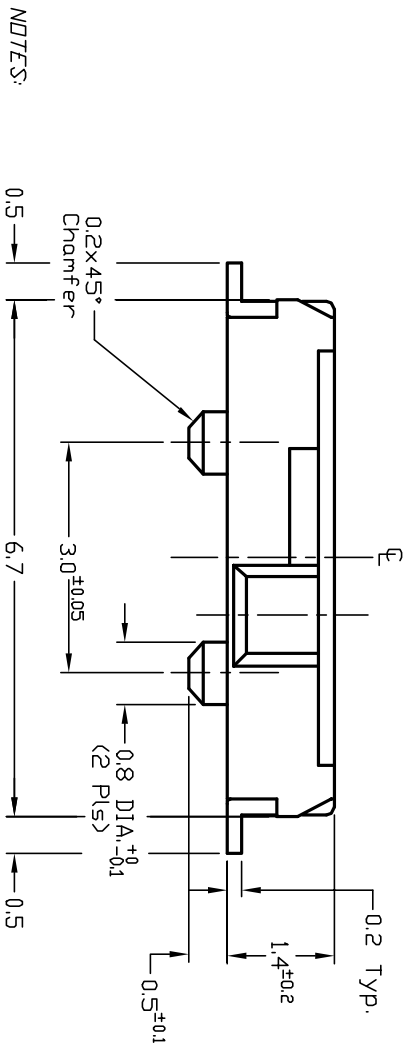

CIRCUIT: SP2T
CONTACT CONFIGURATION

NOTES:

1. ALL DIMENSIONS IN MM
2. TERM. NOS. FOR REF ONLY
3. RATING: DC 4V, 0.3A
4. OPERATING FORCE: 200±100gf
5. CONTACT RESISTANCE: 70m Ohms Max.
6. INSULATION RESISTANCE: DC 100V-100M Ohms Min
7. WITHSTAND VOLTAGE: AC 100V-1MINUTE
8. OPERATING TEMP: -20°C to +70°C
9. LIFE: 10,000 Cycles min.

E	12175	ADD NOTE 8 & 9	CJB
D	11271	REMOVED DIMENSION	CJB
REV.	ECN No.	DESCRIPTION	DATE
		CHKD	

SCALE	10:1	DATE	8/27/97	DR	MM	DWG	P112221	REV	E
TITLE	E-SWITCH®								
TITLE	EG 1257								

THE INFORMATION CONTAINED IN THIS DOCUMENT IS PROPRIETARY TO E-SWITCH AND IS NOT TO BE COPIED OR TRANSFERRED