

THIS DRAWING IS UNPUBLISHED
 ALL RIGHTS RESERVED

REV	DATE	DESCRIPTION	BY	CHK
AD	0	REVISED PER EDD-11-004587	11MR11	RK HMR

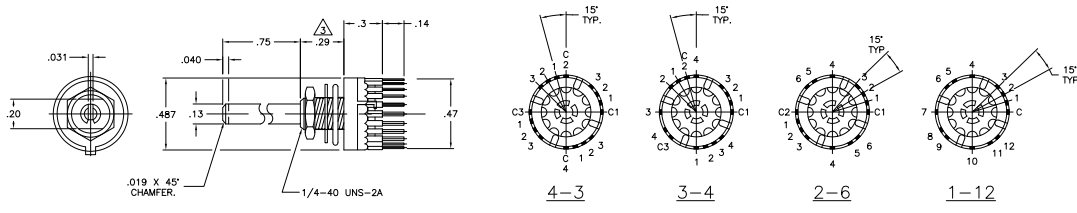

SPECIFICATIONS	
RATING	.4VA MAX. @ 20VDC, OR PEAK AC
TIMING	BREAK BEFORE MAKE
INITIAL CONTACT RESISTANCE	30 MILLIOHMS MAX
INSULATION RESISTANCE	10,000 MEGOHMS MIN
DIELECTRIC WITHSTANDING VOLTAGE	1,000 VRMS AT SEA LEVEL
DURABILITY	10,000 CYCLES @ .4VA RESISTIVE 30,000 CYCLES @ .1VA 12VDC RESISTIVE
OPERATING FORCE	14 INCH OUNCES
OPERATING TEMPERATURE	-20°C TO +70°C
STORAGE TEMPERATURE	-20°C TO +70°C

- NOTES:
1. TERMINAL NUMBERS ARE FOR REFERENCE ONLY AND DO NOT APPEAR ON SWITCHES.
 2. ALL MATERIALS AND FINISHES SHALL COMPLY WITH EU DIRECTIVE 2002/95/EC OF 27JAN2003 (ROHS).
 3. EACH SWITCH SUPPLIED WITH THE FOLLOWING MOUNTING HARDWARE:
 (1) HEX NUTS.
 (1) O-RING
 (1) INTERNAL TOOTH LOCKWASHER.

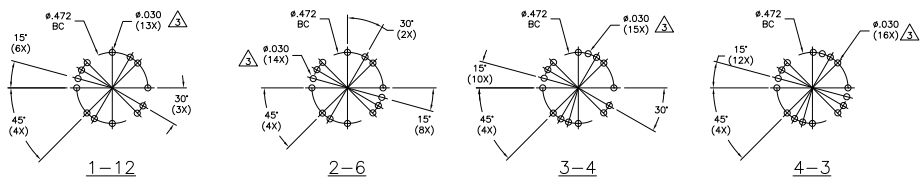

RECOMMENDED PCB HOLE LAYOUTS (VIEWED FROM SHAFT END)
 TOLERANCE ±.002, UNLESS OTHERWISE NOTED.

MATERIALS		
COMPONENT NAME	BASE MATERIAL	FINISH
BASE	EPOXY	--
FIXED CONTACT	BRASS	GOLD OVER NICKEL
TERMINALS	BRASS	PRE-TIN OVER NICKEL
MOVEABLE CONTACT	PHOSPHOR BRONZE	GOLD OVER NICKEL
ROTOR	PBT	--
BALL	STEEL	--
SPRING	PIANO WIRE	--
STOPPER	STEEL	ZINC
BUSHING	ZINC	NICKEL
SHAFT	BRASS	NICKEL
O-RING	NEOPRENE	--
HEX NUT	BRASS	NICKEL
INTERNAL TOOTH LOCKWASHER	STEEL	ZINC

MOVABLE CONTACT FINISH	FIXED CONTACT FINISH	TERMINAL FINISH	POSITION	POLES	ALCID P/N	PART NUMBER
.00010μ" MIN Au OVER .000120μ" MIN Ni	.00004μ" MIN Au OVER .000070μ" MIN Ni	PRE-TIN OVER NICKEL	3 FIXED	4	MRJ4304	1825537-4
.00010μ" MIN Au OVER .000120μ" MIN Ni	.00004μ" MIN Au OVER .000070μ" MIN Ni	PRE-TIN OVER NICKEL	4 FIXED	3	MRJ3404	1825537-3
.00010μ" MIN Au OVER .000120μ" MIN Ni	.00004μ" MIN Au OVER .000070μ" MIN Ni	PRE-TIN OVER NICKEL	6 FIXED	2	MRJ2604	1825537-2
.00010μ" MIN Au OVER .000120μ" MIN Ni	.00004μ" MIN Au OVER .000070μ" MIN Ni	PRE-TIN OVER NICKEL	12 CONTINUOUS ROTATION	1	MRJ1204	1825537-1

THIS DRAWING IS A CONTROLLED DOCUMENT.

TE Connectivity

MINIATURE ROTARY SWITCH
12 POS.-30 DEGREE DETENT

DATE: 00779 (G) 1825537

CUSTOMER DRAWING