

# C&K D Series Miniature Snap-in Power Rocker Switches



## Features/Benefits

- **Low cost**
- **Momentary and maintained models**
- **PC and quick connect terminals**
- **Recessed bracket available—prevents accidental actuation**

## Typical Applications

- **Computers**
- **Vacuum cleaners**
- **Coffee makers**

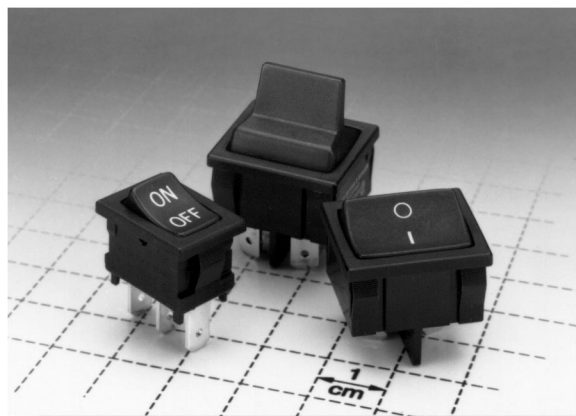

## Build-A-Switch

Our easy Build-A-Switch concept allows you to mix and match options to create the switch you need. Below is a complete listing of options shown in catalog. To order, simply select desired option from each category and place in the appropriate box. Switches with standard options are shown on page F-50. Available options are shown and described on pages F-50 thru F-52. For additional options not shown in catalog, consult Customer Service Center.

Typical Example: D 1 0 1 — J 1 — 2 — S 2 — 1 5 —   — Q A

### Switch Function

- D101** (STD.) SPDT, On-None-On
- D201** (STD.) DPDT, On-None-On
- D501** (STD.) SPDT, On-None-On
- D601** (STD.) DPDT, On-None-On
- D102** SPST, On-None-Off
- D103** SPDT, On-Off-On
- D105** SPDT, Mom.-Off-Mom.
- D108** SPDT, Mom.-None-On
- D202** DPST, On-None-Off
- D203** DPDT, On-Off-On
- D208** DPDT, Mom.-None-On
- D502** SPST, On-None-Off
- D503** SPDT, On-Off-On
- D508** SPDT, Mom.-None-On
- D602** DPST, On-None-Off
- D603** DPDT, On-Off-On
- D608** DPDT, Mom.-None-On

### Actuator

- J1** (STD.) Rocker
- J5** Lever

### Actuator Color

- 2** (STD.) Black
- 1** White
- 3** Red
- T** Beige

### Mounting Style/Color

- S2** (STD.) Snap-in, black
- B2** Recessed snap-in bracket, black
- S1** Snap-in, white
- S3** Snap-in, red
- ST** Snap-in, beige

### Terminations

- 15** (STD.) Quick connect
- A** Right angle, PC thru-hole
- 02** PC Thru-hole
- 05** Twisted quick connect
- 06** Extended PC thru-hole
- 17** Wirable quick connect

### Actuator Markings

- NONE** (STD.) No marking
- D** ON-OFF
- H** O I
- N** Large dot
- P** O -
- R** Red rectangle on end
- U** Large dot on end

### Contact Material

- QA** (STD.) Silver (UL/CSA)
- QF** (STD.) Silver (UL/CSA/VDE)

## Specifications

CONTACT RATING: D10X and D20X Models: 4 AMPS @ 125 V AC; 2 AMPS @ 250 V AC. D50X and D60X Models: 10 AMPS @ 125 V AC; 5 AMPS @ 250 V AC.

ELECTRICAL LIFE: 10,000 make-and-break cycles at full load.

INSULATION RESISTANCE: 10<sup>9</sup> ohms min.

DIELECTRIC STRENGTH: 1,000 V RMS min. @ sea level.

**NOTE:** Specifications and materials listed above are for standard switches. For information on specific and custom switches, consult Customer Service Center.

## Materials

ACTUATOR & HOUSING: 6/6 nylon (UL 94V-2), color black, standard; finish: matte.

MOVABLE CONTACTS: D10X and D20X Models: Copper, silver plated. D50X and D60X Models: Coin silver, silver plated.

STATIONARY CONTACTS AND TERMINALS: Copper or brass, silver plated.

CONTACT SPRING: Music wire or stainless steel.



# C&K D Series Miniature Snap-in Power Rocker Switches

## SWITCHES WITH STANDARD OPTIONS



D102J12S215QA  
SPDT

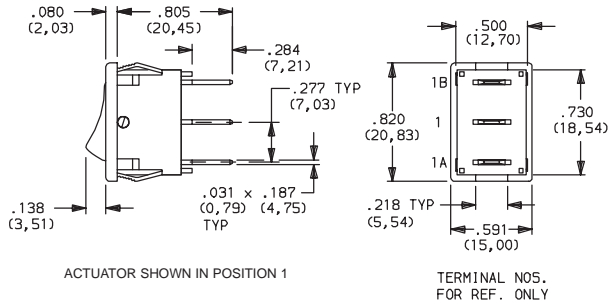

PART NUMBER	FUNCTION	POS. 1	POS. 2	POS. 3
D102J12S215QA	SPDT	ON	NONE	OFF
D501J12S215QA	SPDT	ON	NONE	ON
D502J12S215QA	SPST	ON	NONE	OFF

NOTE: For panel mounting information, see page F-51.

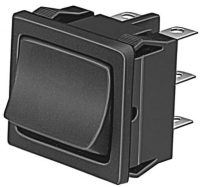

D201J12S215QA  
DPDT

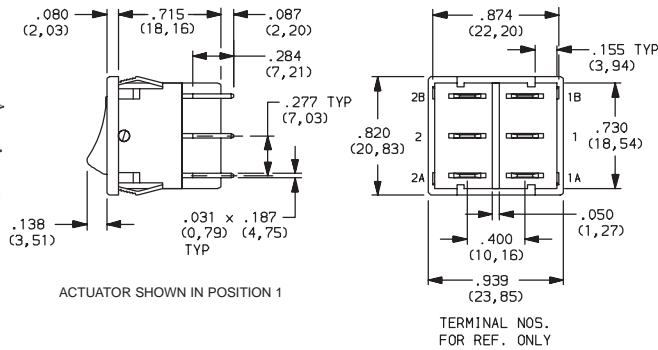

PART NUMBER	FUNCTION	POS. 1	POS. 2	POS. 3
D201J12S215QA	DPDT	ON	NONE	ON
D602J12S215QA	DPST	ON	NONE	OFF

NOTE: For panel mounting information, see page F-51.

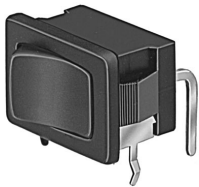

D501J12S2AQA  
Horizontal Actuation  
SPDT

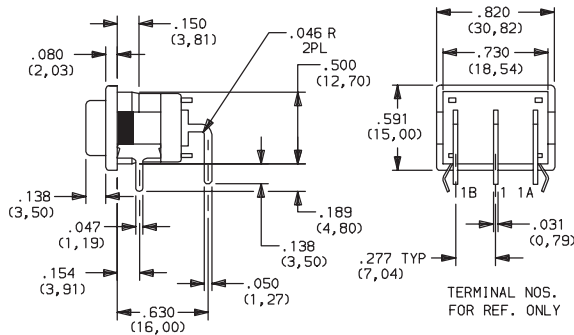

PART NUMBER	FUNCTION	POS. 1	POS. 2	POS. 3
D501J12S2AQA	SPDT	ON	NONE	ON

NOTE: For PC mounting information, see page F-52.

## SWITCH FUNCTION

NO. POLES	MODEL NO.	AMP RATING*	SWITCH FUNCTION			CONNECTED TERMINALS			SCHEMATIC
			POS. 1	POS. 2	POS. 3	POS. 1	POS. 2	POS. 3	
SP	D102	4	ON	NONE	OFF	1-1A	OPEN	OPEN	
	D502	10							
	D101 (STD.)	4	ON	NONE	ON	1-1A	OPEN	1-1B	
	D501 (STD.)	10							
	D103	4	MOM.	OFF	MOM.	1-1A	OPEN	1-1B	
	D503	10							
D105	4	MOM.	NONE	ON	1-1A	OPEN	1-1B		
D108	4								
D508	10								

MOM. = MOMENTARY

\*AMP RATING: D10X and D20X models: 4 AMPS @ 125 V AC; 2 AMPS @ 250 V AC. D50X and D60X models: 10 AMPS @ 125 V AC; 5 AMPS @ 250 V AC.

All models . DX01, DX02 models also available with . See CONTACT MATERIALS, page F-52.

# C&K D Series Miniature Snap-in Power Rocker Switches

## SWITCH FUNCTION

NO. POLES	MODEL NO.	AMP RATING*	SWITCH FUNCTION			CONNECTED TERMINALS			SCHEMATIC
			POS. 1	POS. 2	POS. 3	POS. 1	POS. 2	POS. 3	
DP	<b>D202</b> <b>D602</b>	4 10	ON	NONE	OFF	1-1A, 2-2A	OPEN	OPEN	
	<b>D201 (STD.)</b> <b>D601 (STD.)</b>	4 10	ON	NONE	ON	1-1A, 2-2A	OPEN	1-1B, 2-2B	
	<b>D203</b> <b>D603</b>	4 10		OFF					
	<b>D208</b> <b>D608</b>	4 10	MOM.	NONE					

MOM. = MOMENTARY

\*AMP RATING: D10X and D20X models: 4 AMPS @ 125 V AC; 2 AMPS @ 250 V AC. D50X and D60X models: 10 AMPS @ 125 V AC; 5 AMPS @ 250 V AC.

All models . DX01, DX02 models also available with . See CONTACT MATERIALS, page F-52.

## ACTUATOR

### J1 (STD.) ROCKER

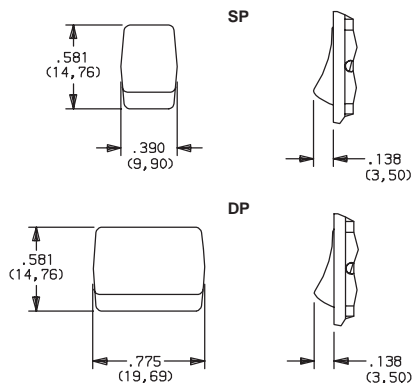

### J5 LEVER

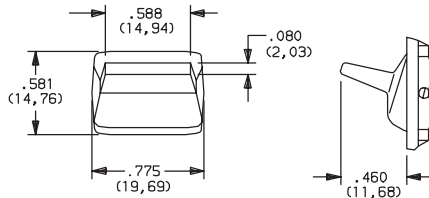

'J5' actuator available only with DP models D201, D202, D601 and D602.

OPTION CODE	ACTUATOR COLOR
<b>2</b>	(STD.) BLACK
<b>1</b>	WHITE
<b>3</b>	RED
<b>T</b>	BEIGE

NOTE: Actuator finish: matte. Other colors available, consult Customer Service Center.

## MOUNTING STYLE/COLOR

### S (STD.) SNAP-IN

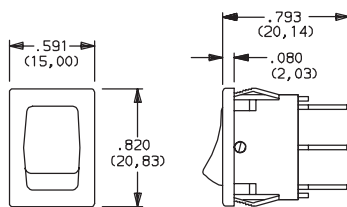

OPTION CODE	HOUSING COLOR
<b>2</b>	(STD.) BLACK
<b>1</b>	WHITE
<b>3</b>	RED
<b>T</b>	BEIGE

NOTE: Frame finish on housing: matte. Other colors available, consult Customer Service Center.

### B RECESSED SNAP-IN BRACKET

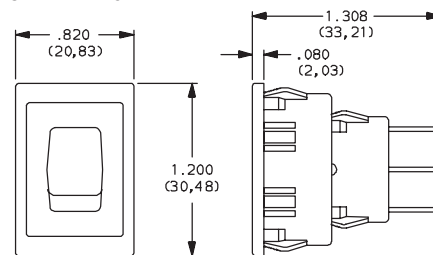

NOTE: Available in black, vertical mount, SP models only.

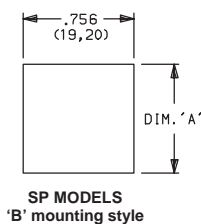
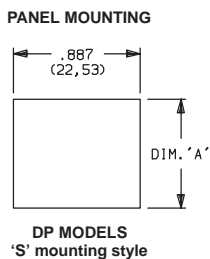
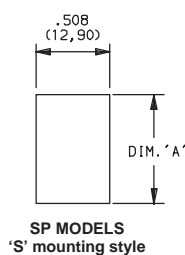

PANEL THK.	DIM. 'A' SP & DP MODELS 'S' MOUNTING STYLE	DIM. 'A' SP MODELS 'B' MOUNTING STYLE
.030-.049 (0,75) (1,25)	.756 (19,20)	1.068 (27,13)
.049-.079 (1,25) (2,00)	.764 (19,40)	1.076 (27,33)
.079-.118 (2,00) (3,00)	.780 (19,80)	1.092 (27,74)



F

Rocker

# C&K D Series Miniature Snap-in Power Rocker Switches

## TERMINATIONS

### A RIGHT ANGLE, PC THRU-HOLE

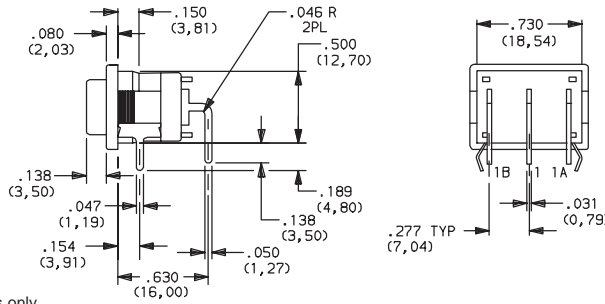
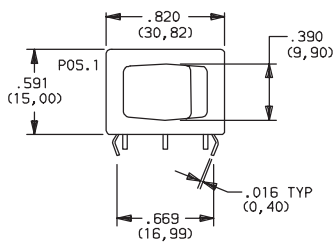

### PC MOUNTING

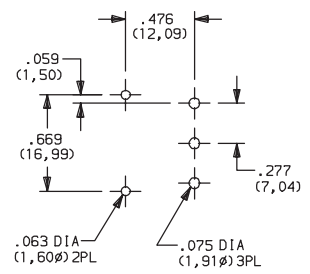

Available with D101, D102, D501, D502 SP models only.

### 02 PC THRU-HOLE

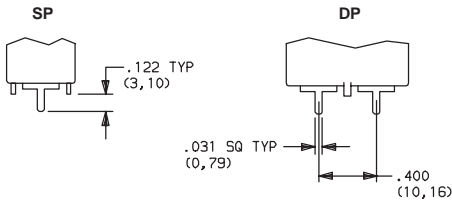

Available with DX01 and DX02 models only.

### 06 EXTENDED PC THRU-HOLE

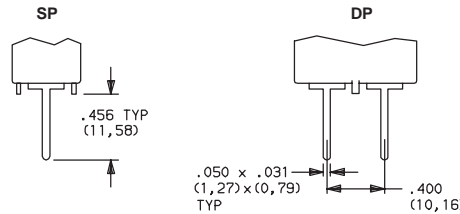

Available with DX01 and DX02 models only.

### PC MOUNTING (02 and 06)

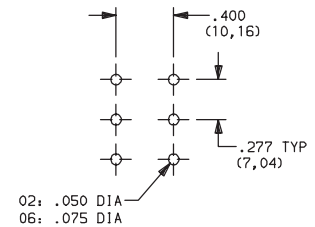

### 15 (STD.) QUICK CONNECT

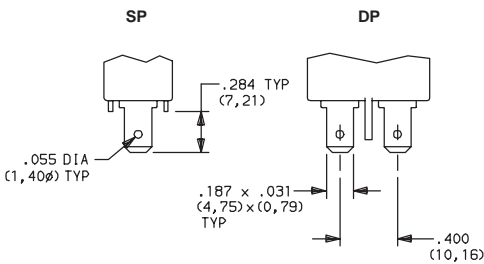

Available with DX01 and DX02 models only.

### 05 TWISTED QUICK CONNECT

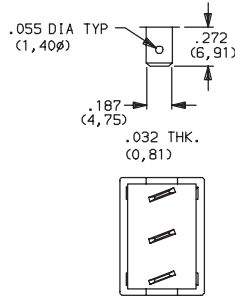

NOTE: Terminals are twisted. Available with DX03, DX05 and DX08 models only.

### 17 WIRABLE QUICK CONNECT

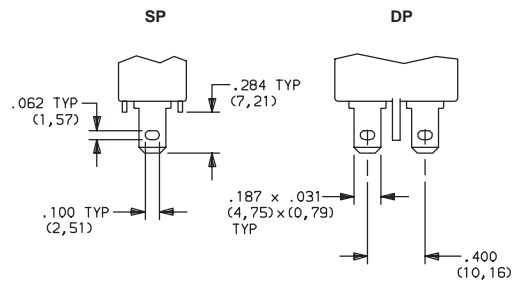

Available with DX01 and DX02 models only.

## ACTUATOR MARKINGS

**NONE** (STD.) NO MARKING    **D** ON-OFF    **H** O I    **N** LARGE DOT    **P** O-    **R** RED RECTANGLE ON END    **U** LARGE DOT ON END

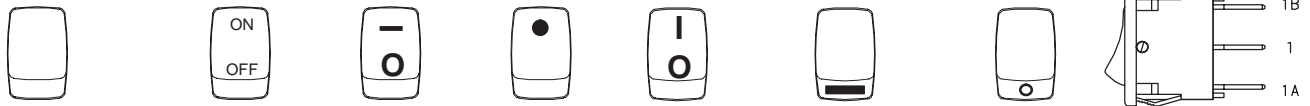

'D, H, P & U' marking options: marking color white, standard for all actuator colors except white. Black marking color, standard for white actuators. 'R' & 'N' marking option: red marking color, standard. consult Customer Service Center for other available marking colors.

NOTE: Orientation of actuator markings and terminals.

## CONTACT MATERIAL

OPTION CODE	CONTACT AND TERMINAL MATERIAL	RATINGS
<b>QA (STD.)</b>	SILVER <sup>1</sup>	D10X and D20X MODELS: 4 AMPS @ 125 V AC; 2 AMPS @ 250 V AC (UL/CSA). D50X and D60X MODELS: 10 AMPS @ 125 V AC; 5 AMPS @ 250 V AC (UL/CSA).
<b>QF (STD.)</b>		D10X and D20X MODELS: 4 AMPS @ 125 V AC; 2 AMPS @ 250 V AC (UL/CSA). 4(2) AMPS @ 125 V AC; 2(1) AMPS @ 250 V AC, T85 (VDE). 2(1) AMPS @ 250 V AC. D50X and D60X MODELS: 10 AMPS @ 125 V AC; 5 AMPS @ 250 V AC (UL/CSA). 10(6) AMPS @ 125 V AC; 5(3) AMPS @ 250 V AC, T85 (VDE). 5(3) AMPS @ 250 V AC.

<sup>1</sup>MOVABLE CONTACT: D10X and D20X MODELS: Copper, silver plated.  
D50X and D60X MODELS: Coin silver, silver plated.  
STATIONARY CONTACTS & TERMINALS: Copper or brass, silver plated.

All models with all options. DX01, DX02 models when ordered with 'QF' contact material.