

SHEET OF

PANEL THICKNESS	X dimension
0.75-1.25 [.030-.049]	19.2- <i>a1</i> [.756]
1.25-2.0 [.049-.079]	19.4- <i>a1</i> [.764]
2.0-3.0 [.079-.118]	19.8- <i>a1</i> [.780]

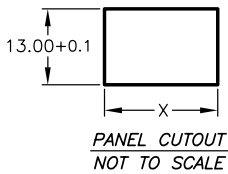

SWITCH FUNCTION	
POS. 1	POS. 2
ON	OFF
1-1a	OPEN

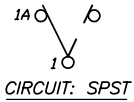

- NOTES:
1. ALL DIMENSIONS IN MM [INCH]
  2. GENERAL TOLERANCE: X.X=±0.4  
X.XX=±0.25
  3. TERMINAL NUMBERS FOR REF ONLY
  4. RATING: 15A @ 125VAC OR 6A @ 250VAC
  5. MATERIALS: (TERMINALS) SILVER PLATED COPPER  
(CONTACTS) COIN SILVER, SILVER PLATED.
  6. CONTACT RESISTANCE: <20 Mega
  7. ELECTRICAL LIFE: 10,000 cycles
  8. INSULATION RESISTANCE: >1000 Mega
  9. DIELECTRIC STRENGTH: >1500V 1 minute  
>3000V between Poles
  10. OPERATING TEMP. RANGE: -25°C to +85°C

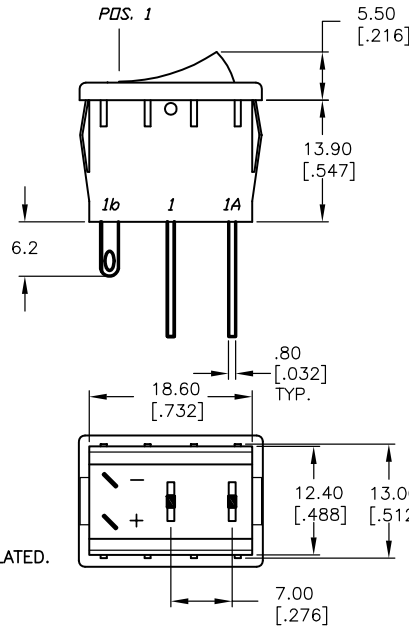
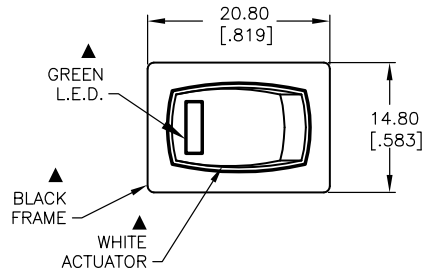

GREEN L.E.D

PARAMETERS	SYMBOL	MAX.	TYP.	UNITS
POWER DISSIPATION	P <sub>D</sub>	80		mW
AVERAGE FORWARD CURRENT	I <sub>AF</sub>	--		mA
PEAK FORWARD CURRENT	I <sub>PF</sub>	100		mA
REVERSE VOLTAGE	V <sub>R</sub>	5		V
FORWARD VOLTAGE	V <sub>F</sub>	2.6	2	V
REVERSE CURRENT	I <sub>R</sub>		100	μA
EMISSION WAVELENGTH	λ <sub>P</sub>		570	nm
LUMINOUS INTENSITY	I <sub>v</sub>		30	mcd

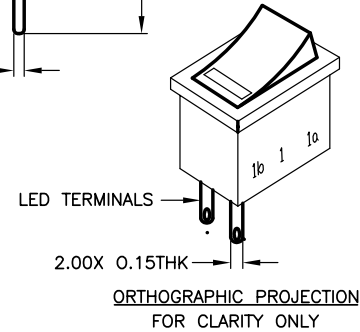
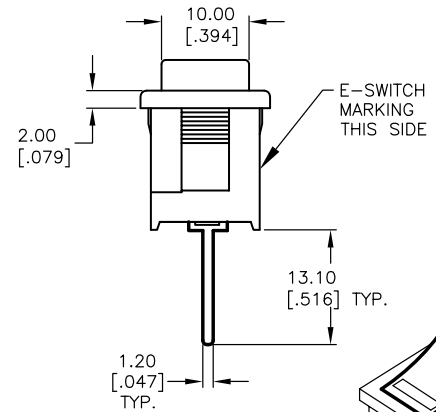

**E-SWITCH®**

TITLE	R1966ABLKWHTPEGRN				
SCALE	1.5:1	DATE	12/16/04	DR	AR
DWG	M301153	REV	A		

THE INFORMATION CONTAINED IN THIS DOCUMENT IS PROPRIETARY TO E-SWITCH AND IS NOT TO BE COPIED OR TRANSFERRED