

LTR	EN	DESCRIPTION	APPR	BY	DATE
A	-	INITIAL RELEASE	RB	EM	9-20-06

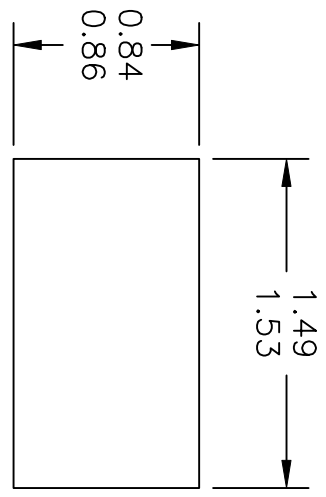

SUGGESTED MOUNTING HOLE

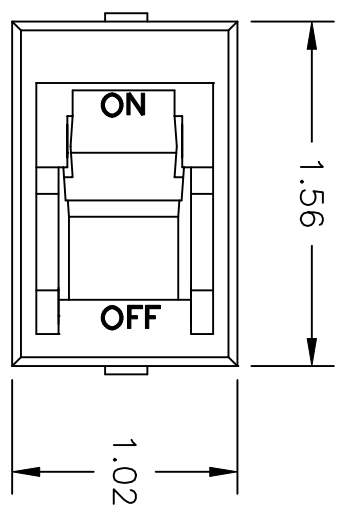
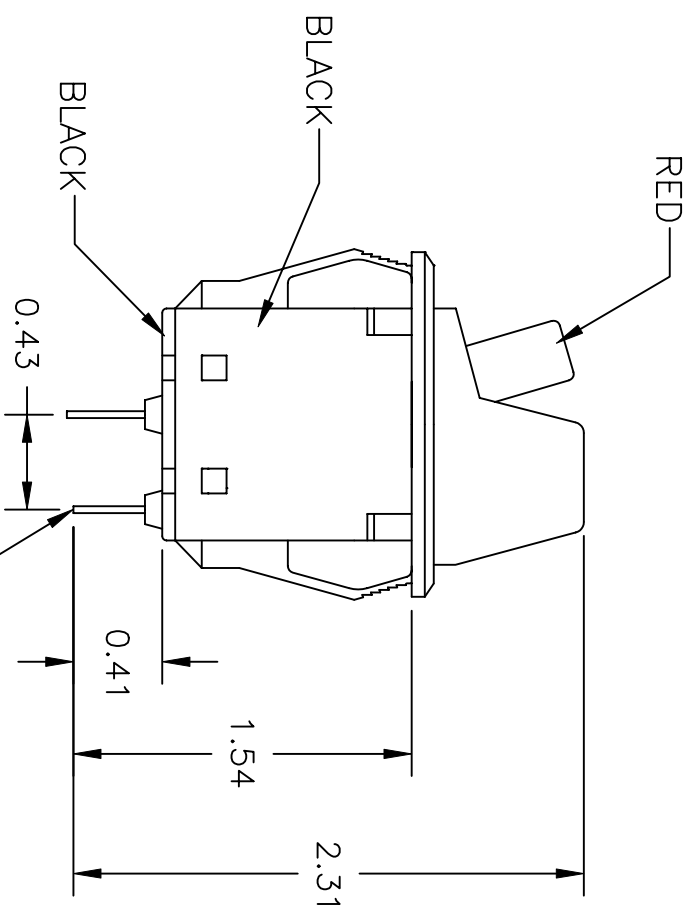

JUDCO INVENTORY NO. 44-0123-00
 SWITCH TYPE: SPST, JR-968, LOCKING ROCKER
 SWITCH W/KEY, W/PALM GUARD
 (LOCKS IN/OFF POSITION)

CUSTOMER: DIGI KEY
 APPROVED BY: _____
 DATE: _____

DIMENSIONS IN INCHES DIMENSIONS ARE REFERENCE		
DRAWN: EM	09-20-06	
APPR: KJ	09-20-06	
TITLE		
SPST JR-968 LKG RKR SW W/KEY, W/PALM GUARD (LOCK IN/OFF POSITION)		
DWG. NO.	1415-1034	
SHEET	1 OF 1	

This document embodies a product, component, and/or design proprietary to JUDCO MANUFACTURING INC., and which is protected either as a trade secret, by U.S. Patent, or by copyright. It may not be used in any way without written express consent of JUDCO MANUFACTURING INC.