

# RB1 Series

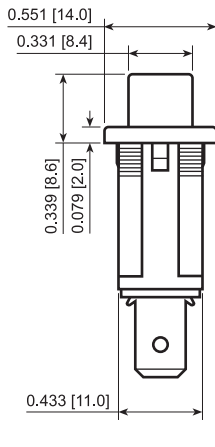

ROCKER

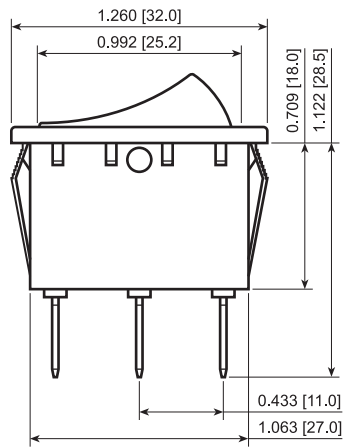

Dimensions of Some Versions May Vary From Above

### Illumination Options

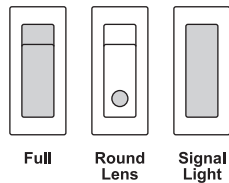

### Actuator Options



### Terminal Options

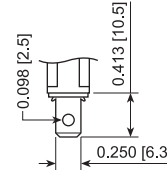
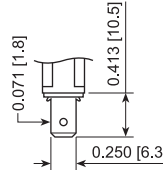

6.3mm Tab (Small Hole)

6.3mm Tab (Large Hole)

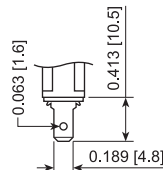

4.8mm Tab

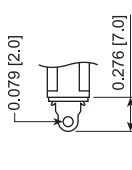

Solder

Low Clearance Solder

Wire Leads (xx in Inches)

### Panel Cutout

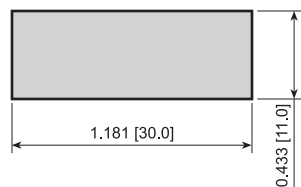

### Water Protection Option

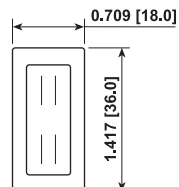

PVC Cap

### FEATURES:

- High Quality and Reliable Switch
- Industry Standard 11mm x 30mm Cutout
- Illuminated and Signal Light Versions
- Multiple Terminal and Actuator Options
- PVC Cap for Dust and Water Protection

### SPECIFICATIONS:

#### RATING: RATING OPTION C:

- 15A 125VAC T55 [cULus]
- 7.5A 250VAC T55 [cULus]
- 16(4)A 250V~ 1E4 T125/55 [ENEC]

#### RATING OPTION D (2 Pos. FUNCTIONS):

- 20A 125VAC T65 [cULus]
- 1/4HP 125VAC T65 [cULus]
- 3/4HP 250VAC T65 [cULus]
- 20(8)A 250V~ 1E4 T125 [ENEC]
- 10(2)A 250V~ 5E4 T85/55 [ENEC]
- 16(4)A 250V~ 1E4 T85/55 [ENEC]

#### RATING OPTION E (3 Pos. FUNCTIONS):

- 16A 125VAC T65 [cULus]
- 16A 250VAC T65 [cULus]
- European Rating Pending

#### TEMPERATURE: -20°C to 65°C Min.

#### ELECTRICAL LIFE: 10,000 Cycles

#### CONTACT RESISTANCE: 35mΩ Max. at 50VAC

#### INSULATION RESISTANCE: 100MΩ Min. at 500VAC

#### DIELECTRIC STRENGTH: 1,500VAC for 1 Minute

#### INGRESS PROTECTION: IP54 with PVC Cap

### MATERIALS:

Body: Polyamide 6/6, UL94 V-2

ACTUATOR: Polyamide 6/6, UL94 V-2

Polycarbonate, UL94 V-2

CONTACTS: Silver Plated Copper



RB141D1000-136 / ACC-F01-1



RB141D1100-216



RB1C5E1100

Series	Terminal	Function	Rating	Body Color	Actuator Color	Marking Color	Marking Type	Lens Style	Lens Color	Lamp Voltage
RB1 - Curved or Signal Light	1 - 4.8mm Tab	0 - Signal	0 - Signal	1 - Black	0 - Full / Signal	0 - None	0 - None	1 - Full	0 - Clear	3 - 6V
RB1F - Flat	4 - 6.3mm Tab (Small Hole)	1 - Off-On	C - 15A 125V	2 - White	1 - Black	1 - Black	1 - I/O Vert.	2 - Round	1 - Red	4 - 12V
	5 - Solder	3 - On-On	D - 20A 125V	3 - Almond	2 - White	2 - White	2 - ON/OFF/ON Vert.		2 - Amber	5 - 24V
	9 - 6.3mm Tab (Large Hole)	4 - Off-(On)	E - 16A 125V	4 - Grey	3 - Almond	3 - Almond	3 - ON/OFF Vert.		3 - Green	6 - 125V
	A - On-(Off)	5 - On-Off-On		9 - Red	4 - Grey	4 - Grey	4 - ON/OFF Horiz.		4 - Blue	7 - 250V
	C - Low Clear. Solder	B - On-(On)			5 - Orange	5 - Orange	5 - I/O/II Horiz.		5 - Yellow	
	Wxx - Wire Leads	D - (On)-Off-(On)			7 - Blue	7 - Blue	S - I/O/II Vert.			
					8 - Green	8 - Green	R - I/O Horiz.			
					9 - Red	9 - Red				

Notes:  
\* = LED Illumination Available with Round Lens Only

Custom Colors and Markings Available Upon Request For Illuminated Switches Only

### EXAMPLE PART NUMBERS:

RB141D1100 1P Off-On  
Black Body, Red Illum. Actuator, I/O Vert.

RB141D1000-116 1P Off-On  
Black Body/Actuator, No Marking



Ph: 503-297-8878 • Fax: 503-297-8879

10

P.O. Box 25110 • Portland, OR 97298 USA • www.lambind.com

SPECIFICATIONS SUBJECT TO CHANGE WITHOUT NOTICE