



## 1M1-Series Ordering Scheme



**1 SERIES**  
**1M1** Miniature Rocker Switch

**2 POLES**  
**SP** single pole - uses terminals 1, 2 & 3.  
**DP** double pole uses terminals 1,2, 3, 4, 5 & 6.  
**3P** double pole uses terminals 1,2, 3, 4, 5, 6, 7, 8 & 9.  
**4P** double pole uses terminals 1,2, 3, 4, 5, 6, 7, 8, 9, 10, 11, 12.

**3 CIRCUIT**  
 ( ) - momentary

**Switching Position:**  
 2-3, 5-6, 8-9, 11-12      OPEN      2-1, 5-4, 8-7, 11-10

1	ON	NONE	ON
2	ON	NONE	(ON)
3	ON	OFF	ON
4	(ON)	OFF	(ON)
5	ON	OFF	(ON)

**4 ACTUATOR STYLE**

<b>R1</b>	Small rocker	<b>R5</b>	Large rocker
<b>R2</b>	Small paddle	<b>R6</b>	Rocker & frame
<b>R3</b>	Medium rocker	<b>R7</b>	Paddle & frame
<b>R4</b>	Large paddle	<b>R8</b>	Rocker w/out frame
		<b>R9</b>	Paddle w/out frame

**5 ACTUATOR COLOR & 6 FRAME COLOR<sup>1,2</sup>**

1 white	4 orange	7 blue
2 black	5 yellow	8 brown
3 red	6 green	9 gray

1 Black is standard. Other colors available, consult factory for details.  
 2 Selection 6 is blank if actuator style R8 or R9 (no frame)

**7 TERMINATION**

<b>M1</b>	Solder Lug	<b>VS4</b>	PC Mount, U bracket, .460 high
<b>M2</b>	PCB	<b>VS5</b>	PC Mount, U bracket, .630 high
<b>M3</b>	Quick Connect	<b>M61</b>	Snap-In, U bracket, 90° horizontal
<b>M5-1</b>	Wire Wrap .750 [19.05]	<b>M71</b>	Snap-In, U bracket, 90° vertical
<b>M5-2</b>	Wire Wrap .964 [24.48]	<b>VS21</b>	Snap-In, U bracket, .620 mounting x .460 high
<b>M5-3</b>	Wire Wrap .425 [10.80]	<b>VS31</b>	Snap-In, U bracket, .620 mounting x .630 high
<b>M5-4</b>	Wire Wrap 1.062 [26.97]	<b>VS41</b>	Snap-In, U bracket .620 mounting x .630 high
<b>M6</b>	PC Mount, 90° horizontal	<b>VS51</b>	Snap-In, U bracket
<b>M7</b>	PC Mount, 90° vertical		
<b>VS2</b>	PC Mount, U bracket, .620 mounting x .460 high		
<b>VS3</b>	PC Mount, U bracket, .620 mounting x .630 high		

**8 CONTACT**

G	Material	Terminal Plating	Rating	Approvals
G	silver <sup>1</sup>	gold over silver <sup>2</sup>	5A@125VAC or 28VDC, 2A @ 250VAC	UL CSA
K	gold <sup>2</sup>	tin-lead <sup>4</sup>	0.4VA max. @20V max (AC/DC)	-
P	silver <sup>1</sup>	tin-lead <sup>4</sup>	5A@125VAC or 28VDC, 2A @ 250VAC	UL CSA
Q	silver <sup>1</sup>	silver <sup>1</sup>	5A@125VAC or 28VDC, 2A @ 250VAC	UL CSA
R	gold <sup>2</sup>	gold <sup>2</sup>	0.4VA max. @20V max (AC/DC)	-

NOTE:  
 Tin-lead option available with PC type terminations only.  
 1 Moveable contact & terminals: copper alloy, silver plate  
 2 Moveable contact & terminals: copper alloy with gold plate over nickel plate  
 3 Terminals: silver plate with outer layer in gold plating  
 4 Outer terminals: copper alloy with tin-lead over nickel plate

**9 EPOXY SEAL**  
**E** epoxy seal

## 1MS-Series Ordering Scheme



**1 SERIES**  
**1MS** Sealed Miniature Rocker Switch

**2 POLES**  
**SP** single pole - uses terminals 1, 2 & 3.  
**DP** double pole uses terminals 1,2, 3, 4, 5 & 6.  
**3P** double pole uses terminals 1,2, 3, 4, 5, 6, 7, 8 & 9.

**3 CIRCUIT**  
 ( ) - momentary

**Switching Position:**  
 2-3, 5-6, 8-9      OPEN      2-1, 5-4, 8-7

1	ON	NONE	ON
2	ON	NONE	(ON)
3	ON	OFF	ON
4	(ON)	OFF	(ON)
5	ON	OFF	(ON)

**4 ACTUATOR STYLE**

<b>R1</b>	Small rocker	<b>R5</b>	Large rocker
<b>R2</b>	Small paddle	<b>R6</b>	Rocker & frame
<b>R3</b>	Medium rocker	<b>R7</b>	Paddle & frame
<b>R4</b>	Large paddle	<b>R8</b>	Rocker w/out frame
		<b>R9</b>	Paddle w/out frame

**5 TERMINATION**

<b>M1</b>	Solder Lug	<b>VS3</b>	PC Mount, U bracket, .620 mounting x .630 high
<b>M2</b>	PCB	<b>VS4</b>	PC Mount, U bracket, .460 high
<b>M3</b>	Quick Connect	<b>VS5</b>	PC Mount, U bracket, .630 high
<b>M5-1</b>	Wire Wrap .750 [19.05]	<b>VS21</b>	Snap-In, U bracket, .620 mounting x .460 high
<b>M5-2</b>	Wire Wrap .964 [24.48]	<b>VS31</b>	Snap-In, U bracket, .620 mounting x .630 high
<b>M5-3</b>	Wire Wrap .425 [10.80]	<b>VS41</b>	Snap-In, U bracket .620 mounting x .630 high
<b>M5-4</b>	Wire Wrap 1.062 [26.97]	<b>VS51</b>	Snap-In, U bracket
<b>M6</b>	PC Mount, 90° horizontal		
<b>M7</b>	PC Mount, 90° vertical		
<b>VS2</b>	PC Mount, U bracket, .620 mounting x .460 high		

**6 CONTACT**

G	Material	Terminal Plating	Rating	Approvals
G	silver <sup>1</sup>	gold over silver <sup>2</sup>	5A@125VAC or 28VDC, 2A @ 250VAC	UL CUL
K	gold <sup>2</sup>	tin-lead <sup>4</sup>	0.4VA max. @20V max (AC/DC)	-
P	silver <sup>1</sup>	tin-lead <sup>4</sup>	5A@125VAC or 28VDC, 2A @ 250VAC	UL CUL
R	gold <sup>2</sup>	gold <sup>2</sup>	0.4VA max. @20V max (AC/DC)	-

NOTE:  
 Tin-lead option available with PC type terminations only.  
 1 Moveable contact & terminals: copper alloy, silver plate  
 2 Moveable contact & terminals: copper alloy with gold plate over nickel plate  
 3 Terminals: silver plate with outer layer in gold plating  
 4 Outer terminals: copper alloy with tin-lead over nickel plate

**7 EPOXY SEAL**  
**E** epoxy seal

## 1M1-Series Dimensional Specifications: in.[mm]

### ACTUATOR

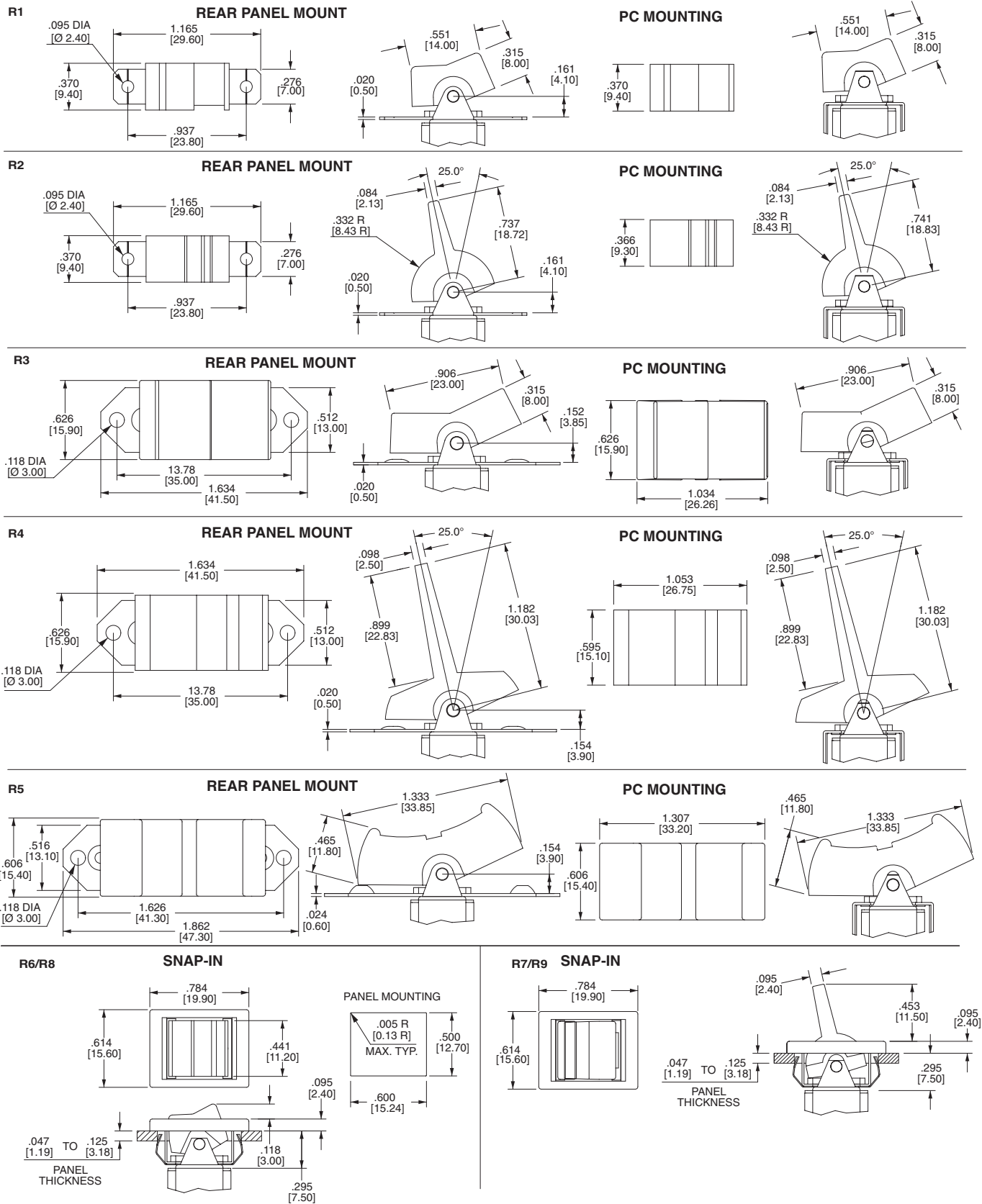

R8 and R9 are without frame. Actuators are as shown.

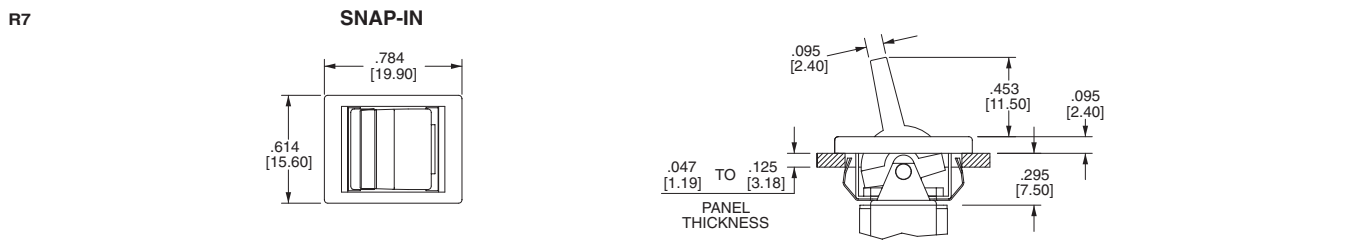
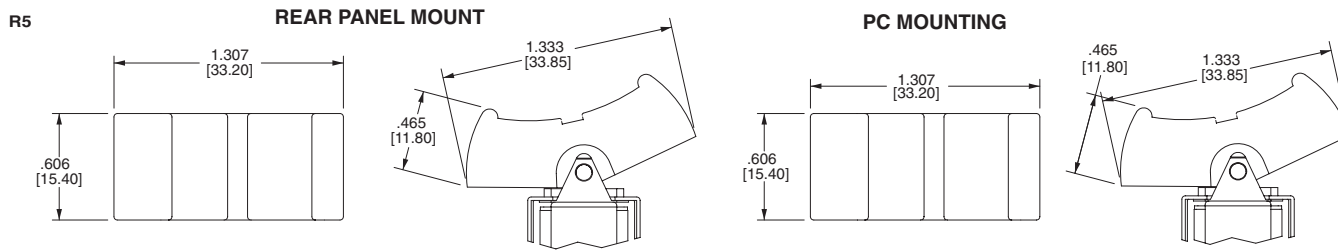
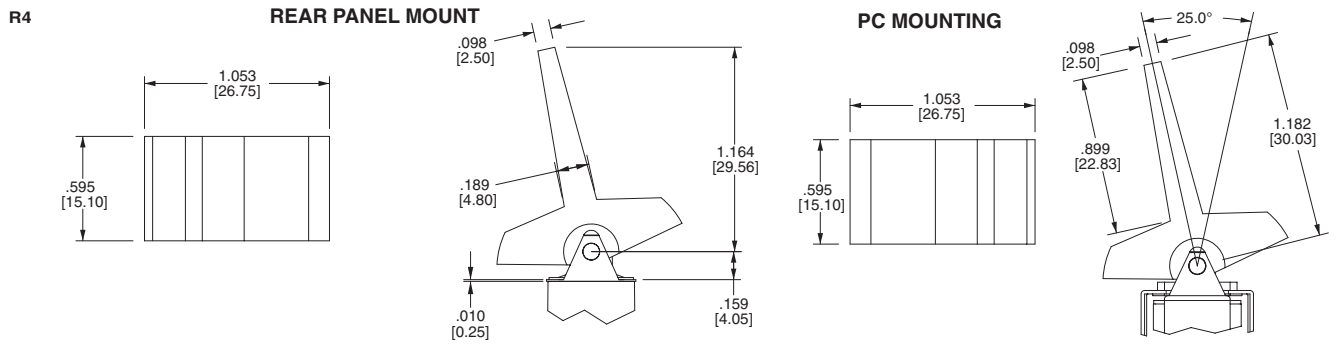
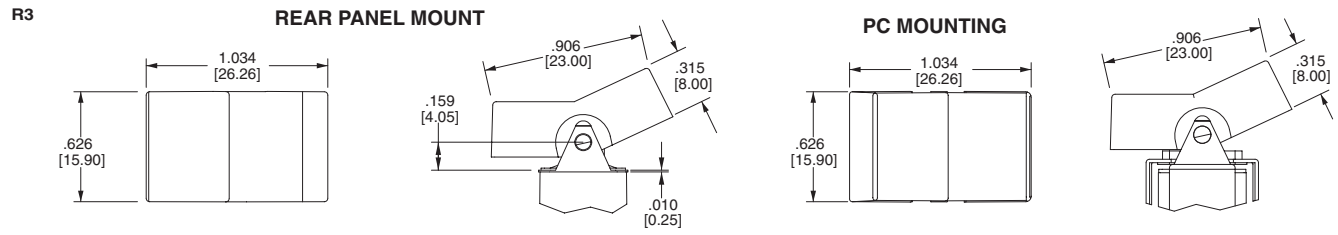
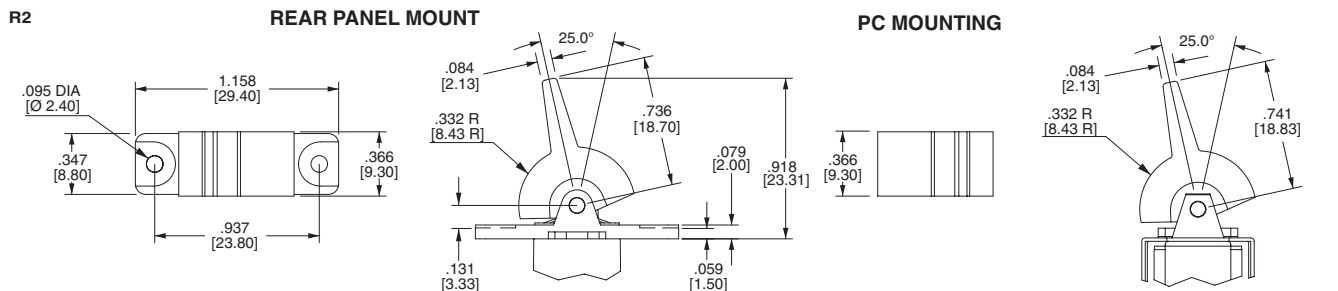
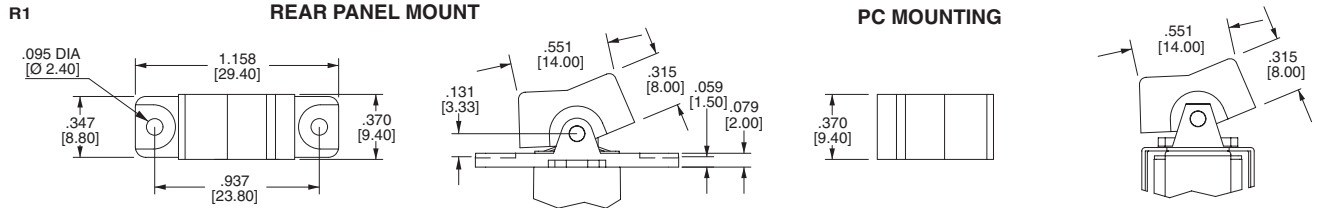
**1MS-Series Dimensional Specifications: in.[mm]**
**ACTUATOR**

**1M-Series Dimensional Specifications: in.[mm]**

**TERMINATION**

**1M1-Series**

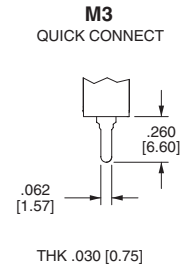
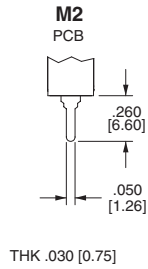
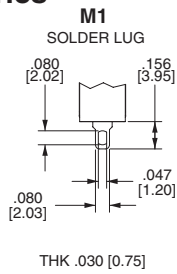

**1MS-Series**

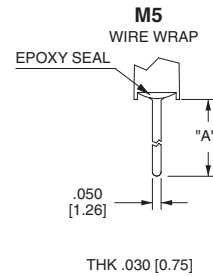
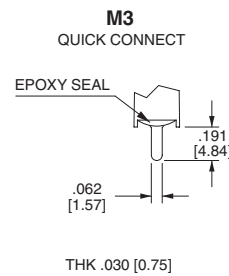
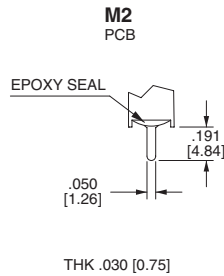
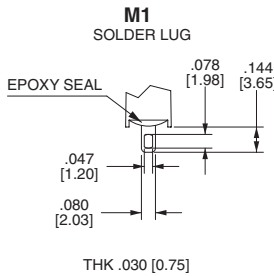

OPTION CODE	DIM. "A"
M5-1	.750 [19.05]
M5-2	.964 [24.48]
M5-3	.425 [10.80]
M5-4	1.062 [26.97]

**1M-Series**

M6

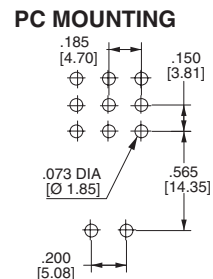
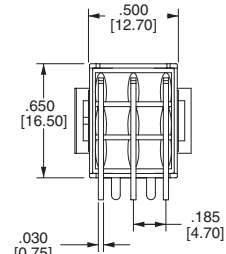
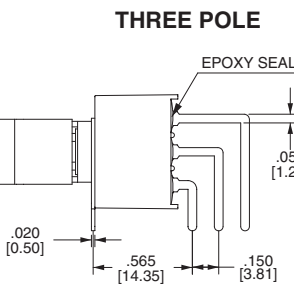
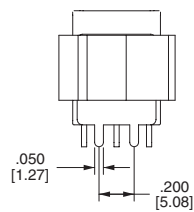
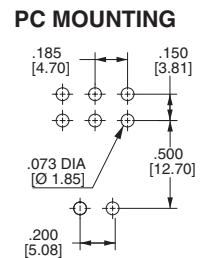
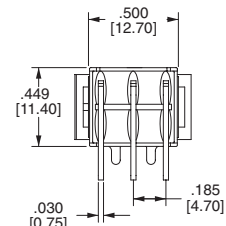
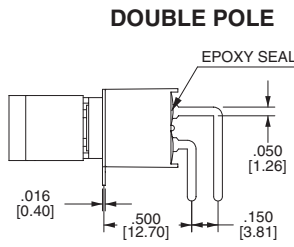
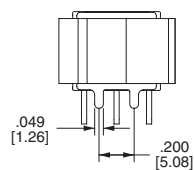
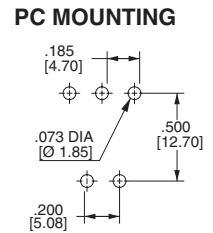
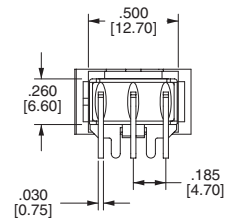
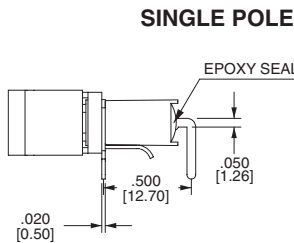
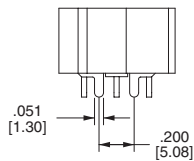

## 1M-Series Dimensional Specifications: in.[mm]

### TERMINATION

M7

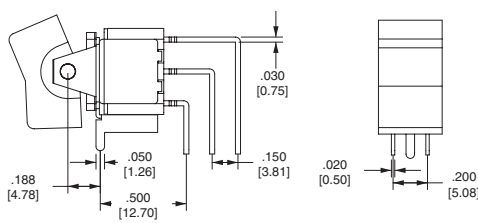

SINGLE POLE

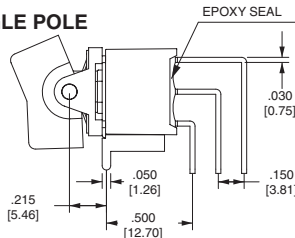

PC MOUNTING

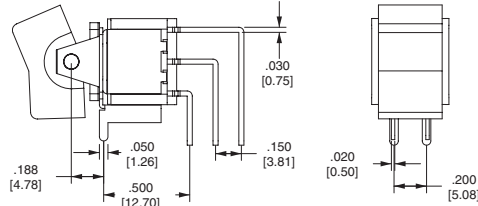
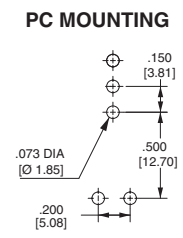

DOUBLE POLE

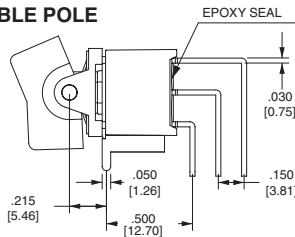

PC MOUNTING

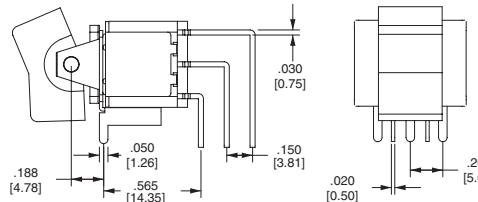
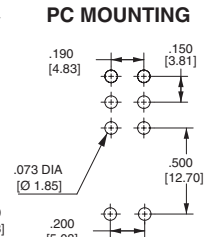

THREE POLE

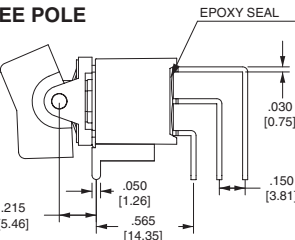

PC MOUNTING

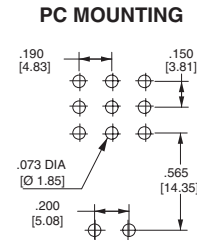

VS2 & VS3

OPTION CODE	DIM. "A"
VS2	.460 [11.68]
VS3	.630 [16.00]

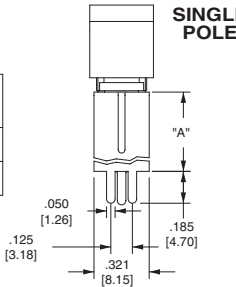

SINGLE POLE

PC MOUNTING

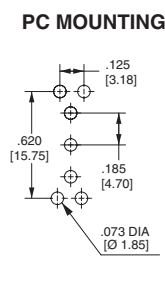

DOUBLE POLE

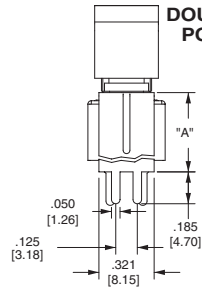

PC MOUNTING

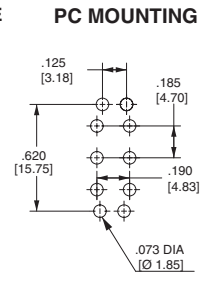

VS4 & VS5

OPTION CODE	DIM. "A"
VS4	.460 [11.68]
VS5	.630 [16.00]

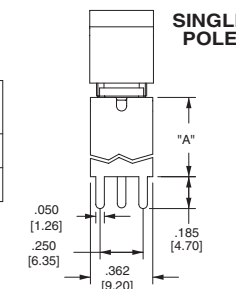

SINGLE POLE

PC MOUNTING

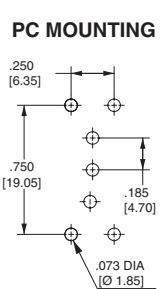

DOUBLE POLE

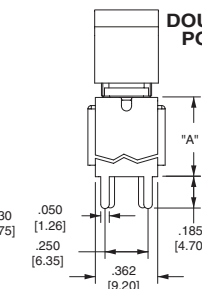

PC MOUNTING

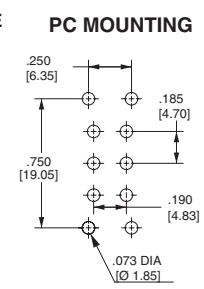

U4 & VS5

OPTION CODE	DIM. "A"
U4	.551 [14.00]
VS5	.630 [16.00]

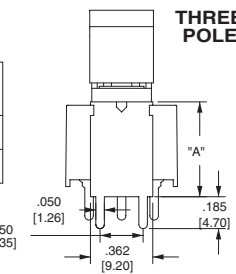

THREE POLE

EPOXY SEAL

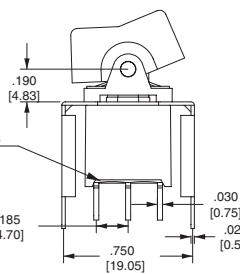

PC MOUNTING

