

AS series

Snap-in rocker switches

Distinctive features and specifications

- Double insulation
- Epoxy sealed terminals
- UL and CSA approved

ELECTRICAL AND GENERAL SPECIFICATIONS

- Max. current/voltage rating with resistive load :
 - silver contacts (code 1) and gold plated silver contacts (code 2) : 2A 250VAC - 4A 125VAC
 - gold plated brass contacts (code 0) : 0,4VA 20V AC or DC
- Initial contact resistance : 10 mΩ max.
- Insulation resistance : 10.000 MΩ min.
- Dielectric strength :
 - 1.000 Vrms 50 Hz min. between terminals
 - 4.000 Vrms 50 Hz min. between terminals and metal panel
- Electrical life : 50.000 cycles
- Operating temperature : -40°C to +85°C

MATERIALS

- Case : PES
- Actuator : polyamide
- Contacts
 - 0 : brass, gold plated
 - 1 : silver
 - 2 : silver, gold plated
 - 5 : special contact, lower rating
- Minimum quantity : consult factory.
- Terminal seal : epoxy

APPROVALS



Availability : consult factory for details or approved models.

Marking : to order switches marked with above approvals, complete last box of ordering format.

ABOUT THIS SERIES

Dimensions : first dimensions are in mm while inches are shown as bracketted numbers.



Packaging unit : 50 pieces.



AS series

Snap-in rocker switches

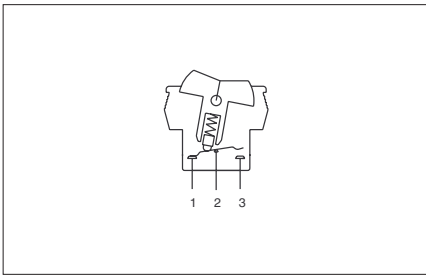

- Black body
- Single pole configuration

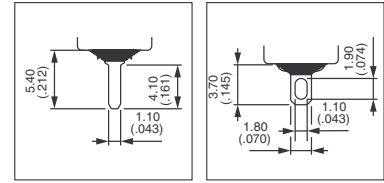

MODEL STRUCTURE

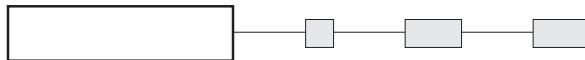

Solder lug terminals



AS36SO
AS39SO
AS37SO
AS38SO
AS32SO

III	II	I
ON	-	ON
ON	OFF	ON
MOM	OFF	MOM
ON	OFF	MOM
ON	-	MOM

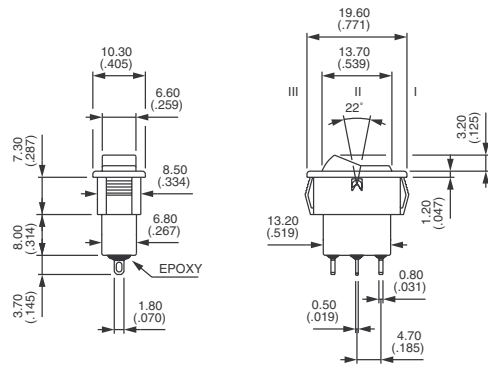

Straight PC terminals



AS36PO
AS39PO
AS37PO
AS38PO
AS32PO

III	II	I
ON	-	ON
ON	OFF	ON
MOM	OFF	MOM
ON	OFF	MOM
ON	-	MOM

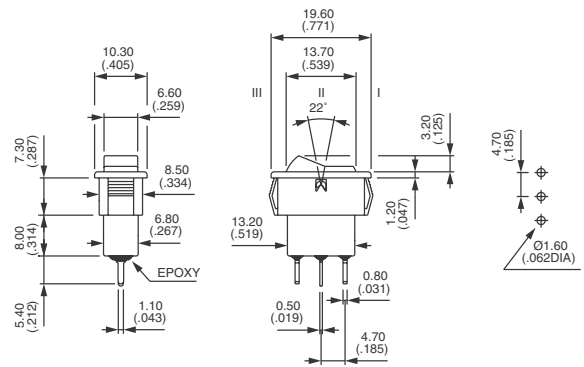

PANEL CUT-OUT

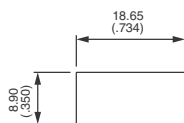

AS series

Snap-in rocker switches



CONTACT MATERIALS

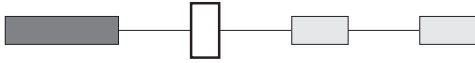

- 0 Brass, gold plated
- 1 Silver
- 2 Silver, gold plated
- 5 Special contact, lower rating
Minimum quantity. Consult factory

ACTUATORS

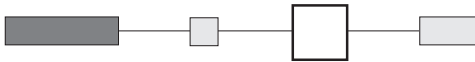

- 00 Black
- 01 Red
- 02 Grey
- 03 Blue
- 04 Ivory
- 07 White
- 09 Dark blue

For marking on actuator, consult factory.

OTHER OPTIONS



- 10 With **UL-CSA** marking
- 20 10 mm (.393) long straight PC terminals

