

PARTS LIST

ITEM	QTY.	PART NO.	PART DESCRIPTION
1	1	F040043	D16 0A S1 4
2	1	F050424	50-004-24 (YEL L.E.D.)
3	1	F050306	50-003-06 (Transparent YEL lens)

NOTES:

1. ALL DIMENSIONS IN MM
2. GENERAL TOLERANCE: X.X=±0.4
X.XX=±0.25
3. RATINGS: 5A @250V AC
8A @125V AC
4. TRAVEL: 3.0mm
5. CONTACT MATERIAL:
COPPER ALLOY W/Silver Plating
6. LAMP VOLTAGE: 24V DC L.E.D.

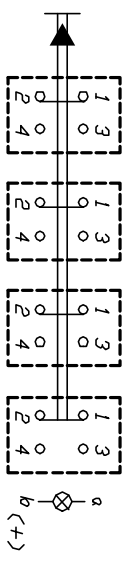

CIRCUIT: 4PST
CONTACT CONFIGURATION

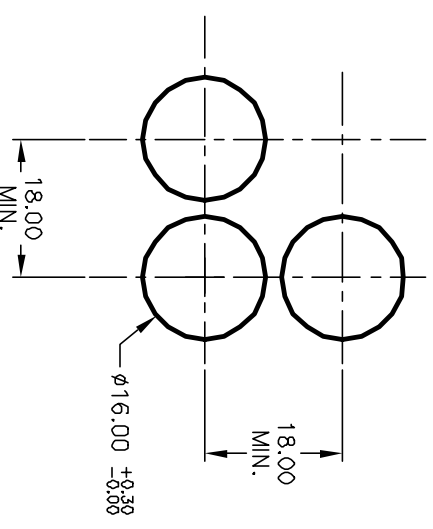

RECOMMENDED PANEL MOUNTING
SCALE 1:1

REV.	ECN No.	DESCRIPTION	DATE	CHKD
A	12449	RELEASE FOR PRODUCTION	9/25/02	CJB

TITLE	SCALE	DATE	DR	DWG	REV
D16 0A S14 K YEL YEL TRANSPARENT/CONCAVE LENS	1.5:1	5/30/02	CB	XF0512P	A

E-SWITCH®

THE INFORMATION CONTAINED IN THIS DOCUMENT IS PROPRIETARY TO E-SWITCH AND IS NOT TO BE COPIED OR TRANSFERRED