

SHEET 1 OF 1

PARTS LIST

ITEM	QTY	PART NUMBER	DESCRIPTION
1	1	F040024	D16EET13
2	1	F050202	GREEN TRANSPARENT RECTANGULAR CONCAVE
3	1	F050413	50-004-13 220VAC GREEN NEON

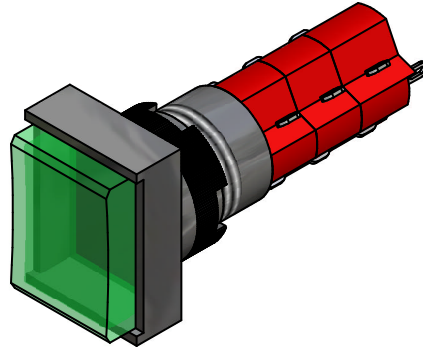
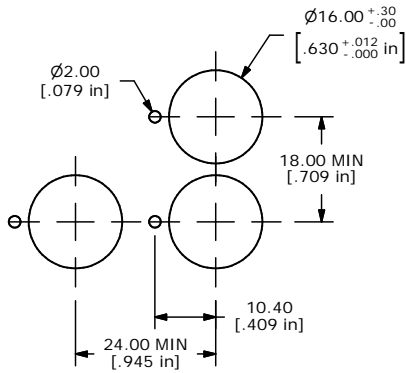

PANEL MOUNTING

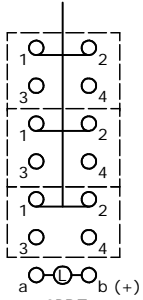

CONTACT CONFIGURATION

- NOTE:
1. ALL DIMENSIONS IN MM [INCH]
 2. GENERAL TOLERANCE: X.X=±0.4
X.XX=±0.25
 3. TERMINAL NUMBERS FOR REF ONLY
 4. MECHANICAL LIFE: 2,000,000 OPERATIONS
 5. INSULATION RESISTANCE: 1,000 MILLI-OHM MIN.
 6. OPERATING TEMP.: -25°C to 55°C
 - ▲ 7. LAMP VOLTAGE: 220VAC GREEN NEON
 8. ▲ DENOTES CRITICAL PARAMETER.

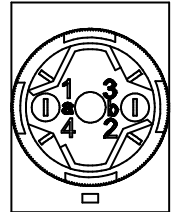
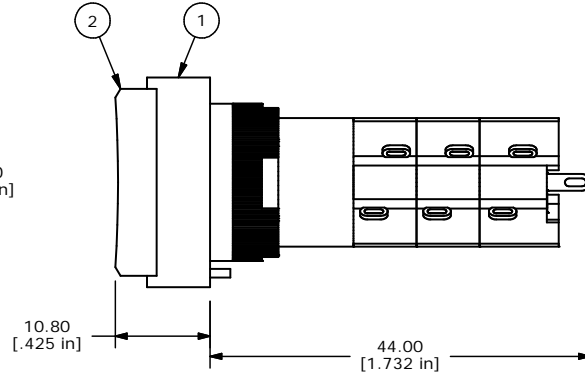
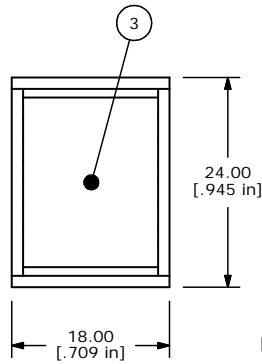

TITLE D16EET13GGRNGRN

A	14605	RELEASED FOR PRODUCTION	1/6/05	AR
REV	PCR NO	DESCRIPTION	DATE	BY

THE INFORMATION CONTAINED IN THIS DOCUMENT IS PROPRIETARY TO E-SWITCH AND IS NOT TO BE COPIED OR TRANSFERRED

SCALE 2:1	DATE 1/6/05	DR AR	DWG XF0621P	REV A
-----------	-------------	-------	-------------	-------